

STATE OF WISCONSIN  
DEPARTMENT OF NATURAL RESOURCES

LAKE SURVEY MAP

CHIPPEWA FALLS FLOWAGE LAKE CHIPPEWA COUNTY  
SEC. 3, 4, 5, 33 T. 28, 29 N. R. 8 W.

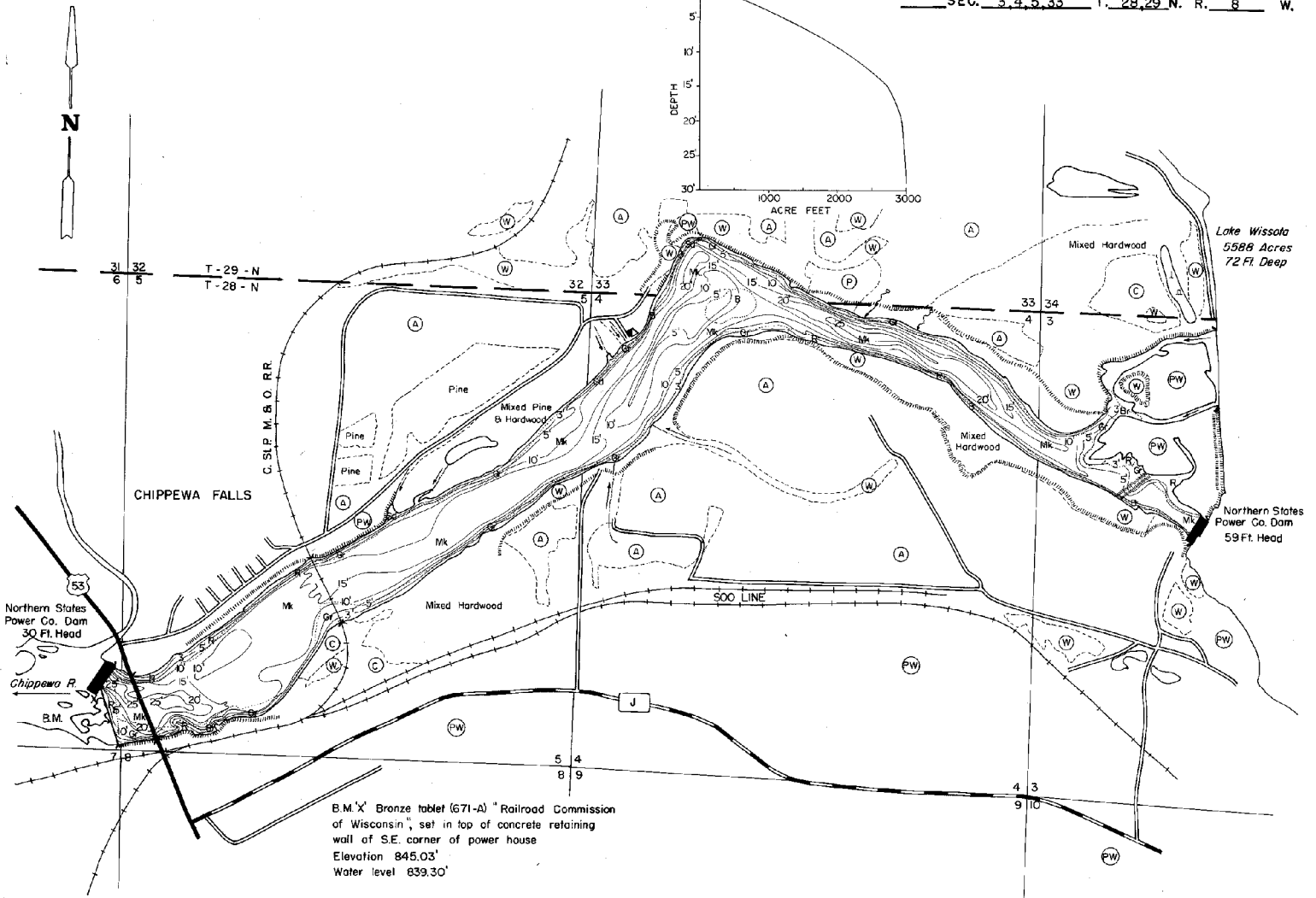

B.M. X Bronze tablet (671-A) Railroad Commission of Wisconsin, set in top of concrete retaining wall of S.E. corner of power house  
Elevation 845.03'  
Water level 839.30'

- EQUIPMENT RECORDING SONAR MAPPED AUG 1969
- | TOPOGRAPHIC SYMBOLS   |                            | LAKE BOTTOM SYMBOLS |                             |
|-----------------------|----------------------------|---------------------|-----------------------------|
| (B) Brush             | Steep slope                | P. Peat             | B Boulders                  |
| (PW) Partially wooded | ----- Indefinite shoreline | Mk. Muck            | ☼ Stumps & Snags            |
| (W) Wooded            | ~ Marsh                    | C. Clay             | ⚠ Rock danger to navigation |
| (C) Cleared           | ~ Spring                   | M. Marl             | T Submergent vegetation     |
| (P) Pastured          | ~ Intermittent stream      | Sd. Sand            | J Emergent vegetation       |
| (A) Agricultural      | ~ Permanent inlet          | Sl. Silt            | ~ Floating vegetation       |
| B.M. Bench Mark       | ~ Permanent outlet         | Gr. Gravel          | ~ Brush shelters            |
| ■ Dwelling            | ~ Dam                      | R. Rubble           |                             |
| □ Resort              | ~ D.N.R. State owned land  | Br. Bedrock         |                             |
| ⊠ Camp                |                            |                     |                             |

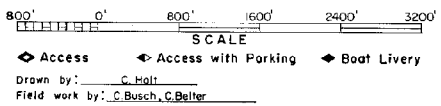

SPECIES OF FISH	1969	
	Abundant	Present
Muskie	X	X
N. Pike	X	X
Walleye	X	X
L. M. Bass	X	X
S. M. Bass	X	X
Panfish	X	X
Shurgeon	X	X
Channel Cat.	X	X

WATER AREA 282.0 ACRES  
UNDER 3 FT. 21.8 %  
OVER 20 FT. 6.7 %  
MAX. DEPTH 29 FEET.  
TOTAL ALK. 40 P.P.M.  
VOLUME 2999.7 ACRE FT.  
SHORELINE 7.3 MILES

Maps are not for navigation  
Source-Wisconsin Department of Natural Resources  
Hunt Fish Camp Wisconsin .Com 2005