

STATE OF WISCONSIN
DEPARTMENT OF NATURAL RESOURCES

LAKE SURVEY MAP

GRESHAM POND
LAKE
SHAWANO COUNTY
SEC. 3, 33, 34 T.-27, 28-N. R.-14 - E.W.

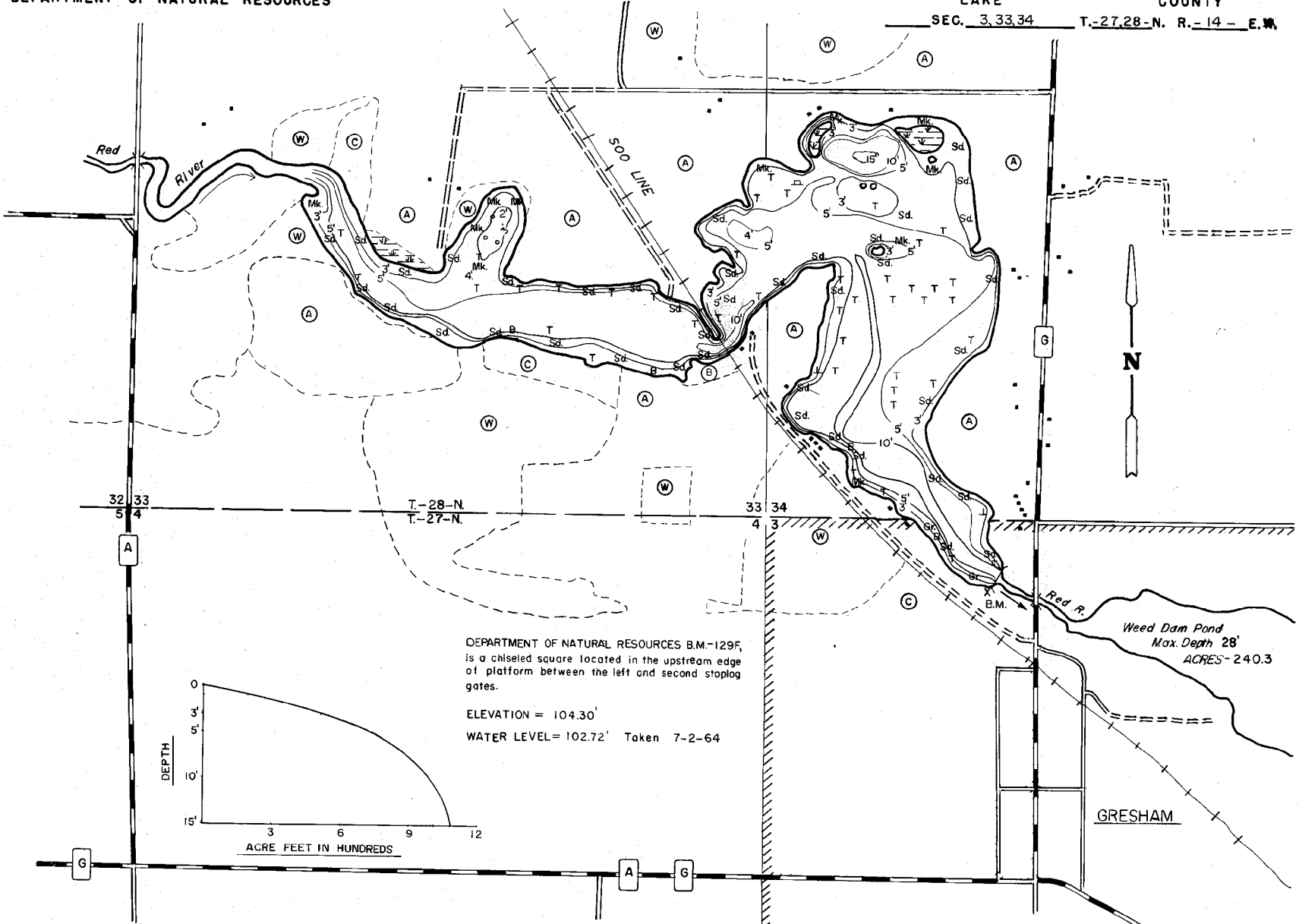

DEPARTMENT OF NATURAL RESOURCES B.M.-129F,
is a chiseled square located in the upstream edge
of platform between the left and second stoplog
gates.
ELEVATION = 104.30'
WATER LEVEL = 102.72' Taken 7-2-64

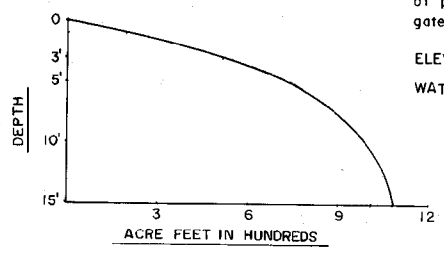

Weed Dam Pond
Max. Depth 28'
ACRES - 240.3

GRESHAM

EQUIPMENT RECORDING SONAR MAPPED MONTH YEAR

- | TOPOGRAPHIC SYMBOLS | | LAKE BOTTOM SYMBOLS | |
|----------------------|---------------------------|---------------------|-----------------------------|
| (B) Brush | Steep slope | P. Peat | B Boulders |
| (W) Partially wooded | ~ Indefinite shoreline | Mk. Muck | ⚓ Stumps & Snags |
| (W) Wooded | ~ Marsh | C. Clay | ⚠ Rock danger to navigation |
| (C) Cleared | ~ Spring | M. Marl | T. Submergent vegetation |
| (P) Pastured | ~ Intermittent stream | Sd. Sand | ↓ Emergent vegetation |
| (A) Agricultural | ~ Permanent inlet | Sl. Silt | ~ Floating vegetation |
| B.M. Bench Mark | ~ Permanent outlet | Gr. Gravel | ⚡ Brush shelters |
| ■ Dwelling | ~ Dam | R. Rubble | |
| ▣ Resort | ~ D.N.R. State owned land | Bc Bedrock | |
| ▣ Camp | | | |

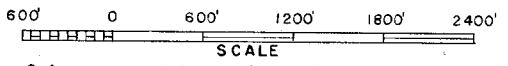

Access Access with Parking Boat Livery
Drawn by: T. Ginder
Field work by: J. Smith & P. Michelson

SPECIES OF FISH	PRESENT		
	Abundant	Common	Present
Muskie			
N. Pike	X		
Walleye	X		
L. M. Bass	X		
S. M. Bass	X		
Panfish	X		
Trout	X		

WATER AREA 187.60 ACRES
UNDER 3 FT. 16 %
OVER 20 FT. %
MAX. DEPTH 15.0 FEET
TOTAL ALK. 138.0 P.P.M.
VOLUME 1096.05 ACRE FT.
SHORELINE 4.75 MILES
WITH ISLANDS 5.22 MILES