

STATE OF WISCONSIN  
DEPARTMENT OF NATURAL RESOURCES

LAKE SURVEY MAP

HALSEY FLORENCE  
LAKE COUNTY  
SEC. 16-20-21 T. 39 N. R. 15 E. W.

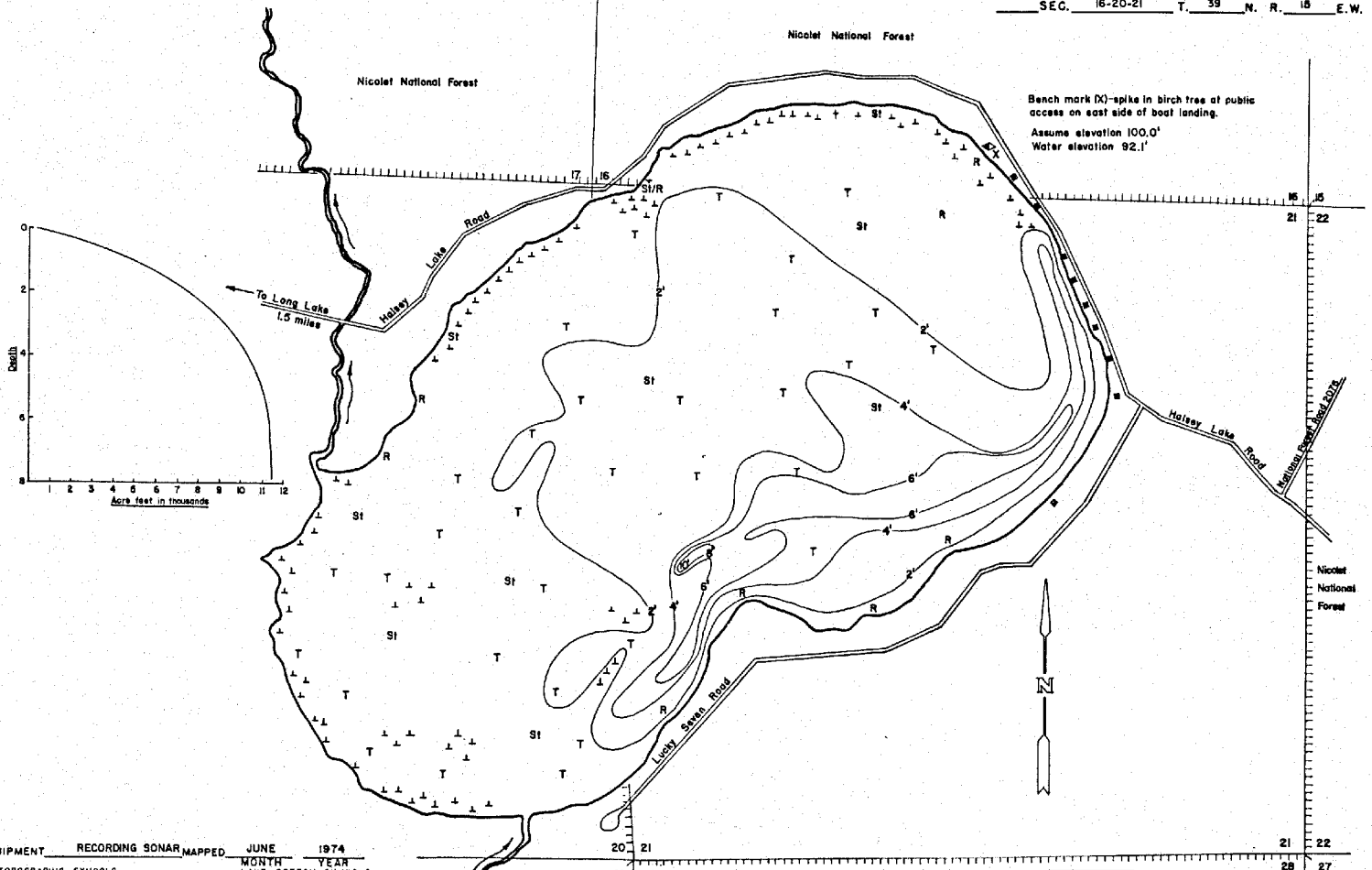

Bench mark (X)-spike in birch tree at public access on east side of boat landing.  
Assume elevation 100.0'  
Water elevation 92.1'

EQUIPMENT	RECORDING SONAR	MAPPED	JUNE	1974
		MONTH	YEAR	
		LAKE	BOTTOM	SYMBOLS
① Brush		Sleep slope	P. Peat	B Boulders
② Partially wooded	—	Indefinite shorelines	Mk Muck	St Stumps & Snags
③ Wooded	—	Marsh shorelines	C. Clay	Rck Rock danger to navigation
④ Cleared	—	Spring	M. Marl	T Submergent vegetation
⑤ Pastured	—	Intermittent stream	Sd. Sand	1 Emergent vegetation
⑥ Agricultural	—	Permanent inlet	Sl. Silt	2 Floating vegetation
B.M. Bench Mark	—	Permanent outlet	Gr. Gravel	3 Brush shelters
D Dwelling	—	Dam	R. Rubble	
R Resort	—	D.N.R. State owned land	Bc Bedrock	

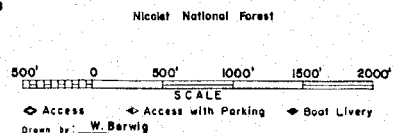

SPECIES OF FISH		Present
Muskie	X	
N Pike	X	
Walleye	X	
L.M. Bass	X	
S.M. Bass	X	
Perch	X	

WATER AREA	516.5	ACRES
UNDER 2 FT.	65	%
OVER 20 FT.		%
MAX. DEPTH	10	FEET
TOTAL ALK.	69	P.P.M.
VOLUME	1147.66	ACRE FT.
MAIN SHORELINE	409	MI

Maps are not for navigation  
Source-Wisconsin Department of Natural Resources  
Hunt Fish Camp Wisconsin .Com 2005