

STATE OF WISCONSIN
DEPARTMENT OF NATURAL RESOURCES

LAKE SURVEY MAP

TWIN FALLS FLOWAGE FLORENCE
LAKE COUNTY
2-3-20-21
SEC. 22-27-31 T. 39-40 N. R. 19 E.W.
Sheet 2 of 4 Sheets

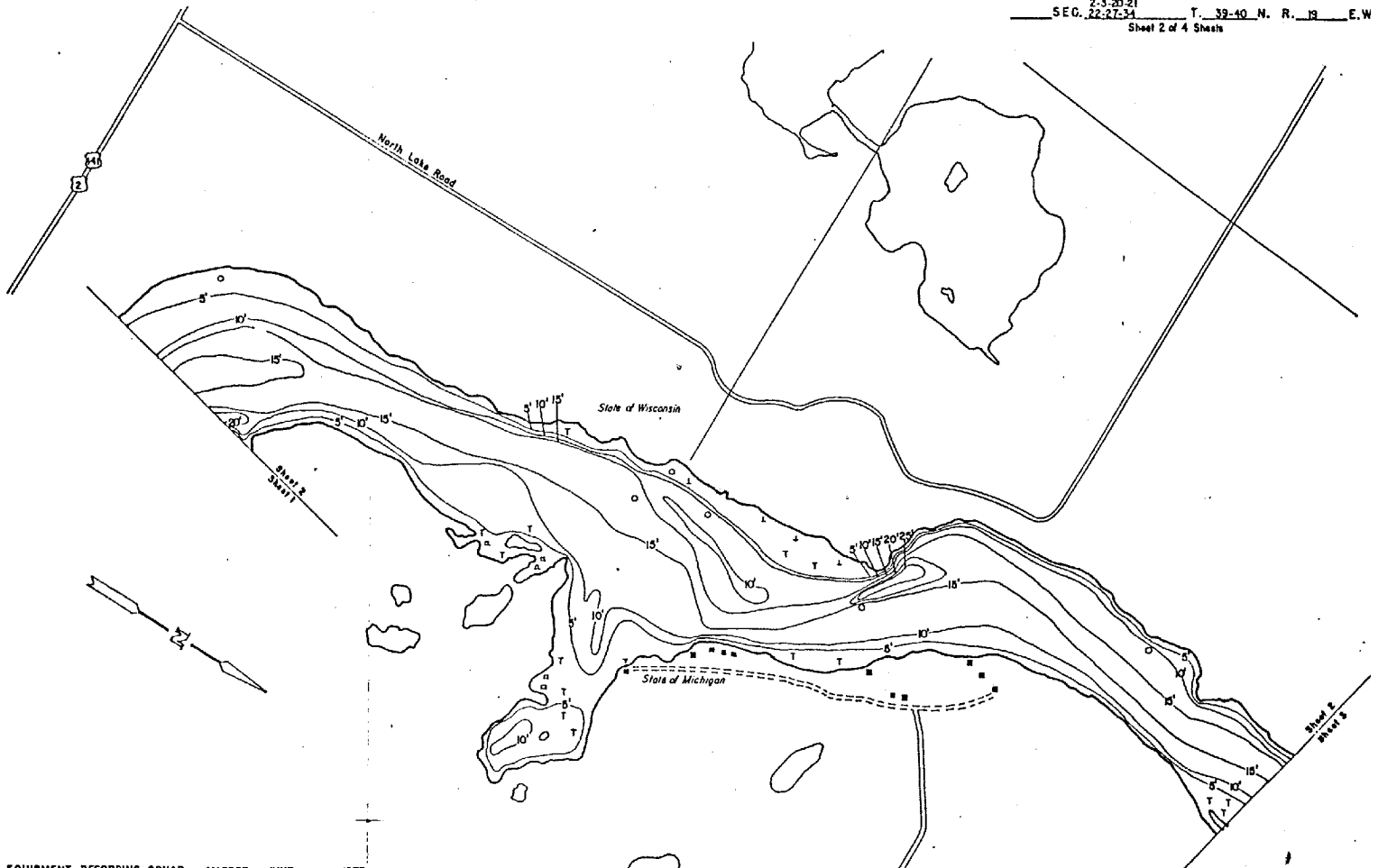

EQUIPMENT	RECORDING	SQBAR	MAPPED	JUNE	1979
			MONTH	YEAR	
LAKE BOTTOM SYMBOLS					
①	Brush	①	①	P. Peat	B. Boulders
②	Partially wooded	②	②	Mt. Muck	S. Stumps & Snags
③	Wooded	③	③	C. Clay	⊗ Rock danger to navigation
④	Cleared	④	④	M. Muck	T. Submergent vegetation
⑤	Pastured	⑤	⑤	So. Sand	I. Emergent vegetation
⑥	Agricultural	⑥	⑥	Sl. Silt	F. Floating vegetation
⑦	W. M. Beach Mark	⑦	⑦	Gr. Gravel	⊕ Brush shelters
⑧	Quarrying	⑧	⑧	D. Dam	
⑨	Camp	⑨	⑨	D.N.R. State owned land	Bc. Breakrock

500' 0 500' 1000' 1500' 2000'
SCALE
◊ Access ← Access with Parking → Boat Livery
Drawn by: W. Berzins
Field work by: D. Bette - R. Thron

SPECIES OF FISH	ABUNDANCE	
	1979	1980
Muskie	X	X
W. Pike	X	X
Walleye	X	X
S. Bass	X	X
P. Bass	X	X
Trout	X	X

WATER AREA 927.92 ACRES
UNDER 3 FT. 17 %
OVER 20 FT. 2 %
MAX. DEPTH 50 FEET
TOTAL ALK. 60 P.P.M.
VOLUME 9873.92 ACRE FT.
MAIN SHORELINE 18.9 MI.
ISLAND SHORELINE 3.9 MI.

Maps are not for navigation
Source-Wisconsin Department of Natural Resources
Hunt Fish Camp Wisconsin .Com 2005