

STATE OF WISCONSIN
DEPARTMENT OF NATURAL RESOURCES

LAKE SURVEY MAP

WHITE CLAY
LAKE

SHAWANO
COUNTY

← Cecil 2 miles 15 14
22 23

SEC. 22, 23, 26, 27 T. 27 N. R. 17 E.

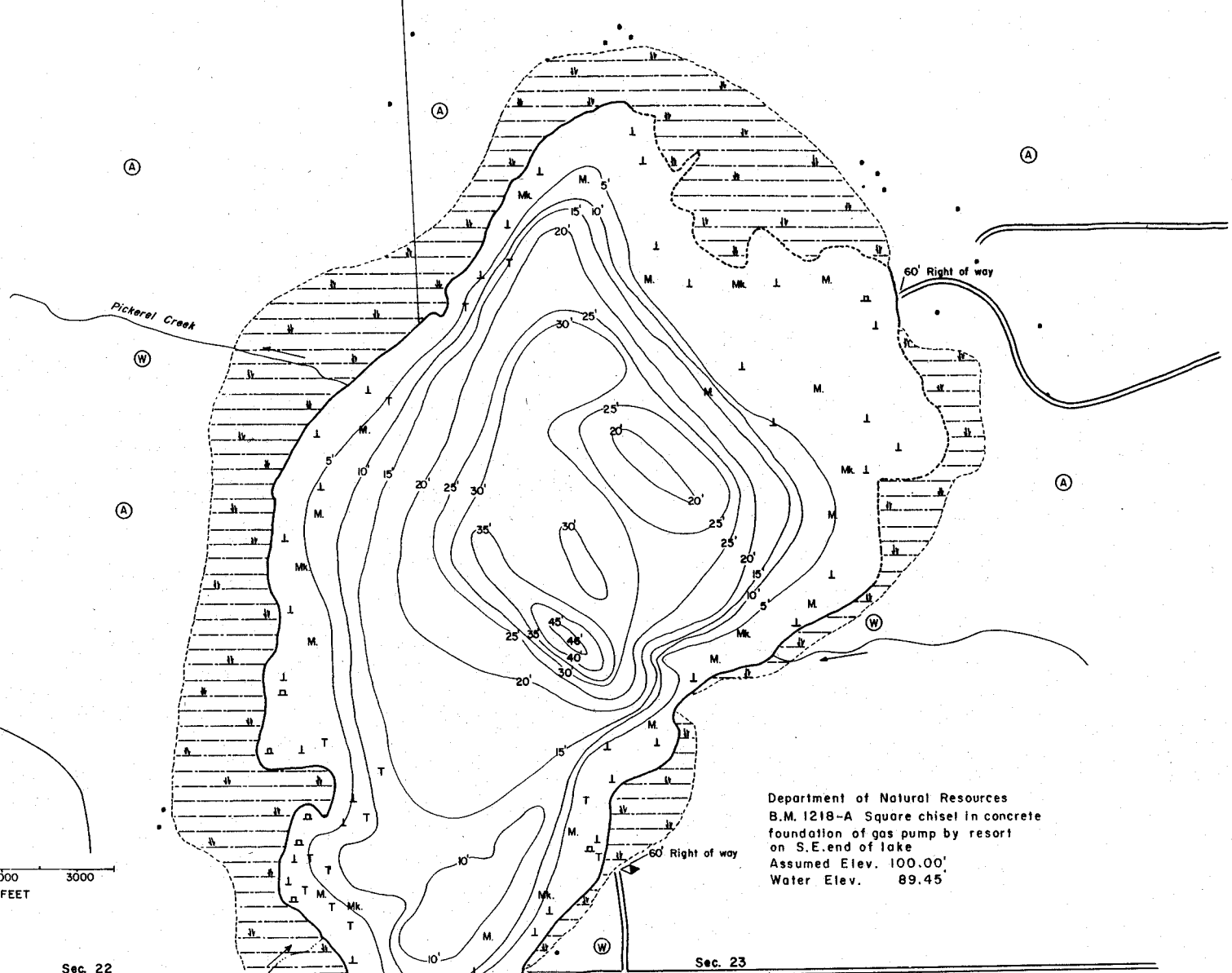
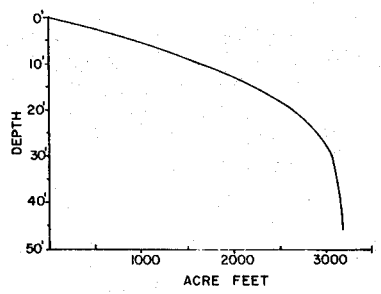
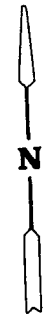

Department of Natural Resources
B.M. 1218-A Square chisel in concrete
foundation of gas pump by resort
on S.E. end of lake
Assumed Elev. 100.00'
Water Elev. 89.45'

EQUIPMENT RECORDING SONAR MAPPED
JUNE 1967
MONTH YEAR

- TOPOGRAPHIC SYMBOLS
- (B) Brush
 - (PW) Partly wooded
 - (W) Wooded
 - (C) Cleared
 - (P) Pastured
 - (A) Agricultural
 - B.M. Bench Mark
 - ||||| Steep slope
 - ~ Indefinite shoreline
 - Marsh
 - Spring
 - Intermittent stream
 - Permanent inlet
 - Permanent outlet

- LAKE BOTTOM SYMBOLS
- P. Peat
 - Mk. Muck
 - C. Clay
 - M. Marl
 - Sd. Sand
 - St. Silt
 - Gr. Gravel
 - B Boulders
 - Stumps & Snags
 - Rock danger to navigation
 - T Submergent vegetation
 - I Emergent vegetation
 - Floating vegetation
 - Brush shelters



- ◆ Access
- ◆ Access with Parking
- ◆ Boat Livery

SPECIES OF FISH	Abundance		
	Abundant	Common	Present
Muskie			
N. Pike	X		
Walleye	X		
L. M. Bass	X		
S. M. Bass	X		
Brook Trout			

WATER AREA 234.1 ACRES
 UNDER 3 FT. 20.6 %
 OVER 20 FT. 28.7 %
 MAX. DEPTH 46 FEET.
 TOTAL ALK. 165 P.P.M.
 VOLUME 3165.7 ACRE FT.
 CHADRON MILES