

STATE OF WISCONSIN
DEPARTMENT OF NATURAL RESOURCES

LAKE SURVEY MAP

WOLF RIVER POND LAKE SHAWANO COUNTY
SEC. 24, 25, 36 T. - 27- N. R. - 15- E.

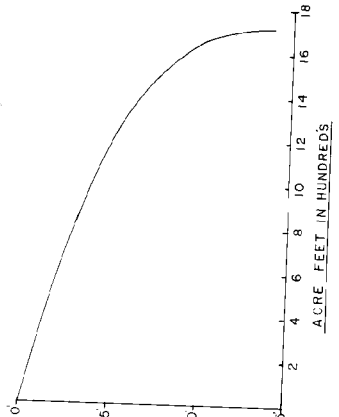
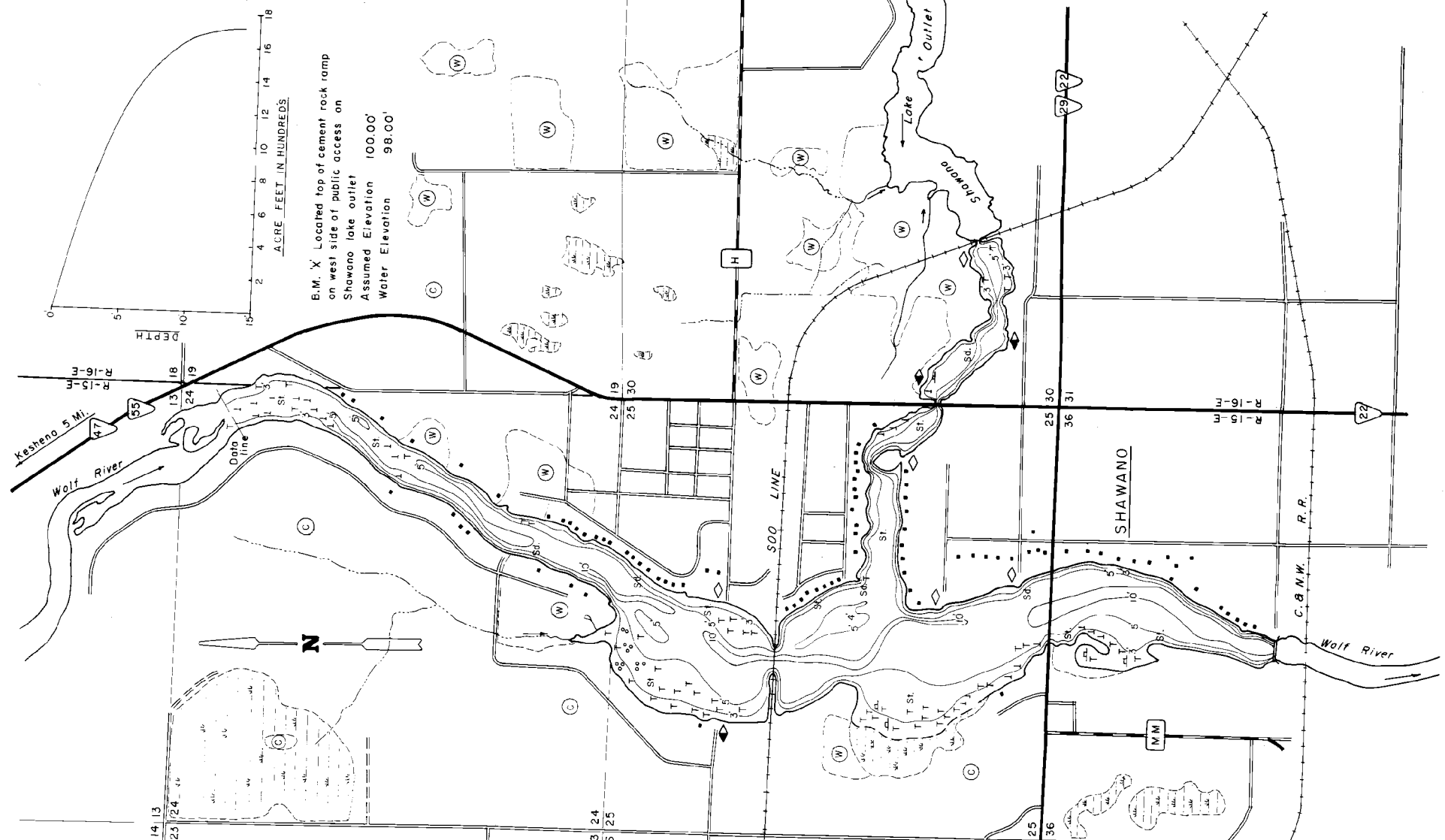

B.M. X Located top of cement rock ramp on west side of public access on Shawano lake outlet
Assumed Elevation 100.00'
Water Elevation 98.00'

EQUIPMENT RECORDING SONAR MAPPED JULY 1974

- TOPOGRAPHIC SYMBOLS
- (B) Brush
 - (PW) Partially wooded
 - (W) Wooded
 - (C) Cleared
 - (P) Pastured
 - (A) Agricultural
 - B.M. Bench Mark
 - (D) Dwelling
 - (R) Resort
 - (E) Camp
 - (S) Steep slope
 - (I) Indefinite shoreline
 - (M) Marsh
 - (SP) Spring
 - (IS) Intermittent stream
 - (PI) Permanent inlet
 - (PO) Permanent outlet
 - (D) Dam
 - (S.O.L.) State owned land
 - P. Peat
 - Mk. Muck
 - C. Clay
 - M. Marl
 - Sd. Sand
 - St. Silt
 - Gr. Gravel
 - R. Rubble
 - Br. Bedrock
 - B. Boulders
 - Stumps & Snags
 - Rock danger to navigation
 - T. Submergent vegetation
 - E. Emergent vegetation
 - F. Floating vegetation
 - Brush shelters



Access Access with Parking Boat Livery

Drawn by: E. Eaton
Field notes by: O. Boone, B. Thun

SPECIES OF FISH	ABUNDANCE		
	Abundant	Common	Present
Muskie		X	X
N. Pike	X	X	X
Walleye	X	X	X
L.M. Bass	X	X	X
S.M. Bass	X	X	X
Panfish	X	X	X
Trout	X	X	X

WATER AREA 3.05 ACRES
 UNDER 3 FT. 18 %
 OVER 20 FT. 0 %
 MAX. DEPTH 14 FEET.
 TOTAL ALK. 86 P.P.M.
 VOLUME 1,715.84 ACRE FT.
 MAIN SHORELINE 8.15 MI.
 ISLAND SHORELINE MI.