

STATE OF WISCONSIN  
DEPARTMENT OF NATURAL RESOURCES

LAKE SURVEY MAP

ALPINE LAKE WAUSHARA COUNTY  
LAKE COUNTY  
SEC. 4 T. 18 N. R. 11 E.W.

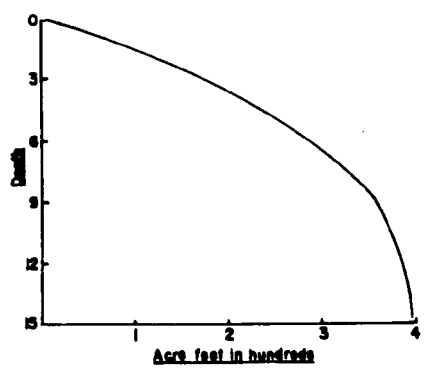
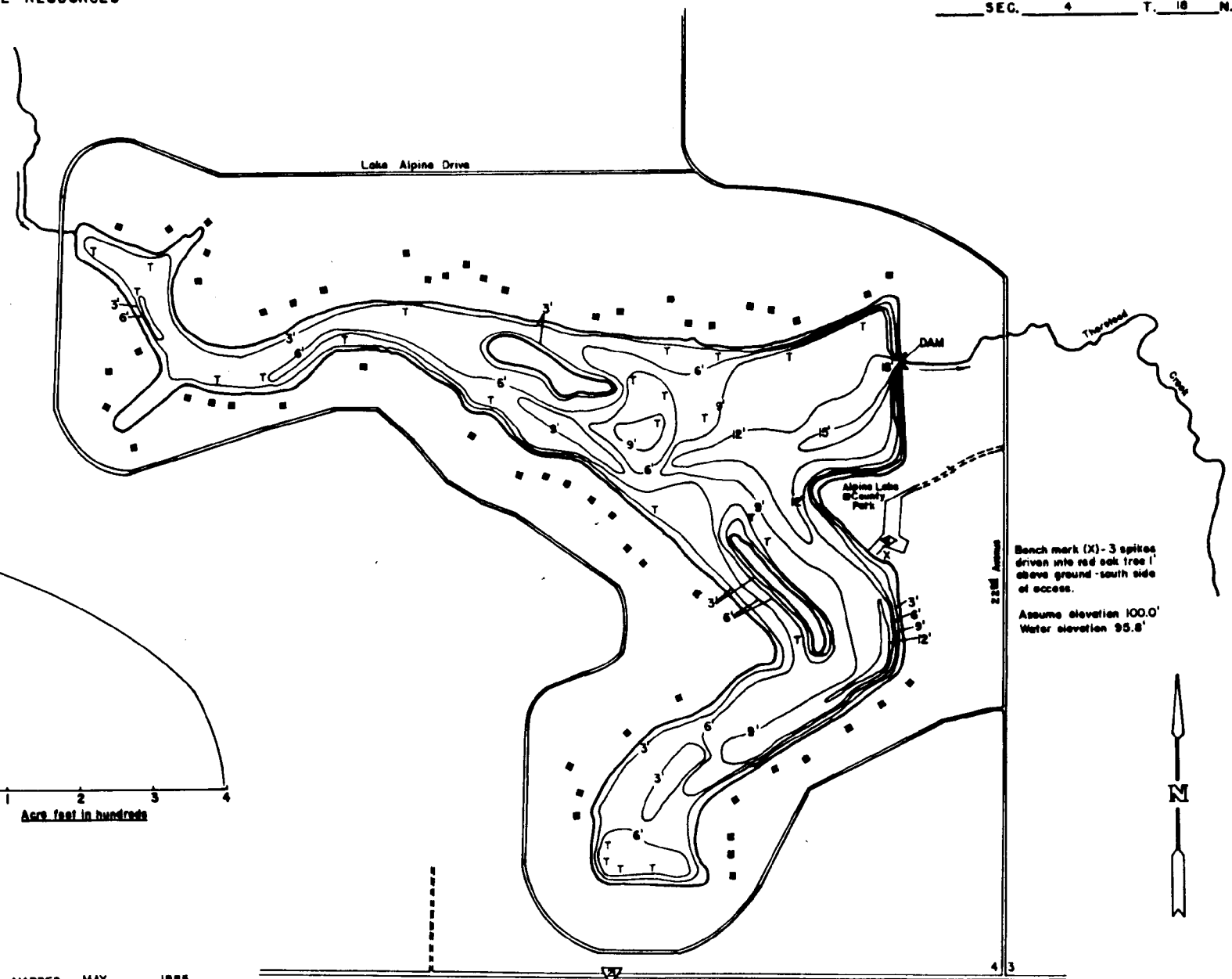

Bench mark (X) - 3 spikes driven into red oak tree 1' above ground - south side of access.  
Assume elevation 100.0'  
Water elevation 95.8'



EQUIPMENT RECORDING SONAR MAPPED MAY 1985

TOPOGRAPHIC SYMBOLS		LAKE BOTTOM SYMBOLS	
(B) Brush	(     ) Steep slope	P. Peat	B. Boulders
(PW) Partially wooded	(~) Indefinite shoreline	Mh. Muck	(X) Stumps & Snags
(W) Wooded	(M) Marsh	C. Clay	(R) Rock danger to navigation
(C) Cleared	(S) Spring	M. Marl	(T) Submergent vegetation
(P) Pastured	(~) Intermittent stream	Sd. Sand	(J) Emergent vegetation
(A) Agricultural	(=) Permanent inlet	St. Silt	(F) Floating vegetation
B.M. Bench Mark	(=) Permanent outlet	Gr. Gravel	(B) Brush shelters
(D) Dwelling	(=) Dam	R. Rubble	



Access Access with Parking Boat Livery  
Drawn by W. Barwic

SPECIES OF FISH	910		
	Abundant	Common	Rare
Walleye		X	
Yellow Perch		X	
Smallmouth Bass		X	
Rock Bass		X	
Whitefish		X	

WATER AREA 88.3 ACRES  
UNDER 3 FT. 27 %  
OVER 20 FT. %  
MAX. DEPTH 18 FEET.  
TOTAL ALK. P.P.M.  
VOLUME 300.36 ACRE FT.  
MAIN SHORELINE 2.56 MI.