

STATE OF WISCONSIN  
DEPARTMENT OF NATURAL RESOURCES

LAKE SURVEY MAP

ANNABELLE VILAS  
LAKE COUNTY  
SEC. -7, 12, 13, 18 T. -43- N. R. -6, 7- E.W.

Department of Natural Resources B.M. 1189-A, "x"  
A square chisel cut in the top of a rock outcrop. It is located 97 feet northwest of the waters' edge and 32 feet northeast of the access in the northeast corner of the lake.  
Assumed elevation 100.00'  
Water elevation 88.05', taken July 20, 1967.

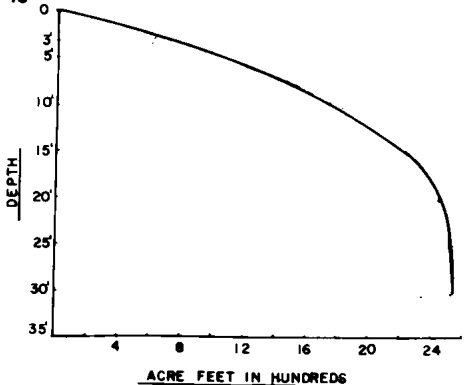
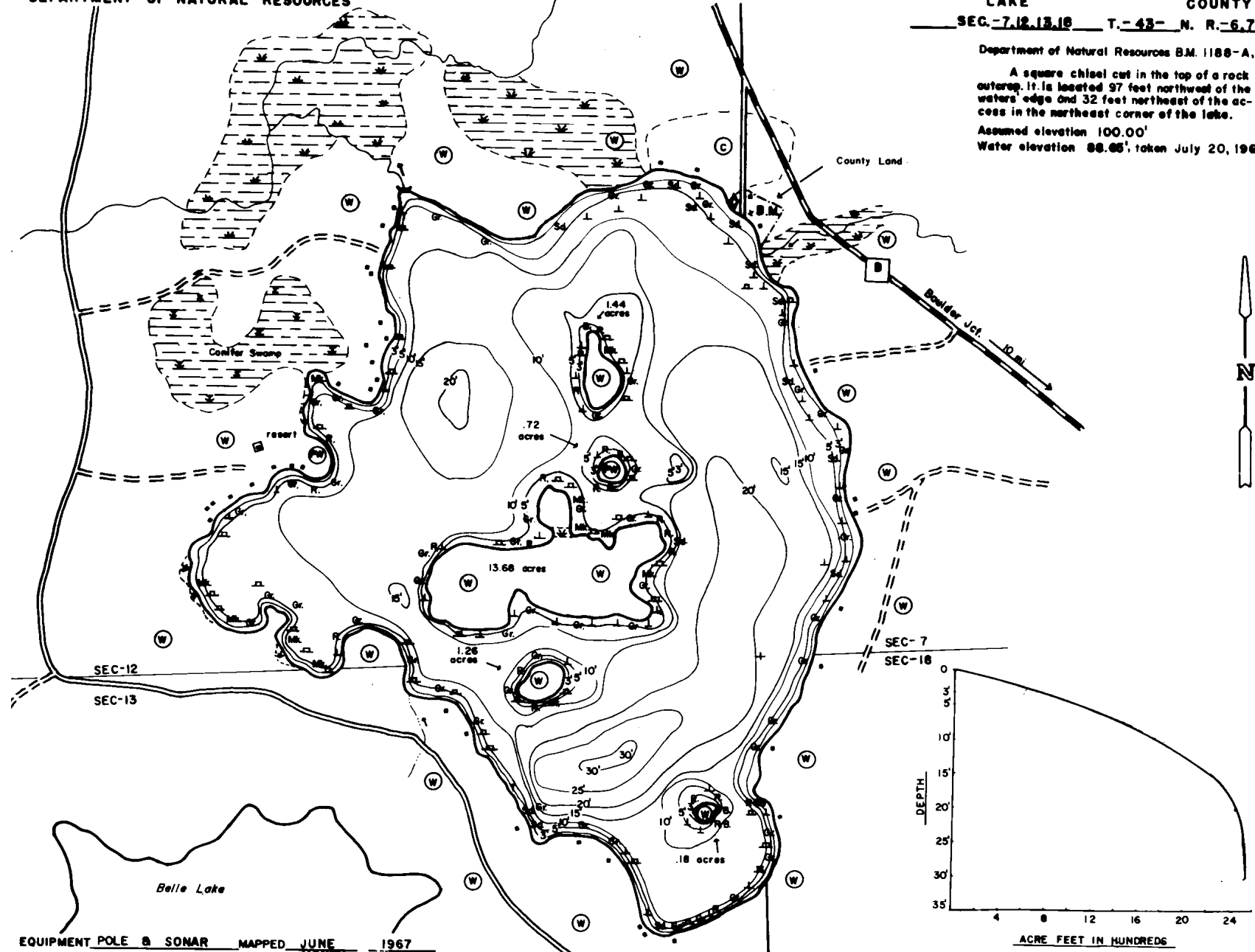

EQUIPMENT POLE & SONAR MAPPED JUNE 1967

- | TOPOGRAPHIC SYMBOLS |                            | LAKE BOTTOM SYMBOLS |                             |
|---------------------|----------------------------|---------------------|-----------------------------|
| (B) Brush           | (     ) Steep slope        | P. Peat             | B. Boulders                 |
| (W) Partly wooded   | (---) indefinite shoreline | Mk. Muck            | S Stumps & Snags            |
| (W) Wooded          | (---) Marsh                | C. Clay             | ⊗ Rock danger to navigation |
| (C) Cleared         | (---) Spring               | M. Marl             | ⊗ Submergent vegetation     |
| (P) Pastured        | (---) Intermittent stream  | Sd. Sand            | ⊥ Emergent vegetation       |
| (A) Agricultural    | (---) Permanent inlet      | Sl. Silt            | ⊕ Floating vegetation       |
| B.M. Bench Mark     | (---) Permanent outlet     | Gr. Gravel          | ⊕ Brush shelters            |



- ◇ Access      ◇ Access with Parking      ◇ Boat Livery

SPECIES OF FISH	
	Abundant Common Rare
Mudpike	✓
N. Pike	✓
Walleye	✓
L.M. Bass	✓
S.M. Bass	✓

WATER AREA 212.5 ACRES  
 UNDER 3 FT. 5.2 %  
 OVER 20 FT. 11.0 %  
 MAX. DEPTH 30 FEET.  
 TOTAL ALK. 10 P.P.M.  
 VOLUME 2548 ACRE FT.