

STATE OF WISCONSIN
DEPARTMENT OF NATURAL RESOURCES

LAKE SURVEY MAP

ANNE LAKE
Vilas COUNTY
SEC. 29, 30 T. 43 N. R. 6 E.

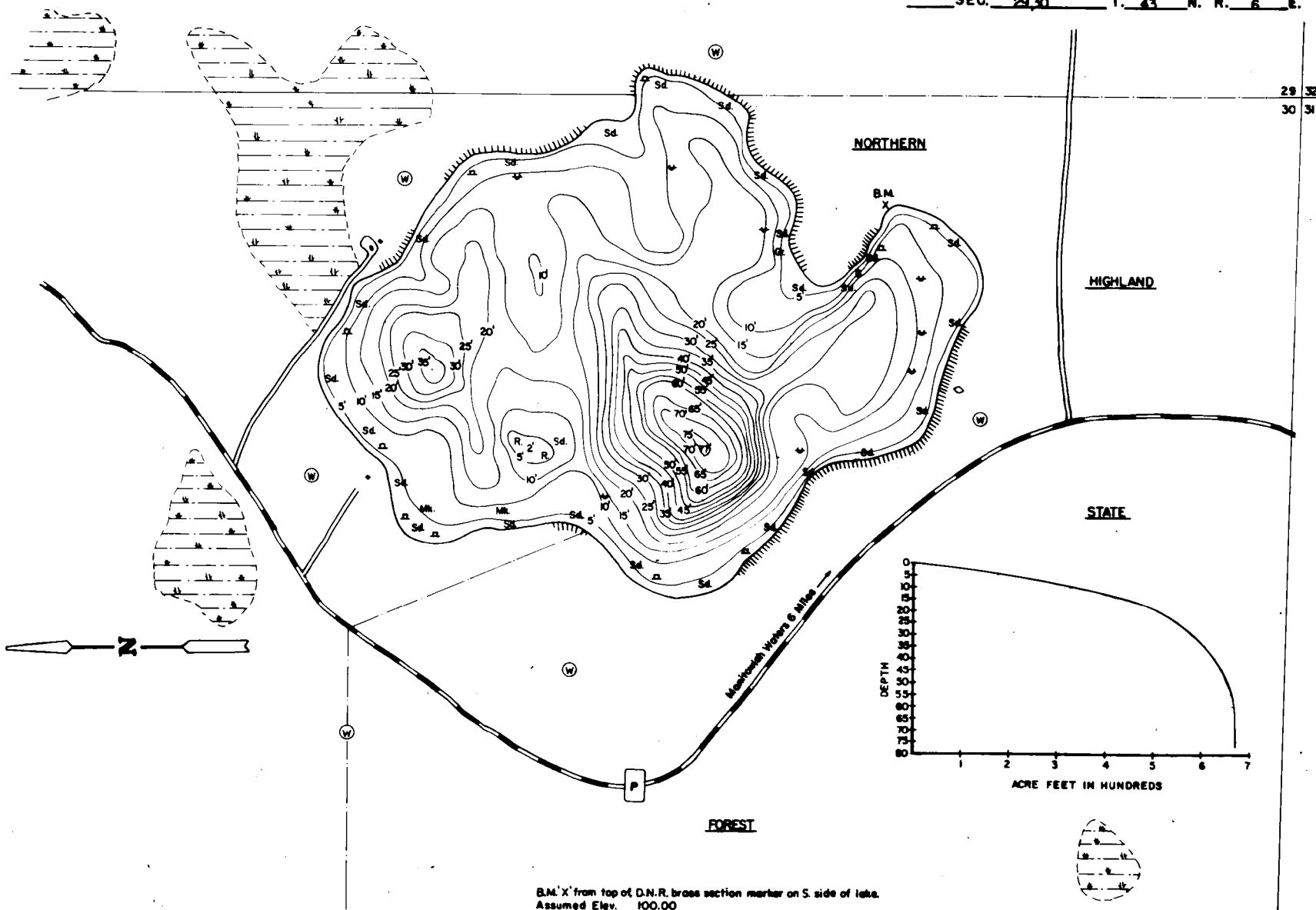

B.M. 'X' from top of D.N.R. cross section marker on S. side of lake.
Assumed Elev. 100.00
Water Elev. 95.80

- EQUIPMENT RECORDING SONAR MAPPED OCTOBER 1971
- | TOPOGRAPHIC SYMBOLS | | LAKE BOTTOM SYMBOLS | |
|---------------------|----------------------|---------------------|---------------------------|
| ⊙ | Brush | P. | Peat |
| ⊙ | Partially wooded | Mk. | Muck |
| ⊙ | Wooded | C. | Clay |
| ⊙ | Cleared | M. | Marl |
| ⊙ | Pastured | Sd. | Sand |
| ⊙ | Agricultural | Sl. | Silt |
| ⊙ | B.M. Bench Mark | Gr. | Gravel |
| | Steep slope | B | Boulders |
| ~ | Indefinite shoreline | ⌵ | Stumps & Snags |
| ⊙ | Marsh | ⊙ | Rock danger to navigation |
| ⊙ | Spring | ⌵ | Submerged vegetation |
| ⊙ | Intermittent stream | ⌵ | Emergent vegetation |
| ⊙ | Permanent inlet | ⌵ | Floating vegetation |
| ⊙ | Permanent outlet | ⌵ | Brush shelters |



SPECIES OF FISH	ABUNDANCE	
	Abundant	Present
Muskie		
N. Pike		
Walleye		
L. N. Bass		
S. W. Bass		

WATER AREA 372 ACRES
UNDER 3 FT. 6 %
OVER 20 FT. 28 %
MAX. DEPTH 27 FEET.
TOTAL ALK. 4 R.P.M.
VOLUME 672.6 ACRE FT.