

WISCONSIN CONSERVATION DEPARTMENT

LAKE SURVEY MAP

RABRO LAKE  
 POLK COUNTY  
 SEC. 27, 28 T. 33 N. R. 15 W.

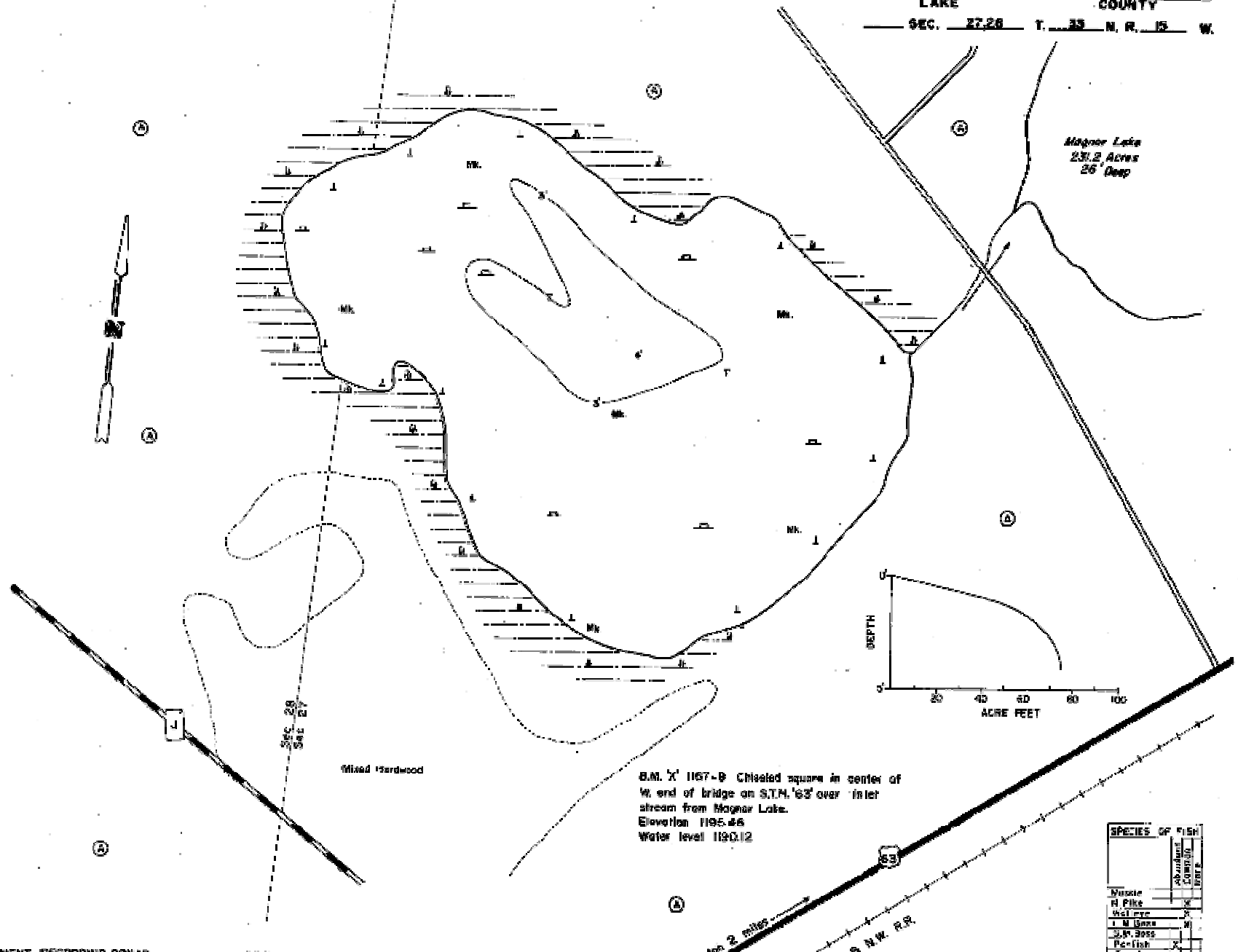

Mogor Lake  
 231.2 Acres  
 26' Deep

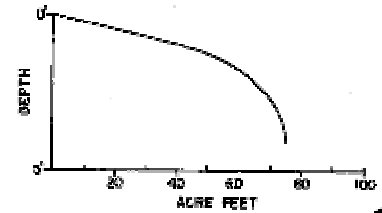

B.M. X' 1167-B Chiseled square in center of  
 W. end of bridge on S.T.M. '63' over inlet  
 stream from Mogor Lake.  
 Elevation 1195.46  
 Water level 1190.12

SPECIES OF FISH	
Species	Abundance Common Rare
Muskie	
H. Pike	X
Walleye	X
T. M. Bass	X
S.M. Bass	X
Perch	X
Trout	

EQUIPMENT RECORDING SONAR MAPPED JULY 1967  
 W.B. W.B.

- TOPOGRAPHIC SYMBOLS**
- Brush
  - Partially wooded
  - Wooded
  - Cleared
  - Pastured
  - Agricultural
- WATER ELEV. 1190.12**
- LAKE BOTTOM SYMBOLS**
- F. P. for Spring
  - W. M. for Intermittent stream
  - C. Clay
  - G. Gravel
  - S. Sand
  - R. Redrock
  - A. Stones
  - B. Swags

AREA 43.5 ACRES  
 UNDER 3 FT. 11.5 %  
 OVER 20 FT. 0 %  
 VOLUME 75.1 ACRE FT.

