

STATE OF WISCONSIN
DEPARTMENT OF NATURAL RESOURCES

LAKE SURVEY MAP

BEARSKIN LAKE ONEIDA COUNTY
SEC. 31, 35, 36, 2, 6 T. 37, 38 N. R. 6, 7 E.

Department of Natural Resources Bench Mark 1631-A.
Head of 3/8" lag screw in east side of base of twin birch
25' northwest of culvert under shore road.
Assumed Elevation 100.00'
Water Elevation 98.85'

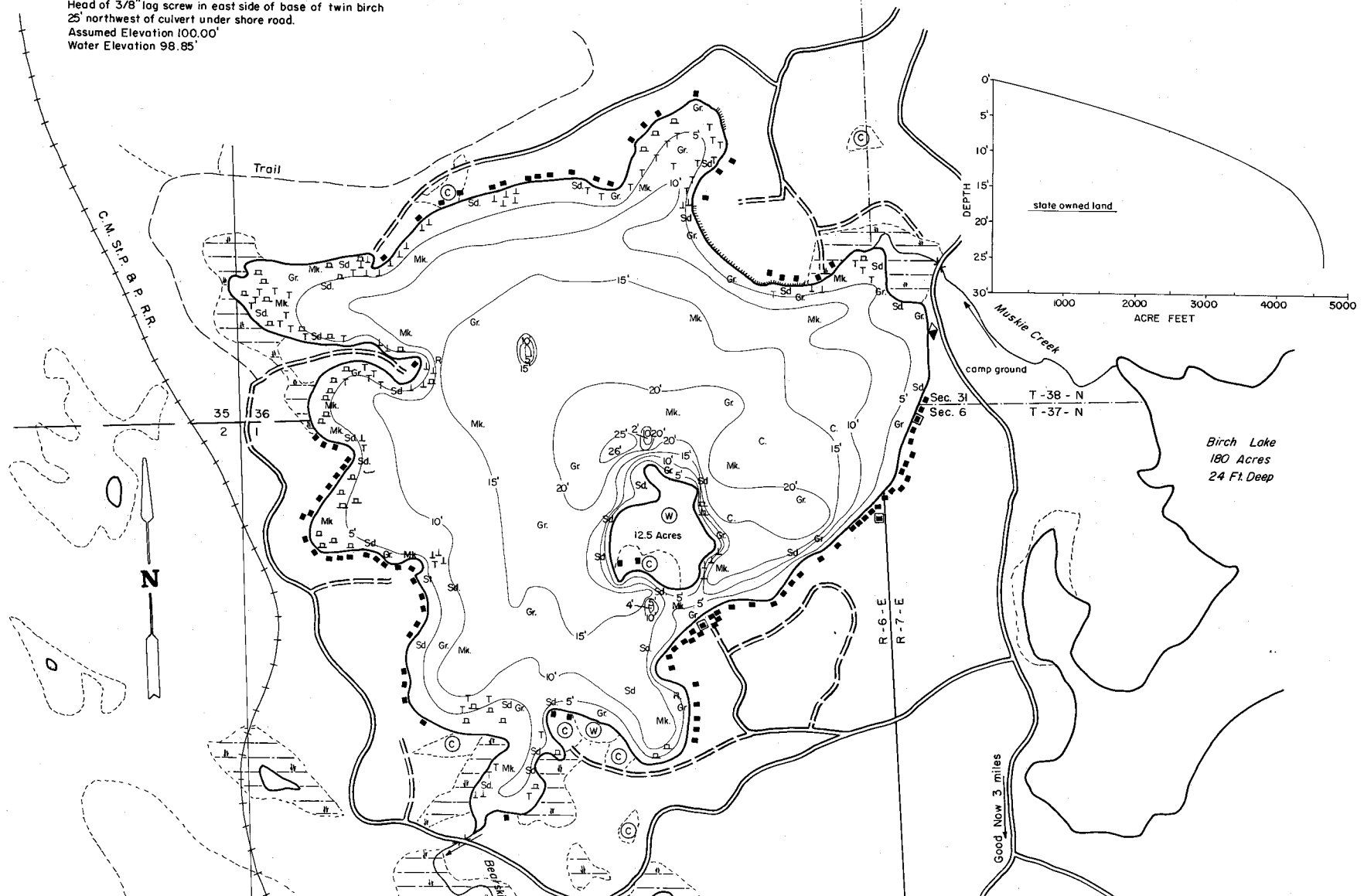

- | | | | | | | | |
|----------------------------|----------------------------|-----------------------|-----------------------------|------------------|--------------|--------------------|----------------|
| EQUIPMENT | HAND LINE | UPDATED MAPPED | JUNE 1968 | JULY 1938 | MONTH | LAKE BOTTOM | SYMBOLS |
| TOPOGRAPHIC SYMBOLS | | | | | | | |
| (B) Brush | Steep slope | P. Peat | B Boulders | | | | |
| (PW) Partly wooded | - - - Indefinite shoreline | Mk. Muck | ☼ Stumps & Snags | | | | |
| (W) Wooded | ▨ Marsh | C. Clay | ☼ Rock danger to navigation | | | | |
| (C) Cleared | ○ Spring | M. Marl | T Submergent vegetation | | | | |
| (P) Pastured | ~ Intermittent stream | Sd. Sand | ⊥ Emergent vegetation | | | | |
| (A) Agricultural | ▬ Permanent inlet | Sl. Silt | ⊠ Floating vegetation | | | | |
| B.M. Bench Mark | ▬ Permanent outlet | Gr. Gravel | ⊕ Brush shelters | | | | |
| ■ Dwelling | ⊥ Dam | R. Rubble | | | | | |



◆ Access ◆ Access with Parking ◆ Boat Livery
Drawn by: C. Holt

SPECIES OF FISH	ABUNDANCE		
	Abundant	Common	Present
Muskie	X		
N. Pike	X		
Walleye	X		
L. M. Bass	X		
S. M. Bass	X		
Panfish	X		
T.			

WATER AREA 400.3 ACRES
 UNDER 3 FT. 11.7 %
 OVER 20 FT. 7.5 %
 MAX. DEPTH 26 FEET.
 TOTAL ALK. 48 P.P.M.
 VOLUME 4636.8 ACRE FT.
 SHORELINE 5.59 MILES