

STATE OF WISCONSIN
DEPARTMENT OF NATURAL RESOURCES

LAKE SURVEY MAP

BEAVER DAM LAKE ASHLAND COUNTY
SEC. 1, 2, 31, 36 T. 44, 45 N. R. 3, 4 W.
SHEET 1 of 2

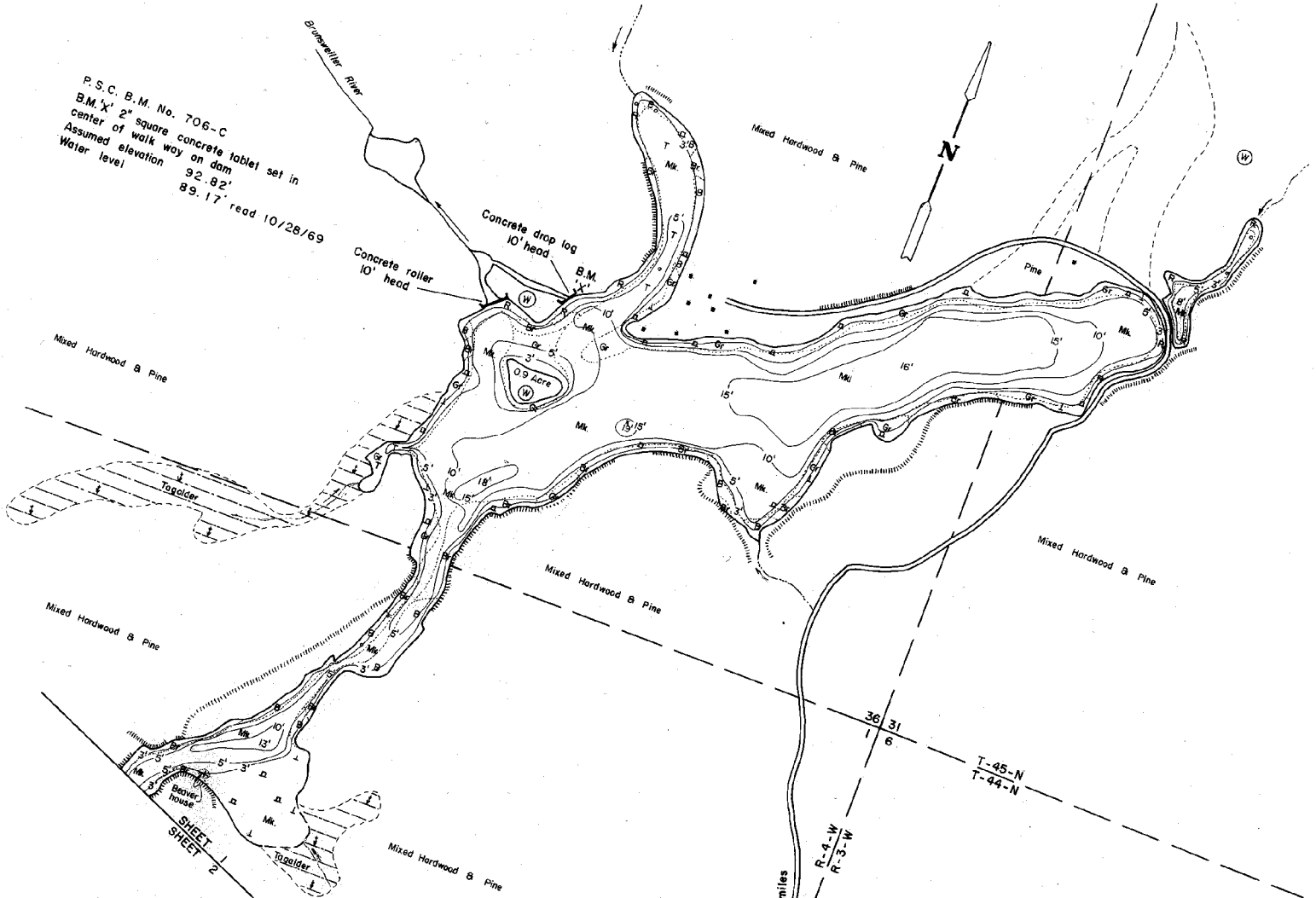

EQUIPMENT	RECORDING	SONAR	MAPPED	OCT	1969
TOPOGRAPHIC SYMBOLS				MONTH	YEAR
(B) Brush	(W) Partly wooded	(M) Marsh	(C) Cleared	(P) Pastured	(A) Agricultural
(B.M.) Bench Mark	(D) Dwelling	(R) Resort	(C) Camp		
(S) Steep slope	(I) Indefinite shoreline	(M) Marsh	(S) Spring	(IS) Intermittent stream	(PI) Permanent inlet
(P) Peat	(Mk) Muck	(C) Clay	(M) Marl	(Sd) Sand	(St) Silt
(B) Boulders	(S) Stumps & Snags	(R) Rock danger to navigation	(T) Submergent vegetation	(E) Emergent vegetation	(F) Floating vegetation
(Gr) Gravel	(R) Rubble	(Br) Bedrock			

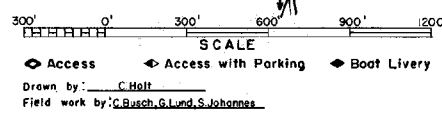

SPECIES OF FISH	ABUNDANCE		
	Abundant	Common	Present
Muskie	X		
N. Pike	X		
Walleye	X		
L. M. Bass	X		
S. M. Bass	X		
Panfish	X		
Trou	X		

WATER AREA 1180 ACRES
UNDER 3 FT. 39 %
OVER 20 FT. 0 %
MAX. DEPTH 19 FEET.
TOTAL ALK. 20 P.P.M.
VOLUME 659.8 ACRE FT.
SHORELINE 5.39 MILES
SHORELINE 6.03 MILES WITH IS.

Maps are not for navigation
Source-Wisconsin Department of Natural Resources
Hunt Fish Camp Wisconsin .Com 2005