

WISCONSIN CONSERVATION DEPARTMENT

LAKE SURVEY MAP

LAKE BEAVER DAM  
 SECTIONS 5,6,7,8,26,27,35,36,1  
 TOWNSHIP T-35,36-N  
 RANGE R-13,14-W CUMBERLAND  
 TOWN MAPLE PLAIN CRYSTAL LAKE  
 COUNTY BARRON  
 (Sheet 2 of 2)

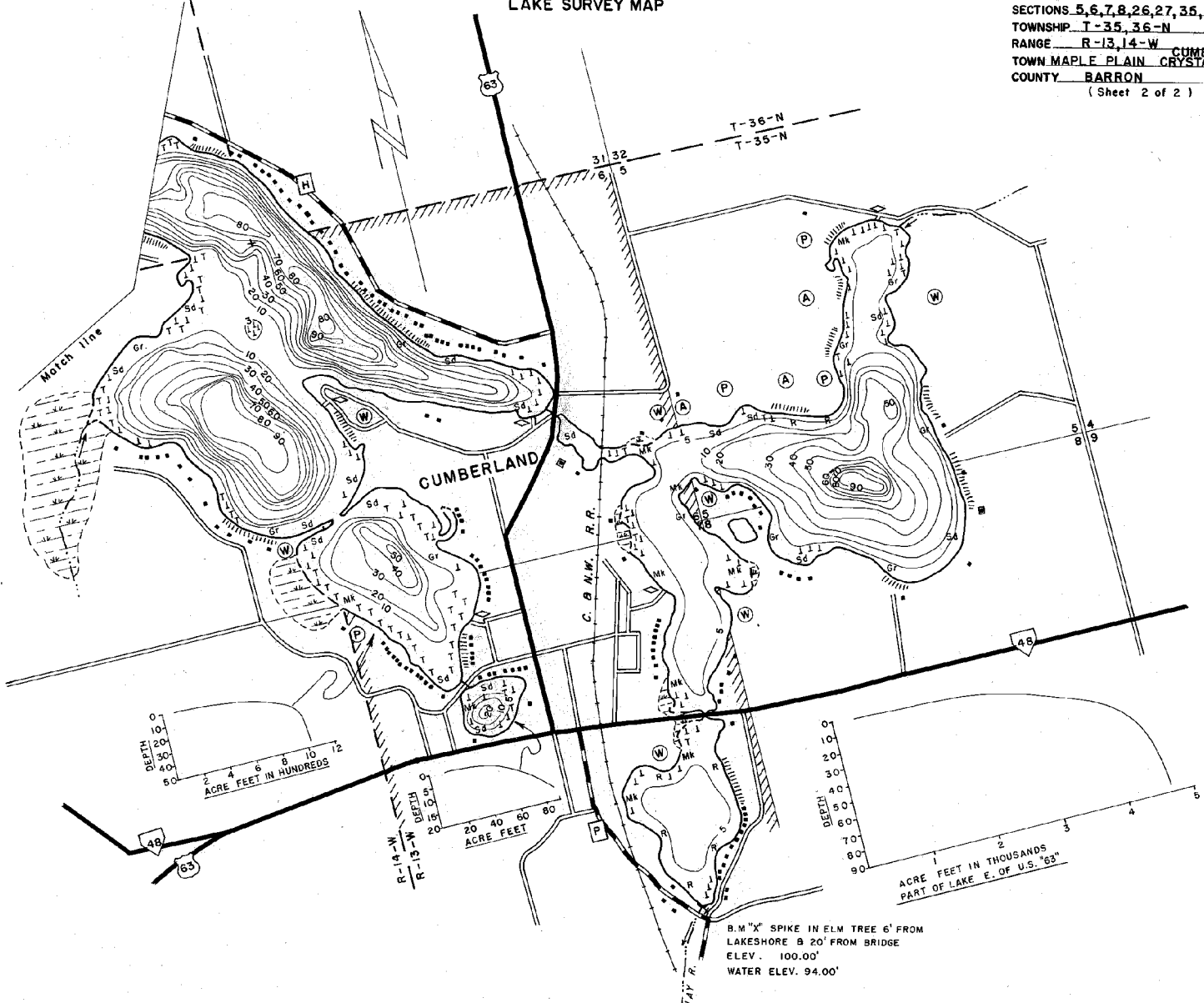

LAKE MAPPED SEPTEMBER 1964  
 SOURCE OF INFORMATION W.C.D.  
 SOUNDINGS RECORDING SONAR  
 TOTAL ALK. 33 P.P.M.

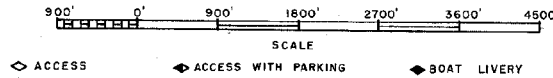

AREA 1,112 ACRES  
 TOTAL SHORELINE 18 MILES  
 MAX. DEPTH 106 FEET  
 SCALE: AS SHOWN

Maps are not for navigation  
 Source-Wisconsin Department of Natural Resources  
 Hunt Fish Camp Wisconsin .Com 2005