

WISCONSIN CONSERVATION DEPARTMENT

LAKE SURVEY MAP

LAKE BEECHWOOD
 SECTIONS 17
 TOWNSHIP T-13-N
 RANGE R-20-E
 TOWN SCOTT
 COUNTY SHEBOYGAN

- LEGEND**
- TOPOGRAPHIC SYMBOLS**
- (B) Brush
 - (PW) Partially wooded
 - (W) Wooded
 - (C) Cleared
 - (P) Pastured
 - (A) Agricultural
 - B.M. Bench Mark
 - Cottage
 - ||||| Steep slope
 - - - Indefinite shoreline
 - ||||| Marsh
 - Spring
 - Intermittent stream
 - Permanent inlet
 - Permanent outlet
 - Dam

- LAKE BOTTOM SYMBOLS**
- P. Peat
 - Mk. Muck
 - C. Clay
 - M. Marl
 - Sd. Sand
 - Gr. Gravel
 - R. Rubble
 - Br. Bedrock
 - T Submergent vegetation
 - I Emergent vegetation

SPECIES OF FISH			
	Abundant	Common	Rare
Muskie			
N. Pike		X	
Walleye			
L.M. Bass		X	
S.M. Bass			
Panfish		X	
Trout			

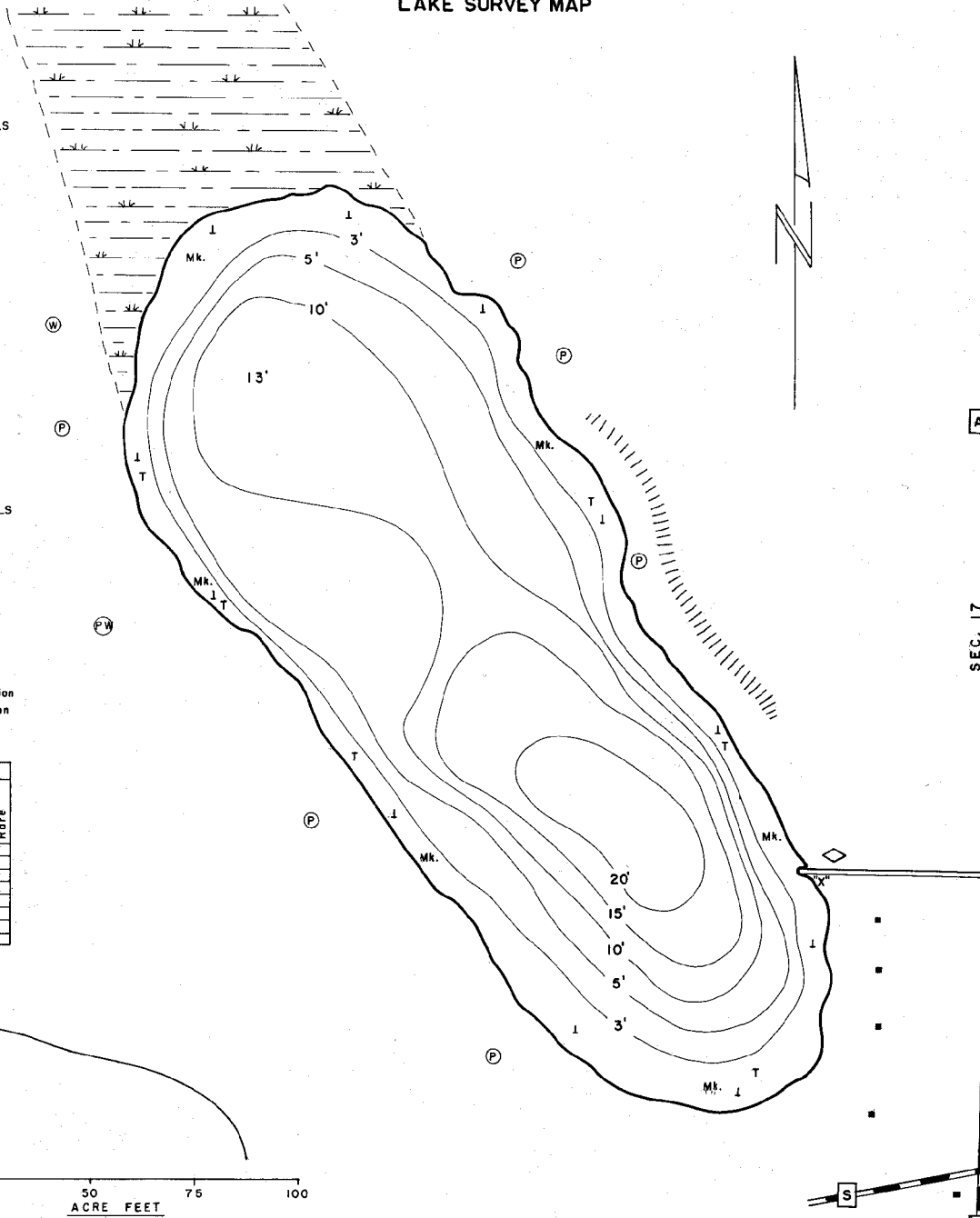
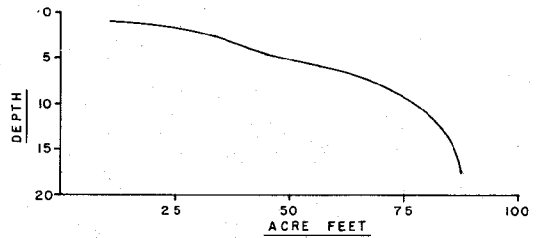

B.M. "x" TWO SPIKES IN NORTH SIDE OF WILLOW TREE NEAREST LAKE ON SOUTH SIDE OF ACCESS
 ELEV. 100.00'
 WATER ELEV. 94.6'

BEECHWOOD

FIELD WORK BY: H. SCHMUDE
 DRAWN BY: E. EATON
 LAKE MAPPED MAY 1964
 SOURCE OF INFORMATION W.C.D.
 SOUNDINGS RECORDING SONAR

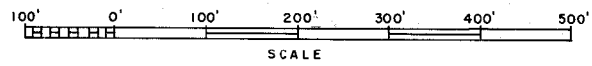

AREA 10.9 ACRES
 TOTAL SHORELINE .57 MILES
 MAX. DEPTH 20 FEET

ACCESS ACCESS WITH PARKING BOAT LIVERY