

Hunt Fish Camp Wisconsin

STATE OF WISCONSIN
DEPARTMENT OF NATURAL RESOURCES

LAKE SURVEY MAP

BIG DOCTOR BURNETT
LAKE COUNTY
SEC. 6, 7 T. 38 N. R. 16 W.
SHEET 1 OF 2

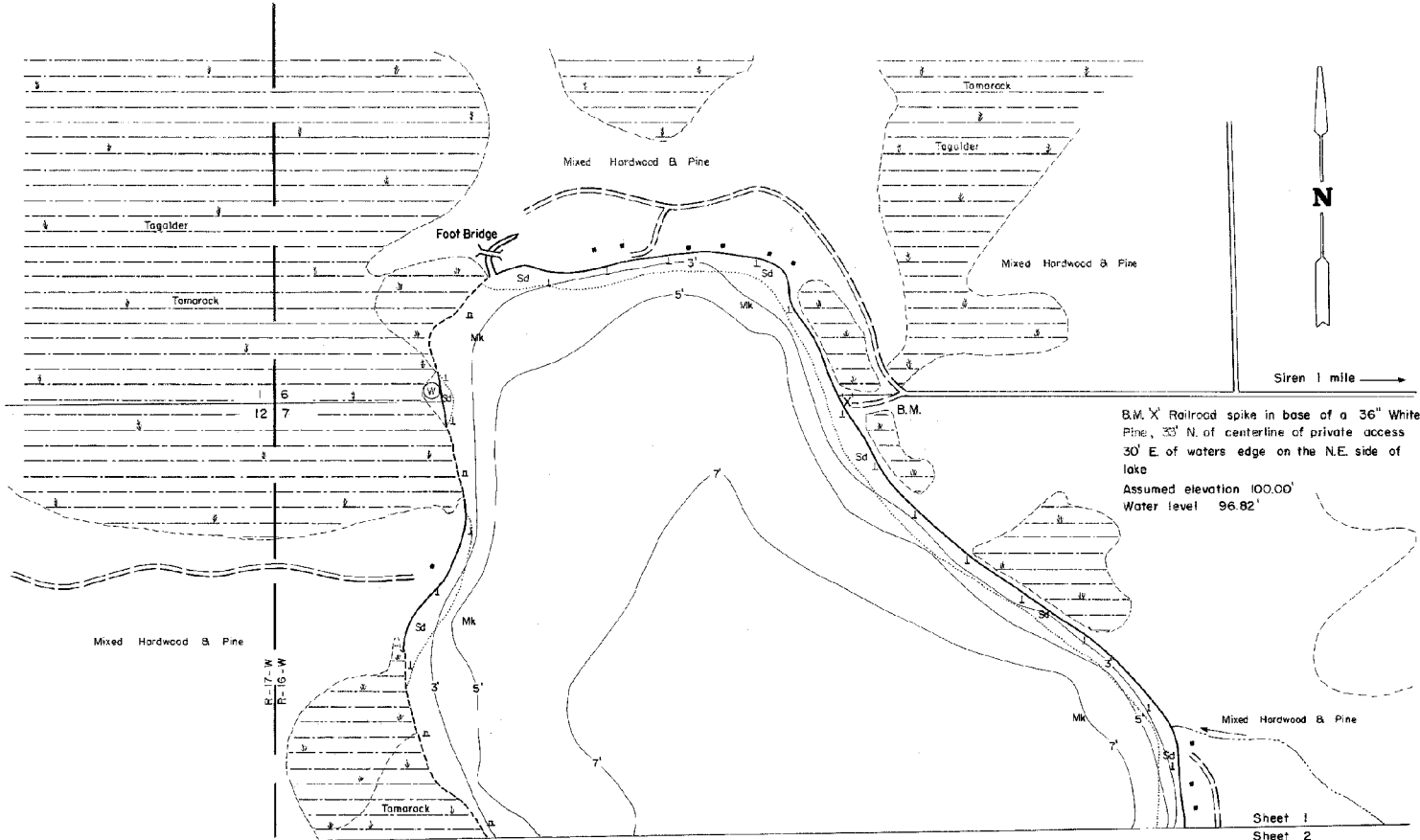

EQUIPMENT	RECORDING	SONAR	MAPPED	MONTH	YEAR
				JUNE	1973
TOPOGRAPHIC SYMBOLS					
(B) Brush		Steep slope			
(PW) Partially wooded	-----	Indefinite shoreline			
(W) Wooded		Marsh			
(C) Cleared	-----	Spring			
(P) Pastured	-----	Intermittent stream			
(A) Agricultural	-----	Permanent inlet			
B.M. Beach Mark	-----	Permanent outlet			
■ Dwelling	-----	Dam			
□ Resort	-----	D.N.R. State owned land			
□ Camp	-----				
LAKE BOTTOM SYMBOLS					
P. Peat	B	Boulders			
Mk. Muck	⊙	Stumps & Snags			
C. Clay	⊙	Rock danger to navigation			
M. Marl	⊙	Submergent vegetation			
Sd. Sand	⊙	Emergent vegetation			
Sl. Silt	⊙	Floating vegetation			
Gr. Gravel	⊙	Brush shelters			
R. Rubble	⊙				
Bc. Bedrock	⊙				

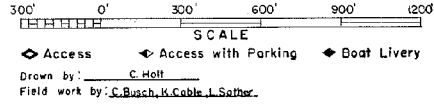

SPECIES OF FISH	1973		
	Abundant	Common	Present
Muskie			
N. Pike			
Walleye	X		
L. M. Bass	X		
S. M. Bass	X		
Panfish	X		
Trout			

WATER AREA 212.4 ACRES
 UNDER 3 FT. 9 %
 OVER 20 FT. 0 %
 MAX. DEPTH 9 FEET.
 TOTAL ALK. 6 P.P.M.
 VOLUME 1,309 ACRE FT.
 SHORELINE 2.39 MILES

Source-Wisconsin Department of Natural Resources
 Hunt Fish Camp Wisconsin .Com 2005