

STATE OF WISCONSIN
DEPARTMENT OF NATURAL RESOURCES

LAKE SURVEY MAP

RIG DUMMY BARRON
LAKE COUNTY
SEC. 28 T.-36- N. R.-13- E.W.

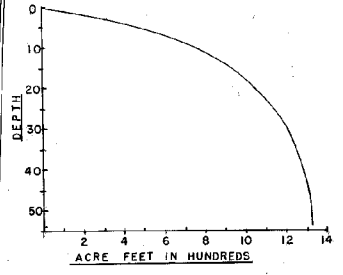
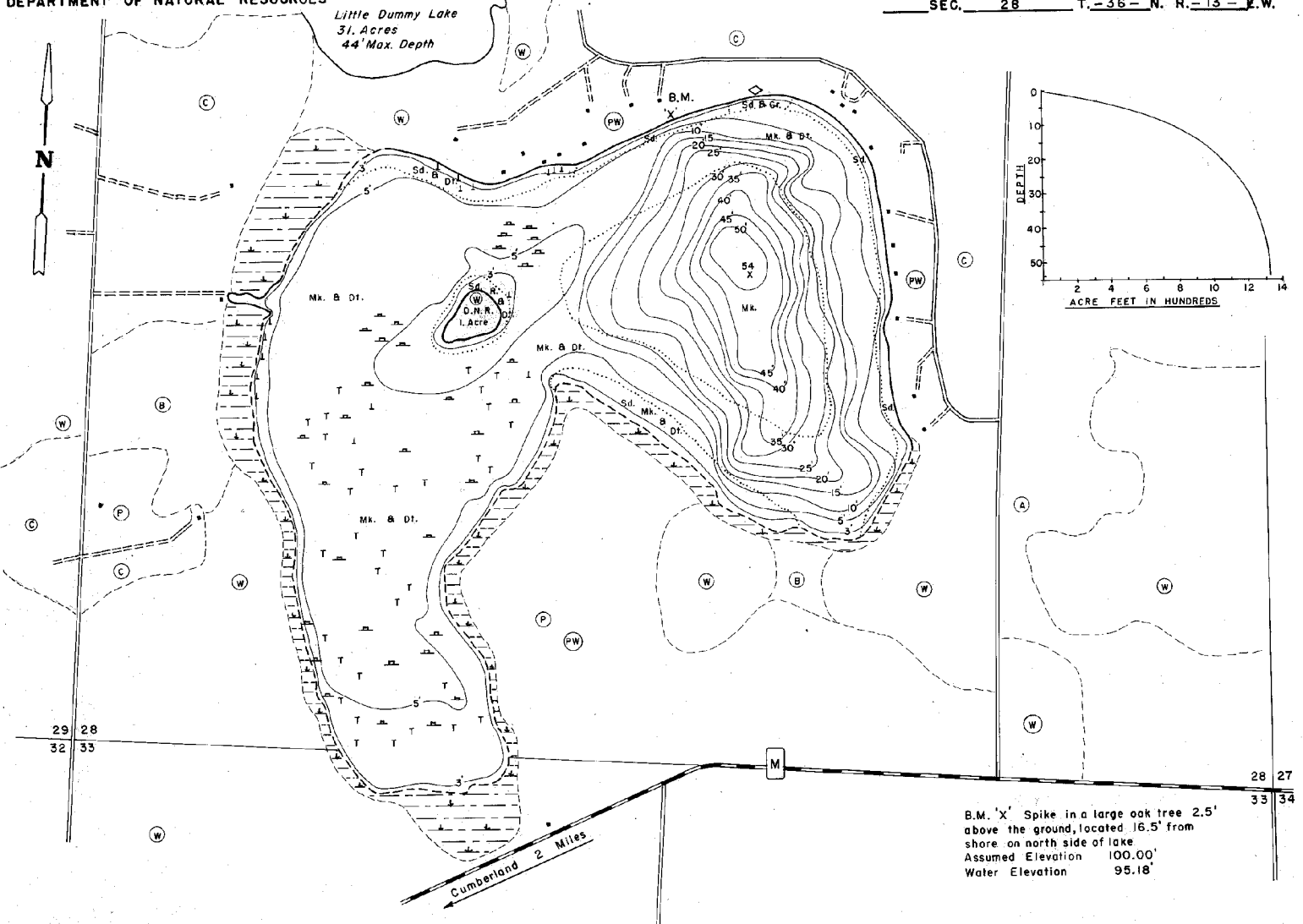

B.M. 'X' Spike in a large oak tree 2.5' above the ground, located 16.5' from shore on north side of lake
Assumed Elevation 100.00'
Water Elevation 95.18'

EQUIPMENT	SONAR & POLE	MAPPED	JULY	1972
		MONTH	YEAR	
		LAKE BOTTOM SYMBOLS		
(B)	Brush	()	Steep slope	P. Peat
(W)	Partially wooded	(---)	Indefinite shoreline	Mk. Muck
(W)	Wooded	(---)	Marsh	C. Clay
(C)	Cleared	(---)	Spring	M. Marl
(P)	Pastured	(---)	Intermittent stream	Sd. Sand
(A)	Agricultural	(---)	Permanent inlet	St. Silt
B.M.	Bench Mark	(---)	Permanent outlet	Gr. Gravel
(#)	Dwelling	(---)	Dam	R. Rubble
(#)	Resort	(---)	D.N.R. State owned land	Br. Bedrock
(#)	Camp			B. Boulders
				Stumps & Snags
				Rock danger to navigation
				Submergent vegetation
				Emergent vegetation
				Floating vegetation
				Brush shelters
				Detritus

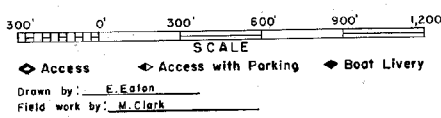

SPECIES OF FISH	ABUNDANT		PRESENT
	Common	Present	
Muskie			
N. Pike	X		
Walleye	X		
L. M. Bass	X		
S. M. Bass	X		
Panfish	X		
Trout			

WATER AREA 110.7 ACRES
UNDER 3 FT. 6 %
OVER 20 FT. 20 %
MAX. DEPTH 54 FEET.
TOTAL ALK. 6 P.P.M.
VOLUME 1,322. ACRE FT.
SHORELINE 2.17 MILES
WITH ISLAND 2.23 MILES

Maps are not for navigation
Source-Wisconsin Department of Natural Resources
Hunt Fish Camp Wisconsin .Com 2005