

STATE OF WISCONSIN
DEPARTMENT OF NATURAL RESOURCES

LAKE SURVEY MAP

BIG KITTEN LAKE
VILAS COUNTY
SEC. 33, 34 T. -43- N. R. - 7 - E.

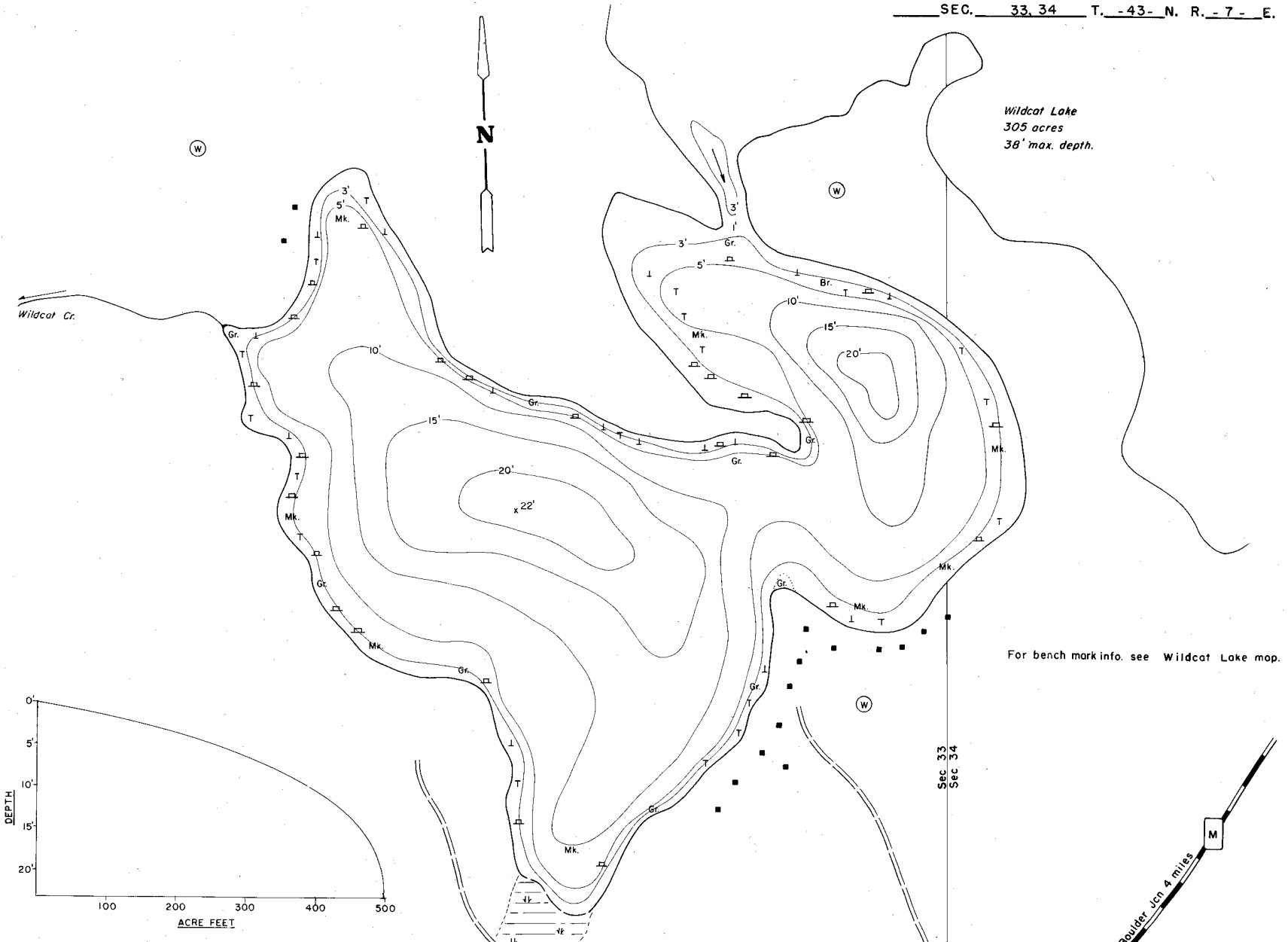

Wildcat Lake
305 acres
38' max. depth.

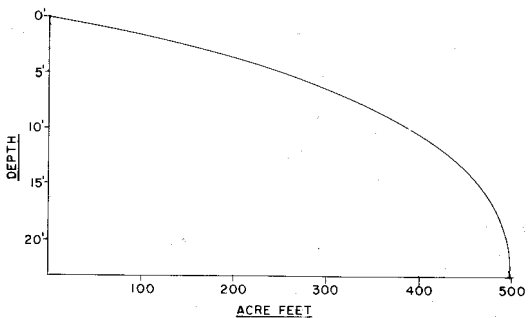

For bench mark info. see Wildcat Lake map.

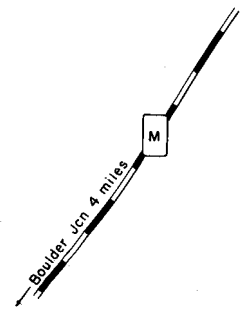

EQUIPMENT RECORDING SONAR MAPPED MONTH YEAR
LAKE BOTTOM SYMBOLS

- | | | | |
|-----------------------|------------------------|------------|-----------------------------|
| (B) Brush | Steep slope | P. Peat | B Boulders |
| (PW) Partially wooded | ~ Indefinite shoreline | Mk. Muck | * Stumps & Snags |
| (W) Wooded | ~ Marsh | C. Clay | ⊗ Rock danger to navigation |
| (C) Cleared | ~ Spring | M. Marl | T Submergent vegetation |
| (P) Pastured | ~ Intermittent stream | Sd. Sand | ⊥ Emergent vegetation |
| (A) Agricultural | ~ Permanent inlet | St. Silt | ⊥ Floating vegetation |
| B.M. Bench Mark | ~ Permanent outlet | Gr. Gravel | ⊥ Brush shelters |
| ■ Dwelling | ~ Dam | R. Rubble | |

SCALE 200' 0 200' 400' 600' 800'

◆ Access ◀ Access with Parking ◆ Boat Livery

Drawn by: W. Sniders

SPECIES OF FISH	Abundance		
	Abundant	Common	Present
Muskie			X
N. Pike			X
Walleye			X
L. M. Bass			X
S. M. Bass			X
Panfish	X		

WATER AREA 54.6 ACRES
UNDER 3 FT. 14 %
OVER 20 FT. 4 %
MAX. DEPTH 22 FEET.
TOTAL ALK. 68 P.P.M.
VOLUME 498.8 ACRE FT.
SHORELINE 1.79 MILES