

SURVEY MAP

BIG ROUND LAKE POLK COUNTY
SEC. 11,12,13,14 T. -35- N. R. -16- P.W.

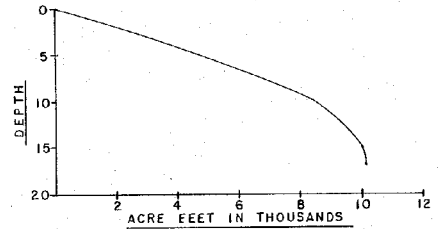
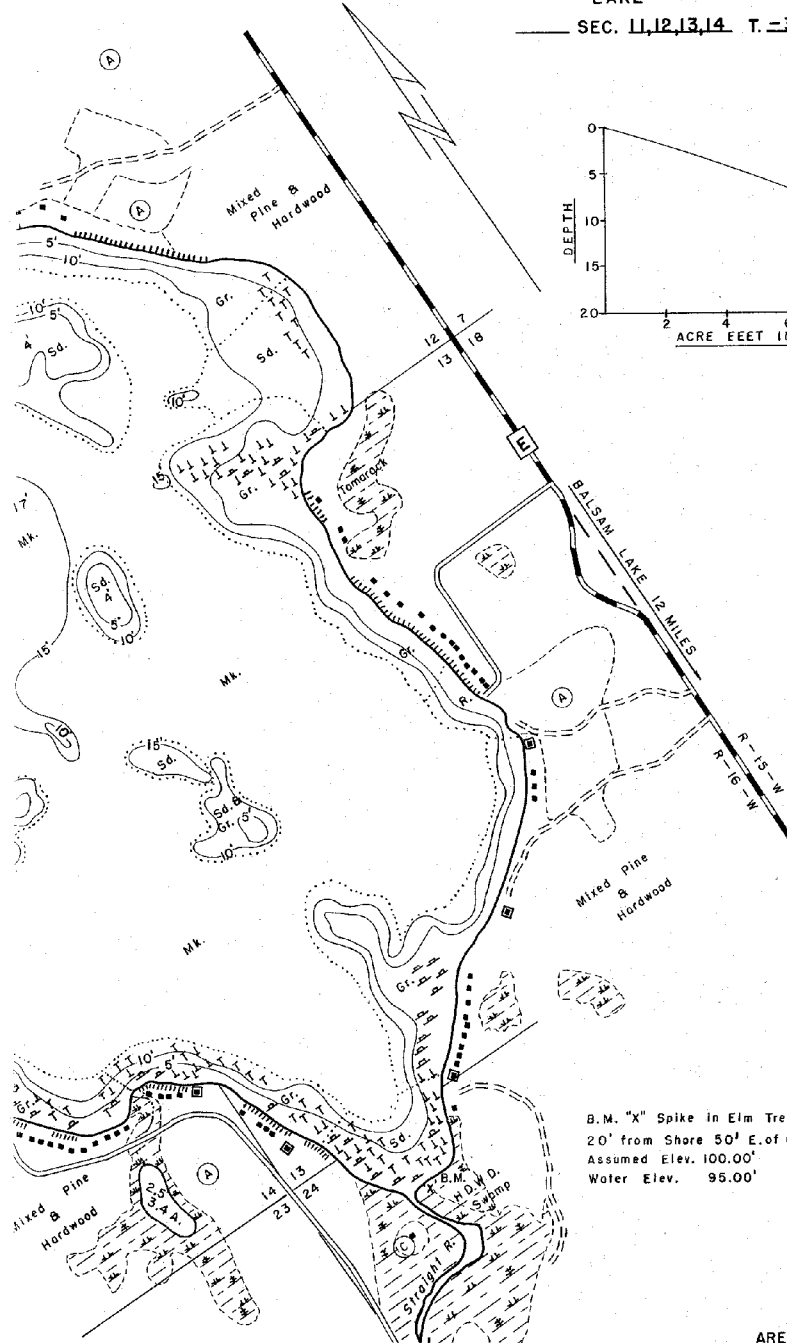

B.M. "X" Spike in Elm Tree
 20' from Shore 50' E. of Outlet
 Assumed Elev. 100.00'
 Water Elev. 95.00'

SPECIES OF FISH	Abundance		
	Abundant	Common	Rare
Muskie			
N. Pike		X	
Walleye		X	
L. M. Bass	X		
S. M. Bass			
Panfish	X		
Trout			

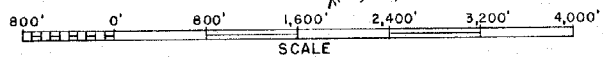

1,016.5 WITH ISLAND
 AREA 1,015.1 ACRES
 UNDER 5 FT. 19 %
 OVER 20 FT. 0 %
 VOLUME 10,083.5 ACRE FT.
 TOTAL ALK. 105 P.P.M.
 SHORELINE 5.7 MILES