

STATE OF WISCONSIN
DEPARTMENT OF NATURAL RESOURCES

LAKE SURVEY MAP

BLOM LAKE POLK COUNTY
SEC. 4,5 T. 37 N. R. 17 W.

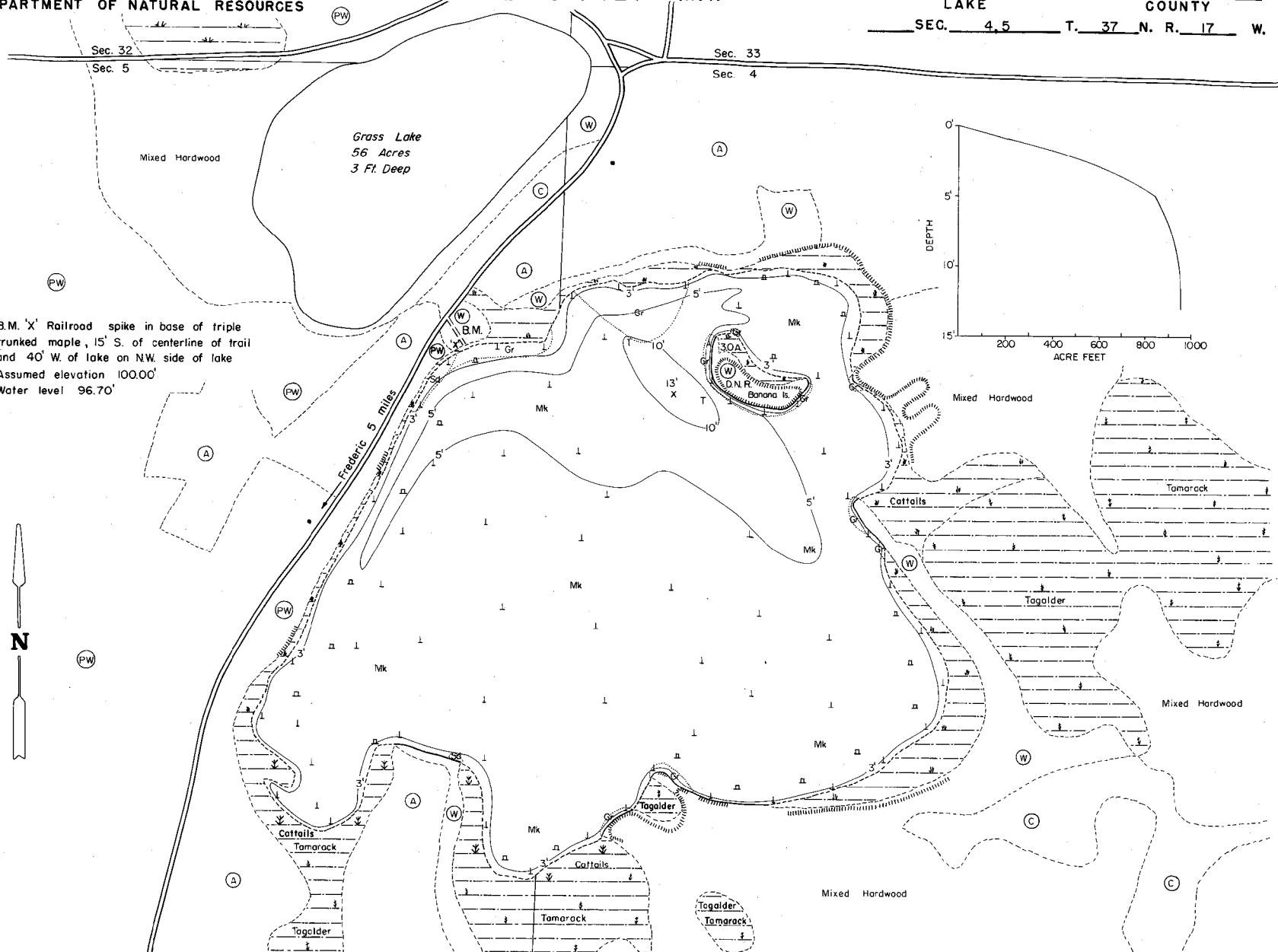

B.M. 'X' Railroad spike in base of triple trunked maple, 15' S. of centerline of trail and 40' W. of lake on N.W. side of lake
Assumed elevation 100.00'
Water level 96.70'

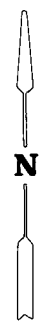
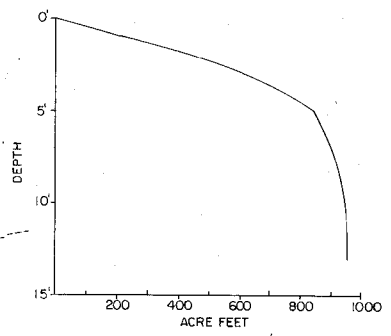

EQUIPMENT RECORDING SONAR MAPPED MONTH YEAR
JUNE 1971

- TOPOGRAPHIC SYMBOLS**
- (B) Brush
 - (PW) Partially wooded
 - (W) Wooded
 - (C) Cleared
 - (P) Pastured
 - (A) Agricultural
 - B.M. Bench Mark
 - Dwelling
- LAKE BOTTOM SYMBOLS**
- P. Peat
 - Mk. Muck
 - C. Clay
 - M. Marl
 - Sd. Sand
 - St. Silt
 - Gr. Gravel
 - R. Rubble
 - B Boulders
 - Stumps & Snags
 - Rock danger to navigation
 - T Submergent vegetation
 - Emergent vegetation
 - Floating vegetation
 - Brush shelters



Access Access with Parking Boat Livery

SPECIES OF FISH	ABUNDANCE		
	Abundant	Common	Present
Muskie			
N Pike	X		
Walleye		X	
L.M. Bass			X
S.M. Bass			X
Panfish		X	

WATER AREA 208.4 ACRES

UNDER 3 FT. 4.1 %
OVER 20 FT. 0 %

MAX. DEPTH 13 FEET.

TOTAL ALK. 90 P.P.M.

VOLUME 957 ACRE FT.
SHORELINE 2.67 MILES