

STATE OF WISCONSIN  
DEPARTMENT OF NATURAL RESOURCES

LAKE SURVEY MAP

MUD (BRIDGET) LAKE  
POLK COUNTY  
SEC. 33 T. 34 N. R. 17 W.

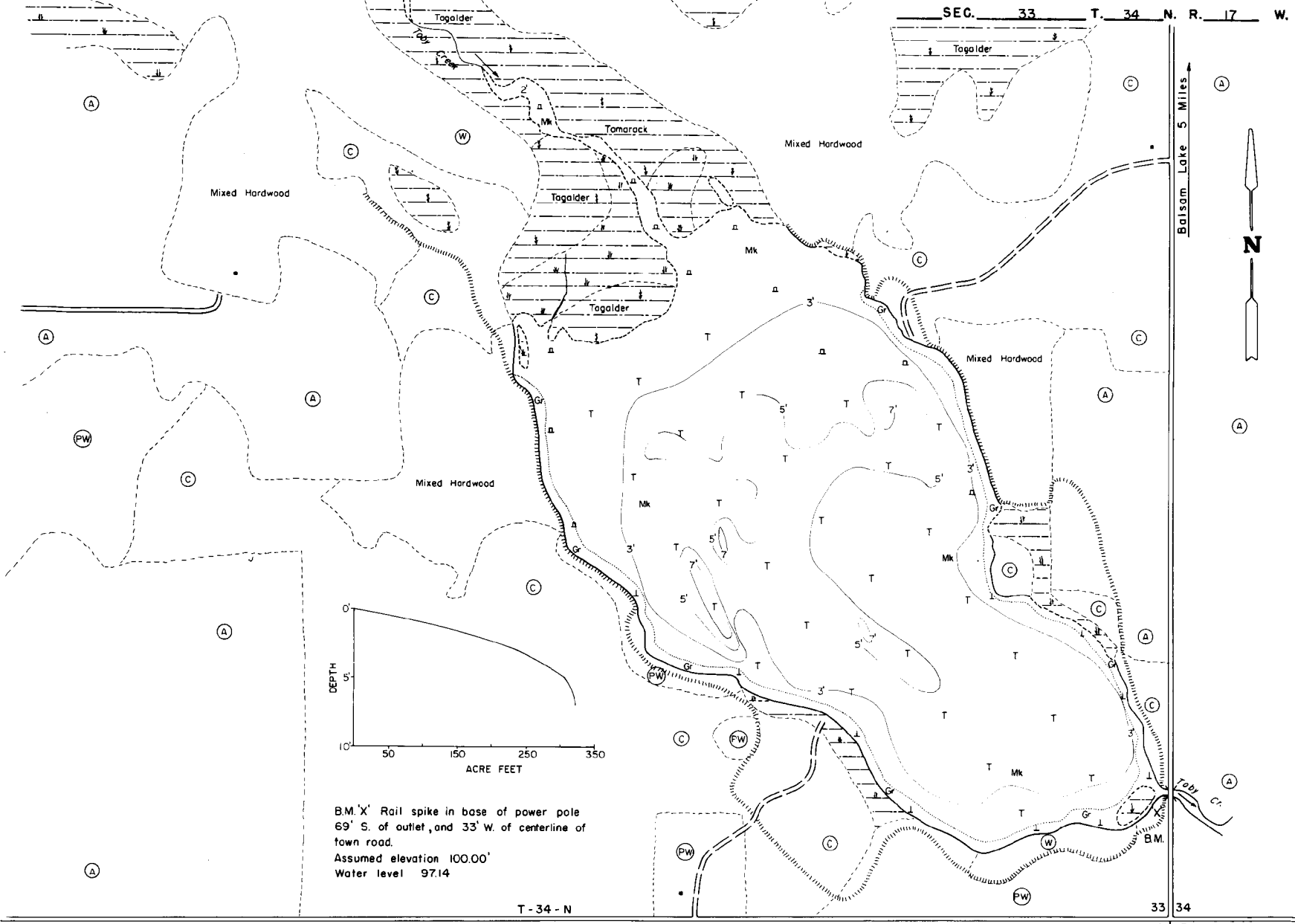

B.M. 'X' Rail spike in base of power pole  
69' S. of outlet, and 33' W. of centerline of  
town road.  
Assumed elevation 100.00'  
Water level 97.14

T-34 - N  
T-33 - N

EQUIPMENT RECORDING SONAR MAPPED MAY 1971

- | TOPOGRAPHIC SYMBOLS   |                           | LAKE BOTTOM SYMBOLS |                             |
|-----------------------|---------------------------|---------------------|-----------------------------|
| (B) Brush             | (     ) Steep slope       | P. Peat             | B Boulders                  |
| (PW) Partially wooded | - Indefinite shoreline    | Mk. Muck            | * Stumps & Snags            |
| (W) Wooded            | (     ) Marsh             | C. Clay             | ⚠ Rock danger to navigation |
| (C) Cleared           | (o) Spring                | M. Marl             | T Submergent vegetation     |
| (P) Pastured          | (---) Intermittent stream | Sd. Sand            | ⌊ Emergent vegetation       |
| (A) Agricultural      | (=) Permanent inlet       | St. Silt            | ⌋ Floating vegetation       |
| B.M. Bench Mark       | (=) Permanent outlet      | G. Gravel           | ⌋ Brush shelters            |
| ■ Dwelling            | ( ) Dam                   | R. Rubble           |                             |

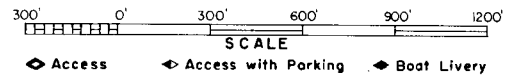

SPECIES OF FISH	Abundance	
	PRESENT	PREVIOUS
Muskie		X
N. Pike	X	
Walleye	X	
L. M. Bass	X	
S. M. Bass	X	
Panfish	X	

WATER AREA 95.4 ACRES  
UNDER 3 FT. 36 %  
OVER 20 FT. 0 %  
MAX. DEPTH 7 FEET.  
TOTAL ALK. 88 P.P.M.  
VOLUME 322 ACRE FT.  
SHORELINE 2.35 MILES