

STATE OF WISCONSIN
DEPARTMENT OF NATURAL RESOURCES

LAKE SURVEY MAP

BRUCE LAKE
RUSK COUNTY
SEC. 7 T. -34- N. R. -7- E.W.

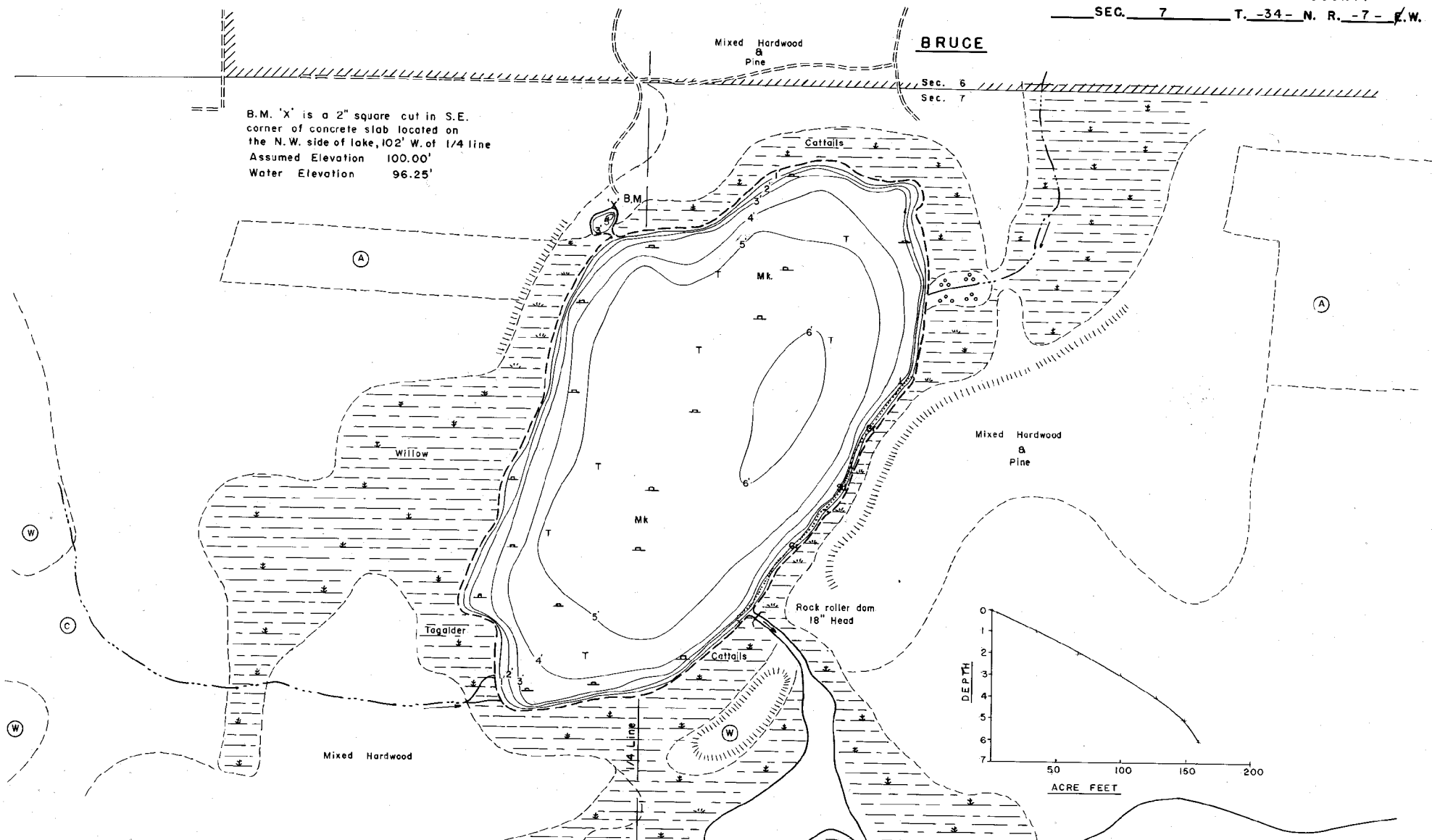

B.M. 'X' is a 2" square cut in S.E. corner of concrete slab located on the N.W. side of lake, 102' W. of 1/4 line
Assumed Elevation 100.00'
Water Elevation 96.25'

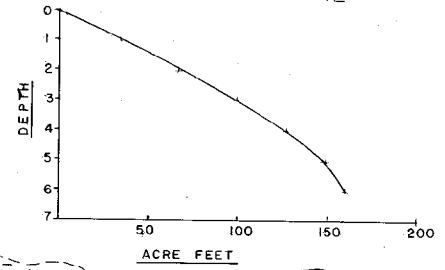

EQUIPMENT RECORDING SONAR MAPPED JUNE 1978

TOPOGRAPHIC SYMBOLS		LAKE BOTTOM SYMBOLS	
MONTH YEAR		MONTH YEAR	
(B) Brush	Steep slope	P. Peat	B Boulders
(PW) Partially wooded	~ Indefinite shoreline	Mk. Muck	* Stumps & Snags
(W) Wooded	~ Marsh	C. Clay	⚡ Rock danger to navigation
(C) Cleared	~ Spring	M. Marl	T Submergent vegetation
(P) Pastured	~ Intermittent stream	Sd. Sand	1 Emergent vegetation
(A) Agricultural	~ Permanent inlet	Sl. Silt	~ Floating vegetation
B.M. Bench Mark	~ Permanent outlet	Gr. Gravel	~ Brush shelters
■ Dwelling	~ Dam	R. Rubble	
■ Resort	D.N.R. State owned land	Bc. Bedrock	
■ Camp			



Access Access with Parking Boat Livery
Drawn by: E. Eaton
Field work by: C. Busch, K. Cable, J. Sather

SPECIES OF FISH	Abundance		
	Abundant	Common	Present
Muskie			X
N. Pike			X
Walleye			X
L. M. Bass			X
S. M. Bass			X
Panfish			X
Trout			X

WATER AREA 34.8 ACRES
UNDER 3 FT. 12 %
OVER 20 FT. 0 %
MAX. DEPTH 6 FEET
TOTAL ALK. 68 P.P.M.
VOLUME 16.3 ACRE FT.
MAIN SHORELINE 99 MI.
ISLAND SHORELINE MI.