

WISCONSIN CONSERVATION DEPARTMENT

LAKE SURVEY MAP

BUGLE LAKE
TREMPEALEAU COUNTY
SEC. 23,24,25 T. -22- N. R. -9- W.

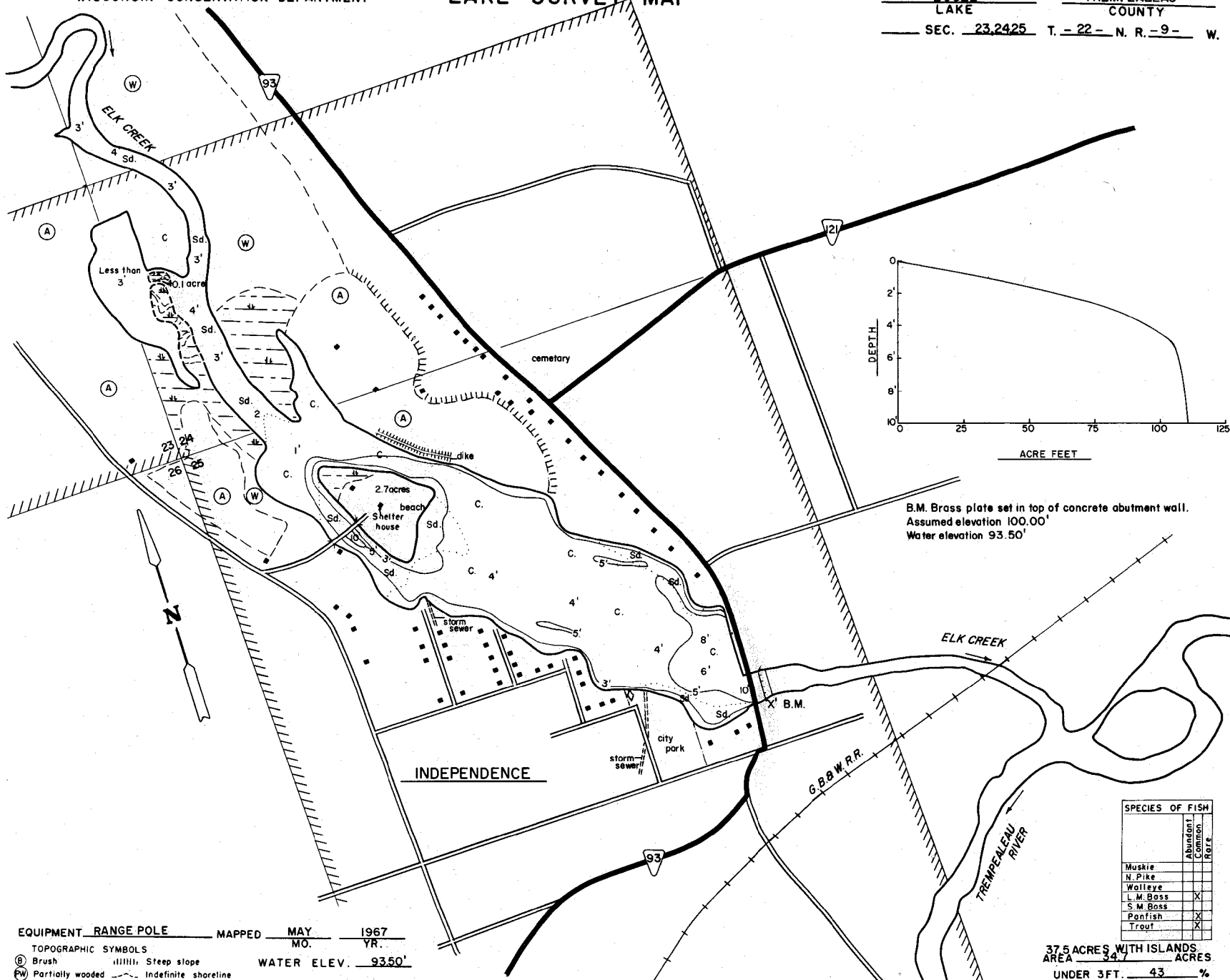

B.M. Brass plate set in top of concrete abutment wall.
Assumed elevation 100.00'
Water elevation 93.50'

EQUIPMENT RANGE POLE MAPPED MAY 1967
MO. YR.

- TOPOGRAPHIC SYMBOLS**
- (B) Brush
 - (PW) Partially wooded
 - (W) Wooded
 - (C) Cleared
 - (P) Pastured
 - (A) Agricultural
 - B.M. Bench Mark
 - Dwelling

- LAKE BOTTOM SYMBOLS**
- P. Peat
 - Mk. Muck
 - C. Clay
 - M. Marl
 - Sd. Sand
 - Gr. Gravel
 - R. Rubble
 - Br. Bedrock
 - T. Submergent vegetation
 - ↓ Emergent vegetation
 - ⊕ Stumps & Snags

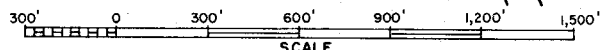

- ◇ Access
- ◀ Access with Parking
- ◆ Boat Livery

SPECIES OF FISH		
	Abundant	Rare
Muskie		
N. Pike		
Walleye		
L. M. Bass	X	
S. M. Bass	X	
Panfish	X	
Trout	X	

37.5 ACRES WITH ISLANDS
AREA 34.7 ACRES
UNDER 3FT. 43 %
OVER 20FT. 0 %
VOLUME 110.8 ACRE FT.
TOTAL ALK. 89 P.P.M.
SHORELINE 2.3 MILES
MAX DEPTH 10 FEET