

STATE OF WISCONSIN
DEPARTMENT OF NATURAL RESOURCES

LAKE SURVEY MAP

BURLINGAME LAKE BURNETT COUNTY
SEC. 19, 30 T. 41 N. R. 15 W.

Robie Lake
31.3 Acres
14' Deep

B.M. 'X' D.N.R. 1377-A Bronze cap set in concrete post 56' N.W. of water, 43' N. of centerline of road and 102' N.W. of bridge between Robie & Burlingame Lakes
Assumed elevation 100.00'
Water level 90.10' - AUG. 2, 1972
89.88' MAY 24, 1971

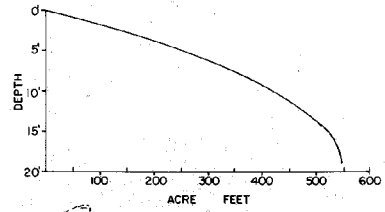
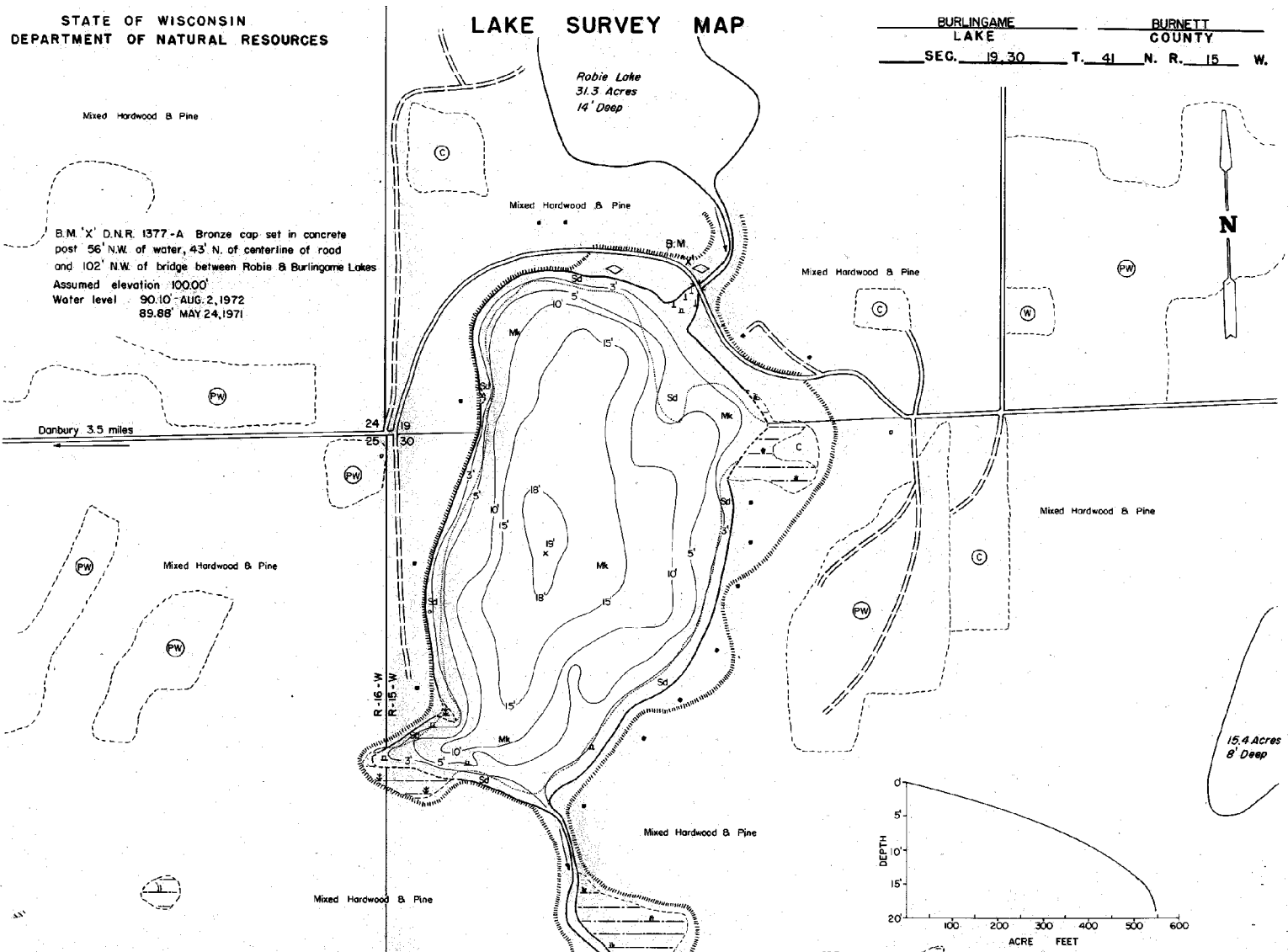

EQUIPMENT RECORDING SONAR MAPPED MAY 1971

- TOPOGRAPHIC SYMBOLS**
- (B) Brush
 - (PW) Partially wooded
 - (W) Wooded
 - (C) Cleared
 - (P) Pastured
 - (A) Agricultural
 - B.M. Bench Mark
 - (D) Dwelling
 - (R) Resort
 - (O) Camp

- LAKE BOTTOM SYMBOLS**
- P. Peat
 - Mk Muck
 - C. Clay
 - M. Marl
 - Sd. Sand
 - St. Silt
 - Gr. Gravel
 - R. Rubble
 - Bc. Bedrock

- LAKE BOTTOM SYMBOLS**
- B Boulders
 - Stumps & Snags
 - Rock danger to navigation
 - T Submergent vegetation
 - I Emergent vegetation
 - Floating vegetation
 - Brush shelters

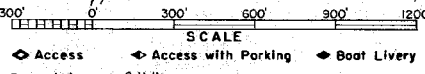

SPECIES OF FISH	Abundance	
	Common	Present
Muskie		
N. Pike	X	
Walleye		
L. M. Bass	X	
S. M. Bass		
Panfish	X	
Trout		

WATER AREA 570 ACRES
 UNDER 3 FT. 13 %
 OVER 20 FT. 0 %
 MAX. DEPTH 19 FEET
 TOTAL ALK. 43 P.P.M.
 VOLUME 547 ACRE FT.
 SHORELINE 1.39 MILES

Maps are not for navigation
 Source-Wisconsin Department of Natural Resources
 Hunt Fish Camp Wisconsin .Com 2005