

STATE OF WISCONSIN  
DEPARTMENT OF NATURAL RESOURCES

LAKE SURVEY MAP

CALEY LAKE  
RUSK COUNTY  
SEC. 29 T. 34 N. R. 7 W.

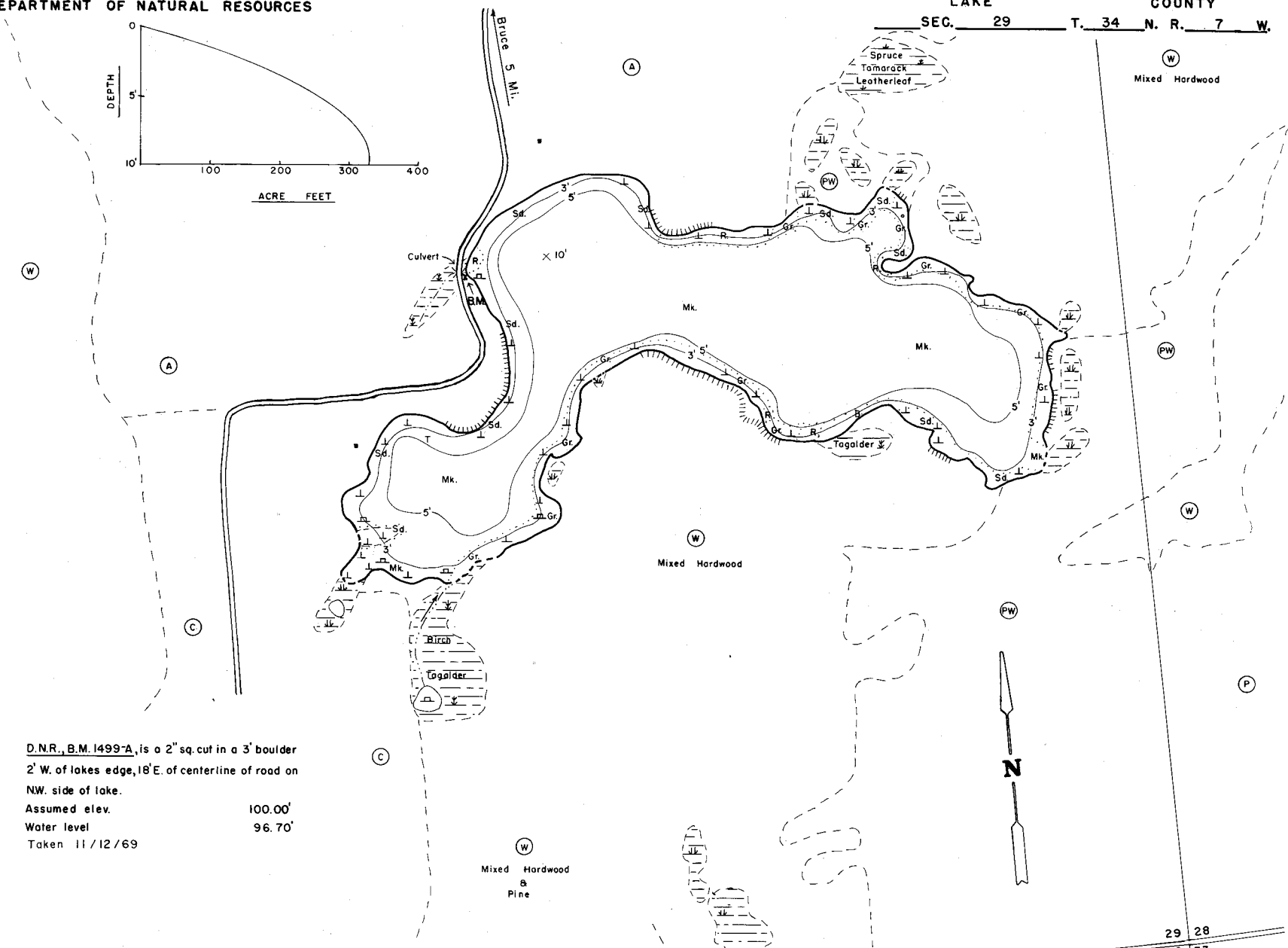
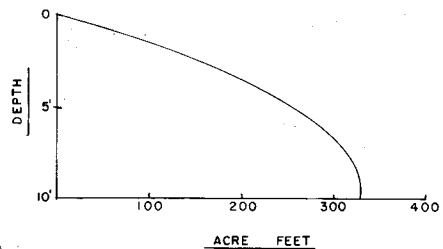

D.N.R., B.M. 1499-A, is a 2" sq. cut in a 3' boulder  
2' W. of lakes edge, 18' E. of centerline of road on  
NW. side of lake.

Assumed elev. 100.00'  
Water level 96.70'  
Taken 11/12/69

EQUIPMENT RECORDING SONAR MAPPED NOV. 1969  
MONTH YEAR

- TOPOGRAPHIC SYMBOLS
- (B) Brush
  - (PW) Partially wooded
  - (W) Wooded
  - (C) Cleared
  - (P) Pastured
  - (A) Agricultural
  - B.M. Bench Mark
  - Dwelling

- LAKE BOTTOM SYMBOLS
- P. Peat
  - Mk. Muck
  - C. Clay
  - M. Marl
  - Sd. Sand
  - St. Silt
  - Gr. Gravel
  - R. Rubble

- LAKE BOTTOM SYMBOLS (continued)
- B Boulders
  - Stumps & Snags
  - Rock danger to navigation
  - T Submergent vegetation
  - ↓ Emergent vegetation
  - ∩ Floating vegetation
  - ∩ Brush shelters
- Access Access with Parking Boat Livery



SPECIES OF FISH	Abundance		
	Common	Present	
Winterkill			
Muskie			
N. Pike			
Walleye			
L.M. Bass			X
S.M. Bass			
Panfish			X

WATER AREA 54.8 ACRES  
UNDER 3 FT. 18 %  
OVER 20 FT. 0 %  
MAX. DEPTH 10 FEET.  
TOTAL ALK. 8 P.P.M.  
VOLUME 327.7 ACRE FT.  
SHORELINE 1.97 MILES

29 28  
32 33