

STATE OF WISCONSIN
DEPARTMENT OF NATURAL RESOURCES

LAKE SURVEY MAP

CAMELIA
LAKE

POLK
COUNTY

SEC. 23,24

T. -33 - N. R. -15 - W.

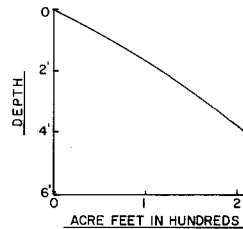
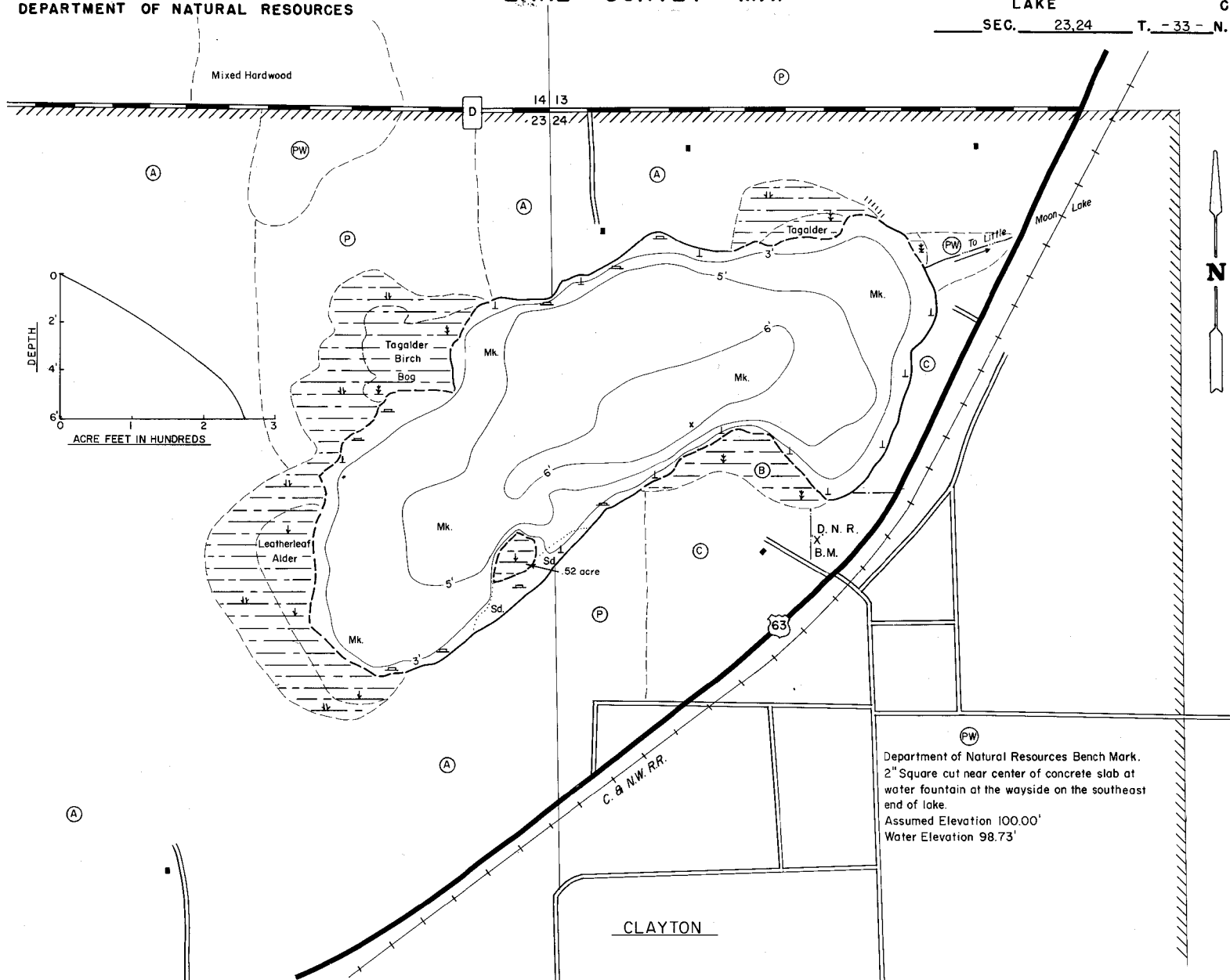

Department of Natural Resources Bench Mark.
2" Square cut near center of concrete slab at
water fountain at the wayside on the southeast
end of lake.
Assumed Elevation 100.00'
Water Elevation 98.73'

EQUIPMENT RECORDING SONAR MAPPED OCTOBER 1968

- | TOPOGRAPHIC SYMBOLS | | LAKE BOTTOM SYMBOLS | |
|-----------------------|----------------------------|---------------------|---------------------------|
| (B) Brush | Steep slope | P. Peat | B Boulders |
| (PW) Partially wooded | - - - Indefinite shoreline | Mk. Muck | o Stumps & Snags |
| (W) Wooded | Marsh | C. Clay | Rock danger to navigation |
| (C) Cleared | Spring | M. Marl | T Submergent vegetation |
| (P) Pastured | Intermittent stream | Sd. Sand | l Emergent vegetation |
| (A) Agricultural | Permanent inlet | St. Silt | Fl. Floating vegetation |
| B.M. Bench Mark | Permanent outlet | Gr. Gravel | Brush shelters |
| ■ Dwelling | Dam | R. Rubble | |



◆ Access ◆ Access with Parking ◆ Boat Livery
Drawn by J. Rath

SPECIES OF FISH	Abundance		
	Abundant	Common	Present
Muskie			
N. Pike			
Walleye			
L. M. Bass			X
S. M. Bass			X
Panfish			X

WATER AREA 596 ACRES
 UNDER 3 FT. 17 %
 OVER 20 FT. 0 %
 MAX. DEPTH 6 FEET.
 TOTAL ALK. 14 P.P.M.
 VOLUME 257.5 ACRE FT.
 SHORELINE 1.58 MILES