

STATE OF WISCONSIN  
DEPARTMENT OF NATURAL RESOURCES

LAKE SURVEY MAP

CAMP LAKE VILAS COUNTY  
SEC. 27.34 T. 41 N. R. 6 E.

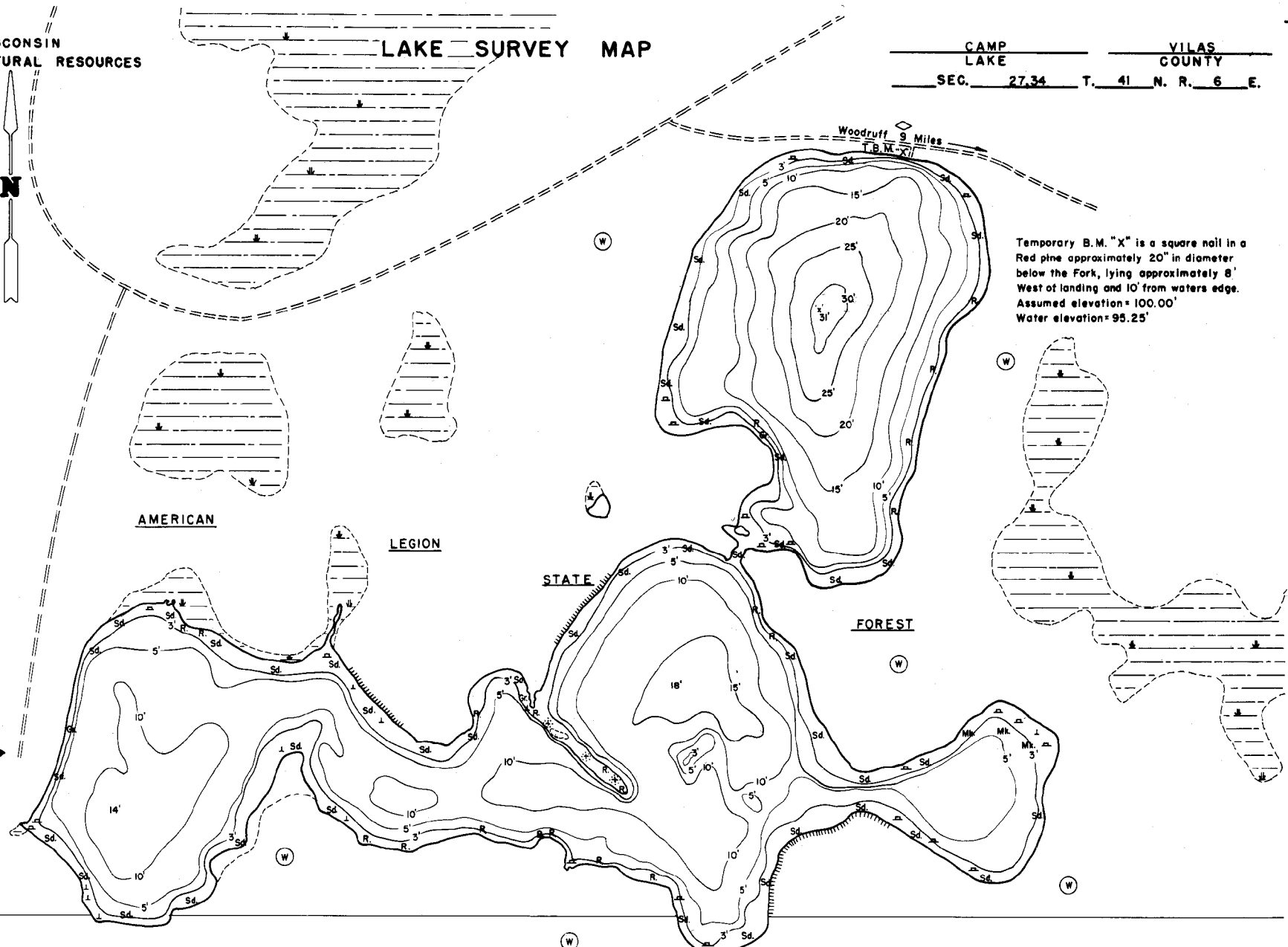

Temporary B.M. "X" is a square nail in a Red pine approximately 20" in diameter below the Fork, lying approximately 8' West of landing and 10' from waters edge. Assumed elevation = 100.00' Water elevation = 95.25'

28 27  
33 34

EQUIPMENT RECORDING SONAR MAPPED JULY 1975

TOPOGRAPHIC SYMBOLS		LAKE BOTTOM SYMBOLS	
		MONTH	YEAR
(B) Brush	Steep slope	P. Peat	B Boulders
(PW) Partially wooded	----- Indefinite shoreline	Mk. Muck	⚡ Stumps & Snags
(W) Wooded	Marsh	C. Clay	⚡ Rock danger to navigation
(C) Cleared	Spring	M. Marl	T Submergent vegetation
(P) Pastured	Intermittent stream	Sd. Sand	⚡ Emergent vegetation
(A) Agricultural	Permanent inlet	St. Silt	⚡ Floating vegetation
B.M. Bench Mark	Permanent outlet	Gr. Gravel	⚡ Brush shelters
(D) Dwelling	Dam	R. Rubble	
(R) Resort	D.N.R. State owned land	Rc. Redrock	



Access Access with Parking Boat Livery

SPECIES OF FISH	Abundant		Common		Present	
	X		X		X	
Muskie						
N. Pike						
Walleye						
L.M. Bass						
S.M. Bass						
Panfish	X					

WATER AREA 59.35 ACRES  
 UNDER 3 FT. 15.65 %  
 OVER 20 FT. 6.67 %  
 MAX. DEPTH 31 FEET.  
 TOTAL ALK. P.P.M.  
 VOLUME 544.94 ACRE FT.  
 MAIN SHORELINE 2.58 MI