

WISCONSIN CONSERVATION DEPARTMENT

LAKE SURVEY MAP

CARY POND
LAKE

WAUPACA
COUNTY

SEC. 29,32

T. 22 N. R. 12 E.

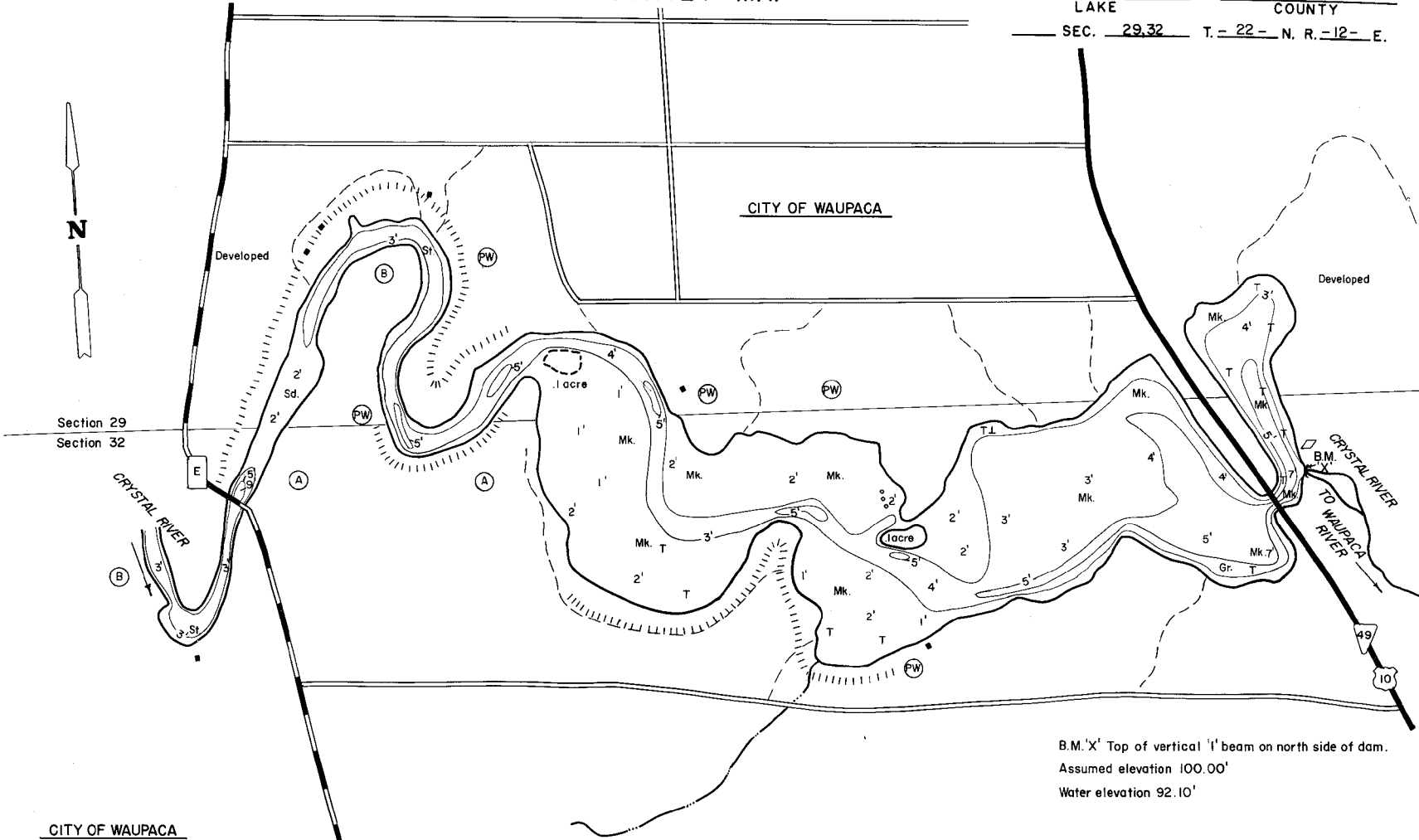

B.M. 'X' Top of vertical 'I' beam on north side of dam.
Assumed elevation 100.00'
Water elevation 92.10'

CITY OF WAUPACA

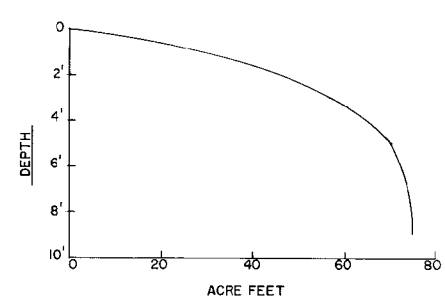

SPECIES OF FISH	Abundance	
	Common	Rare
Muskie		
N. Pike	X	
Walleye		
L.M. Bass	X	
S.M. Bass		X
Panfish	X	
Trout		

26.6 ACRES WITH ISLANDS
AREA 26.4 ACRES
UNDER 3 FT. 44 %
OVER 20 FT. 0.0 %
VOLUME 75.2 ACRE FT.
TOTAL ALK. 163 P.P.M.
SHORELINE 2.6 MILES

EQUIPMENT RECORDING SONAR MAPPED APRIL 1966
MO. YR.

- WATER ELEV. 92.10'
- TOPOGRAPHIC SYMBOLS**
- (B) Brush
 - (PW) Partly wooded
 - (W) Wooded
 - (C) Cleared
 - (P) Pastured
 - (A) Agricultural
 - B.M. Bench Mark
 - Dwelling
- LAKE BOTTOM SYMBOLS**
- P. Peat
 - Mk. Muck
 - C. Clay
 - M. Marl
 - Sd. Sand
 - Gr. Gravel
 - R. Rubble
 - Br. Bedrock
 - T. Submergent vegetation
 - Emergent vegetation
- Other Symbols:**
- Steep slope
 - Indefinite shoreline
 - Marsh
 - Spring
 - Intermittent stream
 - Permanent inlet
 - Permanent outlet
 - Dam
 - Stumps & Snags

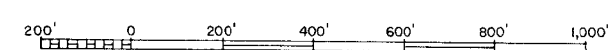

- ◇ Access
- ◀ Access with Parking
- ◆ Boat Livery