

STATE OF WISCONSIN
DEPARTMENT OF NATURAL RESOURCES

LAKE SURVEY MAP

LAKE CHIPPEWA
LAKE

SAWYER
COUNTY

SEC AS SHOWN

T. 39. 40 N. R. 6. 7. 8 W.

sheet 9 of 12

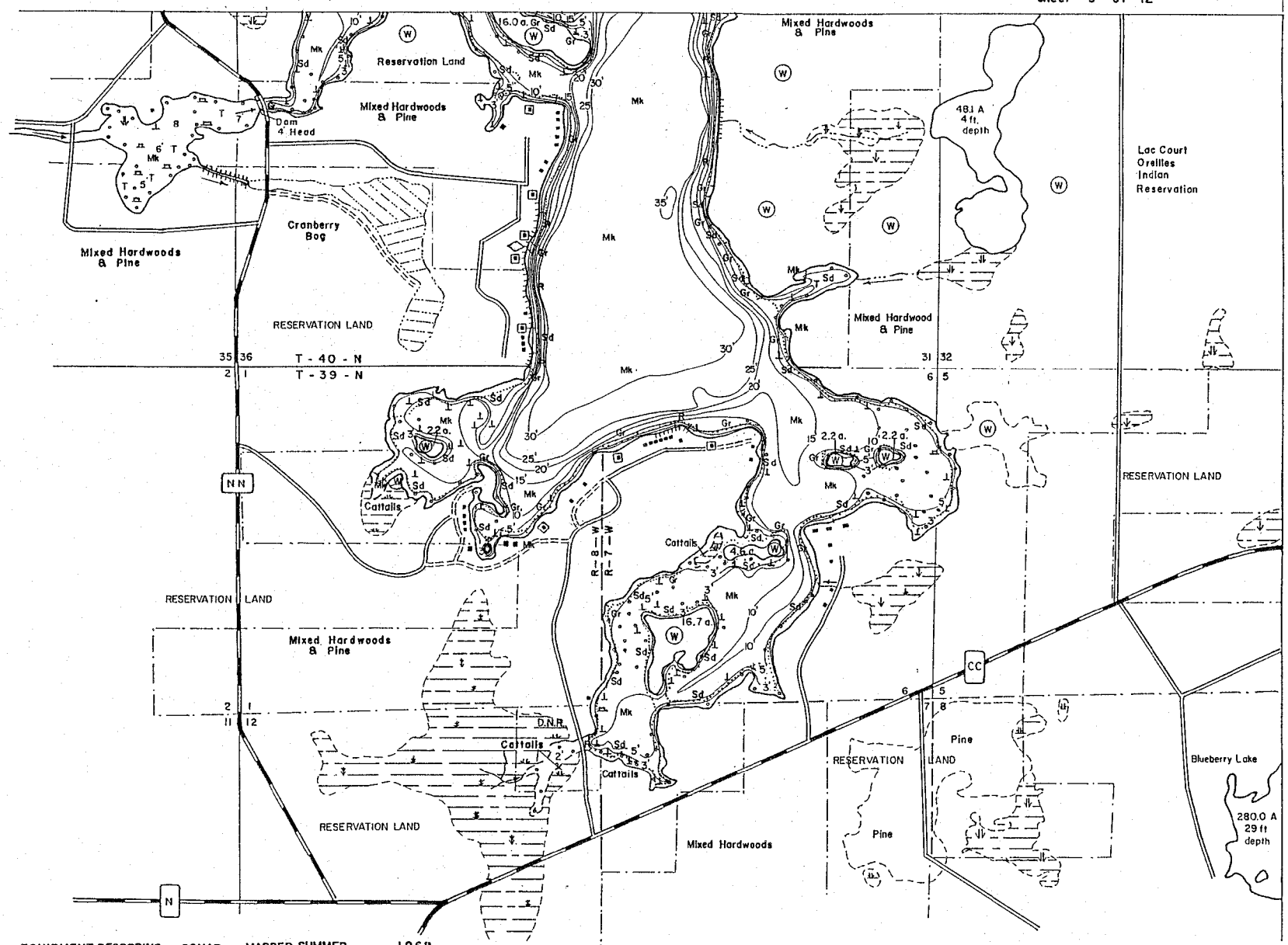

EQUIPMENT RECORDING SONAR MAPPED SUMMER 1968

TOPOGRAPHIC SYMBOLS

- | | | | | | | | | | | | | | | | | | | | | | | | | | |
|-------------|----------------------------|-----------|-------------|---------------------|------------------|------------------|------------|---------|----------|---------|---------|----------|----------|------------|-----------|------------|------------------|-----------------------------|-------------------------|-----------------------|-----------------------|------------------|----------|-----------------------|---------------|
| (B) Brush | (W) Partially wooded | (M) Marsh | (C) Cleared | (P) Pastured | (A) Agricultural | B.M. Bench Mark | ■ Dwelling | P. Peat | Mk. Muck | C. Clay | M. Marl | Sd. Sand | Sl. Silt | Gr. Gravel | R. Rubble | B Boulders | ⊙ Slumps & Snags | ⊙ Rock danger to navigation | T Submergent vegetation | ⊥ Emergent vegetation | ⊥ Floating vegetation | ⊥ Brush shelters | ◊ Access | ◊ Access with Parking | ◊ Boat Livery |
| Sleep slope | - - - Indefinite shoreline | ⊙ Marsh | Spring | Intermittent stream | Permanent inlet | Permanent outlet | Dam | | | | | | | | | | | | | | | | | | |

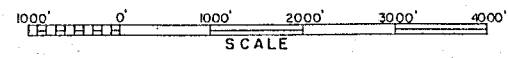

Drawn by Bureau of Engineering

SPECIES OF FISH	ABUNDANCE		
	Abundant	Common	Present
Muskie	X		
N. Pike	X		
Walleye	X		
L.M. Bass	X		
S.M. Bass	X		
Panfish	X		
Trout	X		

17,432 ACRES INCLUDING ISLANDS
WATER AREA 15,300 ACRES
UNDER 3 FT. 16 %
OVER 20 FT. 24 %
MAX. DEPTH 92 FEET.
TOTAL ALK. 19 P.P.M.
VOLUME 224,998 ACRE FT.
SHORELINE 232.92 MILES