

Hunt Fish Camp Wisconsin

WISCONSIN CONSERVATION DEPARTMENT

LAKE SURVEY MAP

LAKE CLAY LAKE
 SECTION 8
 TOWNSHIP 45 N
 RANGE 7 W
 TOWN _____
 COUNTY BAYFIELD

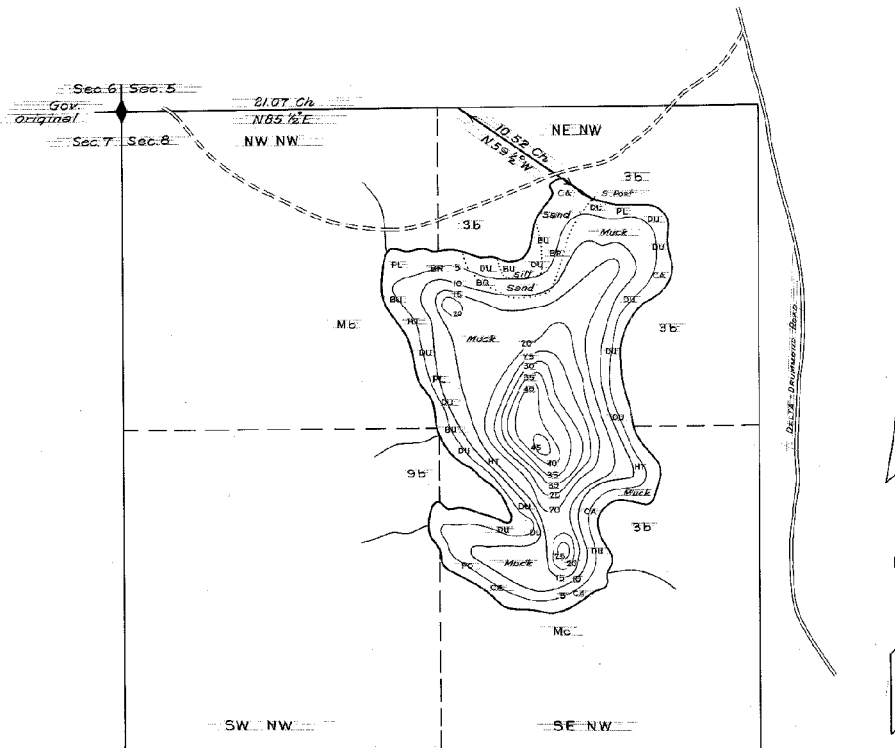

DATE 1937
 SOURCE OF INFORMATION _____
U.S. Department of Agriculture
Forest Service
 SOUNDINGS 5' Intervals

AREA 27.10 Acres
 TOTAL SHORELINE 1.10 Miles
 MAX. DEPTH 45 Feet
 SCALE: 16" = 1 Mile

Maps are not for navigation
 Source-Wisconsin Department of Natural Resources
 Hunt Fish Camp Wisconsin .Com 2005