

STATE OF WISCONSIN
DEPARTMENT OF NATURAL RESOURCES

LAKE SURVEY MAP

CLEAR LAKE ONEIDA COUNTY
SEC. 9, 10, 15, 16, 17, 21 T. 39 N. R. 7 E.
SHEET 2 OF 3

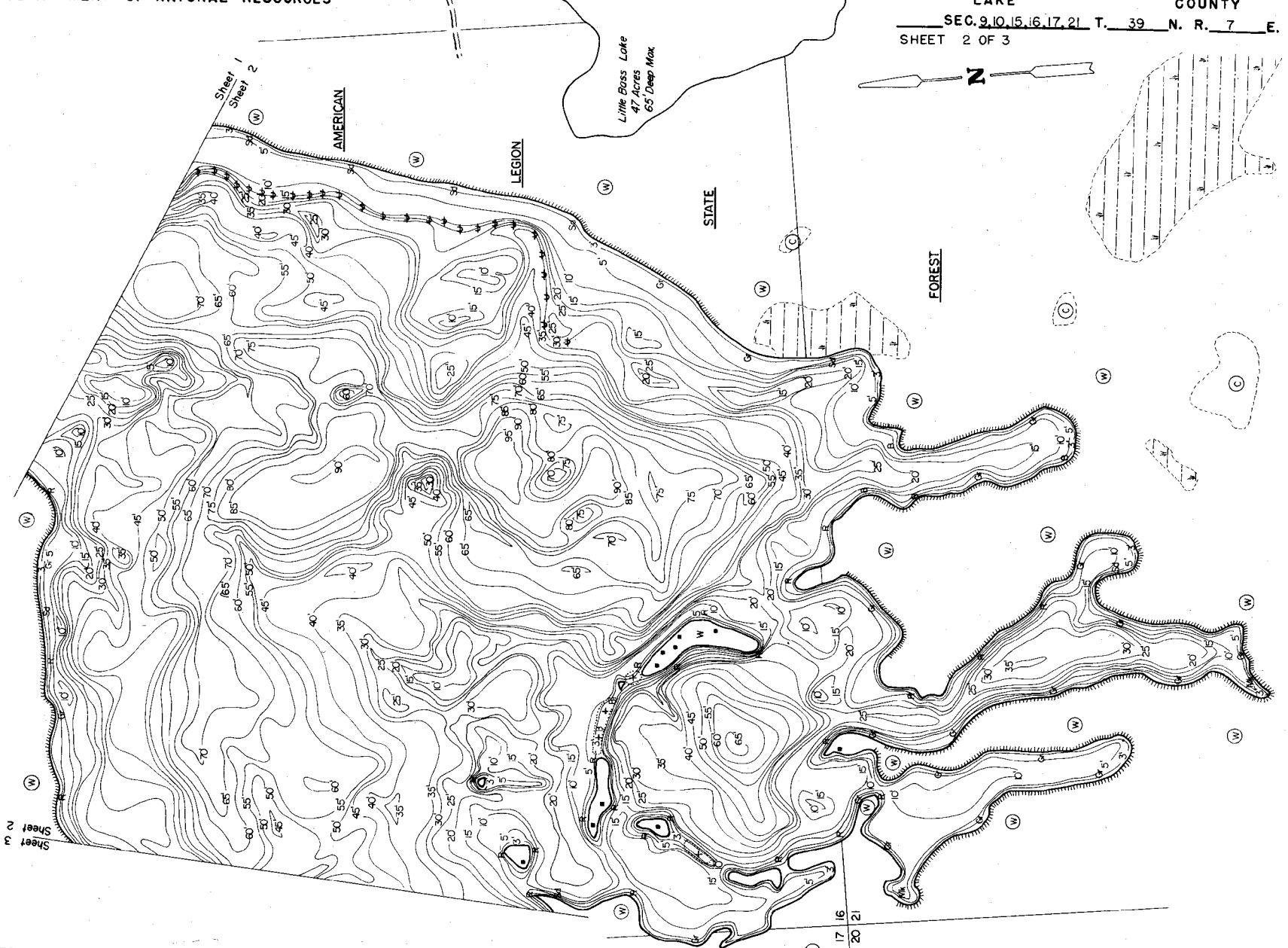

Little Bass Lake
47 Acres
65' Deep Max

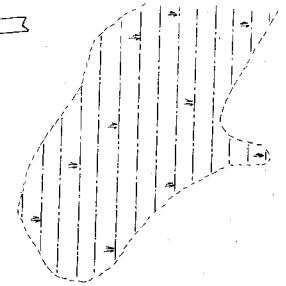
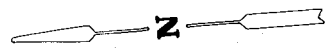

EQUIPMENT RECORDING SONAR MAPPED JULY 1973
TOPOGRAPHIC SYMBOLS MONTH YEAR
LAKE BOTTOM SYMBOLS

- | | | | |
|-----------------------|------------------------|------------|-----------------------------|
| (B) Brush | Steep slope | P. Peat | B Boulders |
| (PW) Partially wooded | ~ Indefinite shoreline | Mk. Muck | ☼ Stumps & Snags |
| (W) Wooded | ~ Marsh | C. Clay | ☼ Rock danger to navigation |
| (C) Cleared | ~ Spring | M. Marl | T Submergent vegetation |
| (P) Pastured | ~ Intermittent stream | Sd. Sand | 1 Emergent vegetation |
| (A) Agricultural | ~ Permanent inlet | Sl. Silt | ~ Floating vegetation |
| B.M. Bench Mark | ~ Permanent outlet | Gr. Gravel | ~ Brush shelters |
| ■ Dwelling | ~ Dam | R. Rubble | |



- ◆ Access ◆ Access with Parking ◆ Boat Livory

SPECIES OF FISH	MAPPED		
	Abundant	Common	Present
Muskie			X
N. Pike			X
Walleye		X	
L.M. Bass		X	
S.M. Bass	X	X	

WATER AREA 845.8 ACRES
 UNDER 3 FT. 3 %
 OVER 20 FT. 26 %
 MAX. DEPTH 95 FEET.
 TOTAL ALK. 10 P.P.M.
 VOLUME 26,206 ACRE FT.