

WISCONSIN CONSERVATION DEPARTMENT

LAKE SURVEY MAP

COON
LAKE

POLK
COUNTY

SEC. 27.34

T. 37 - N. R. 17 - W.

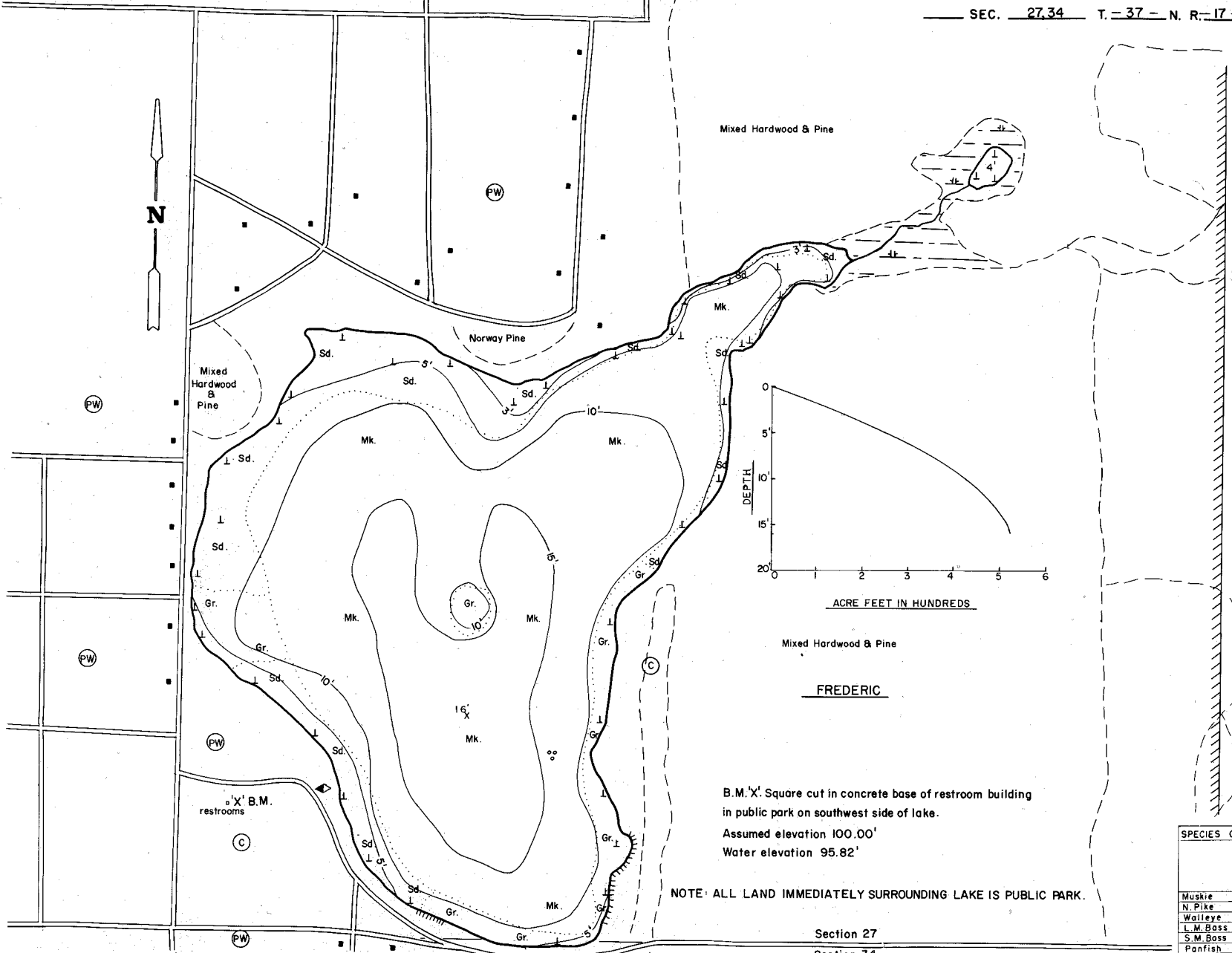
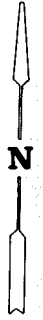

Mixed Hardwood & Pine

Norway Pine

Mixed
Hardwood
&
Pine

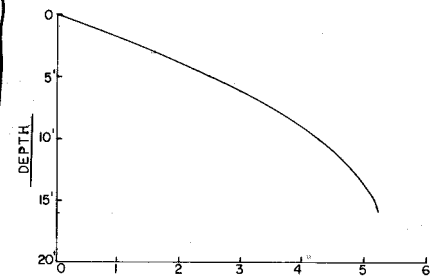

ACRE FEET IN HUNDREDS

Mixed Hardwood & Pine

FREDERIC

B.M. 'X' Square cut in concrete base of restroom building
in public park on southwest side of lake.

Assumed elevation 100.00'
Water elevation 95.82'

NOTE: ALL LAND IMMEDIATELY SURROUNDING LAKE IS PUBLIC PARK.

Section 27

Section 34

SPECIES OF FISH		Abundant	Common	Rare
Muskie				
N. Pike				X
Walleye				
L. M. Bass			X	
S. M. Bass				
Panfish		X		
Trout				

EQUIPMENT RECORDING SONAR MAPPED AUGUST 1967

TOPOGRAPHIC SYMBOLS MO. YR. WATER ELEV. 95.82'

- | | | | | |
|-----------------------|----------------------------|----------|--------------------------|----------------|
| (B) Brush | () Steep slope | P. Peat | Gr. Gravel | Stumps & Snags |
| (PW) Partially wooded | - - - Indefinite shoreline | Mk. Muck | R. Rubble | |
| (W) Wooded | () Marsh | C. Clay | Br. Bedrock | |
| (C) Cleared | (o) Spring | M. Marl | T. Submergent vegetation | |
| (P) Pastured | (---) Intermittent stream | | | |
| (A) Agricultural | (=) Permanent inlet | | | |
| B.M. Bench Mark | (=) Permanent outlet | | | |

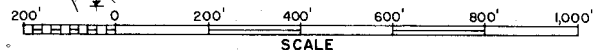

SCALE

AREA 53.8 ACRES
 UNDER 3 FT. 1.85 %
 OVER 20 FT. 0.0 %
 VOLUME 522 ACRE FT.
 TOTAL ALK. 25 P.P.M.
 SHORELINE 1.3 MILES