

STATE OF WISCONSIN
DEPARTMENT OF NATURAL RESOURCES

LAKE SURVEY MAP

COPPER LAKE LINCOLN COUNTY
SEC. 21, 22 T. 33 N. R. 7 E.

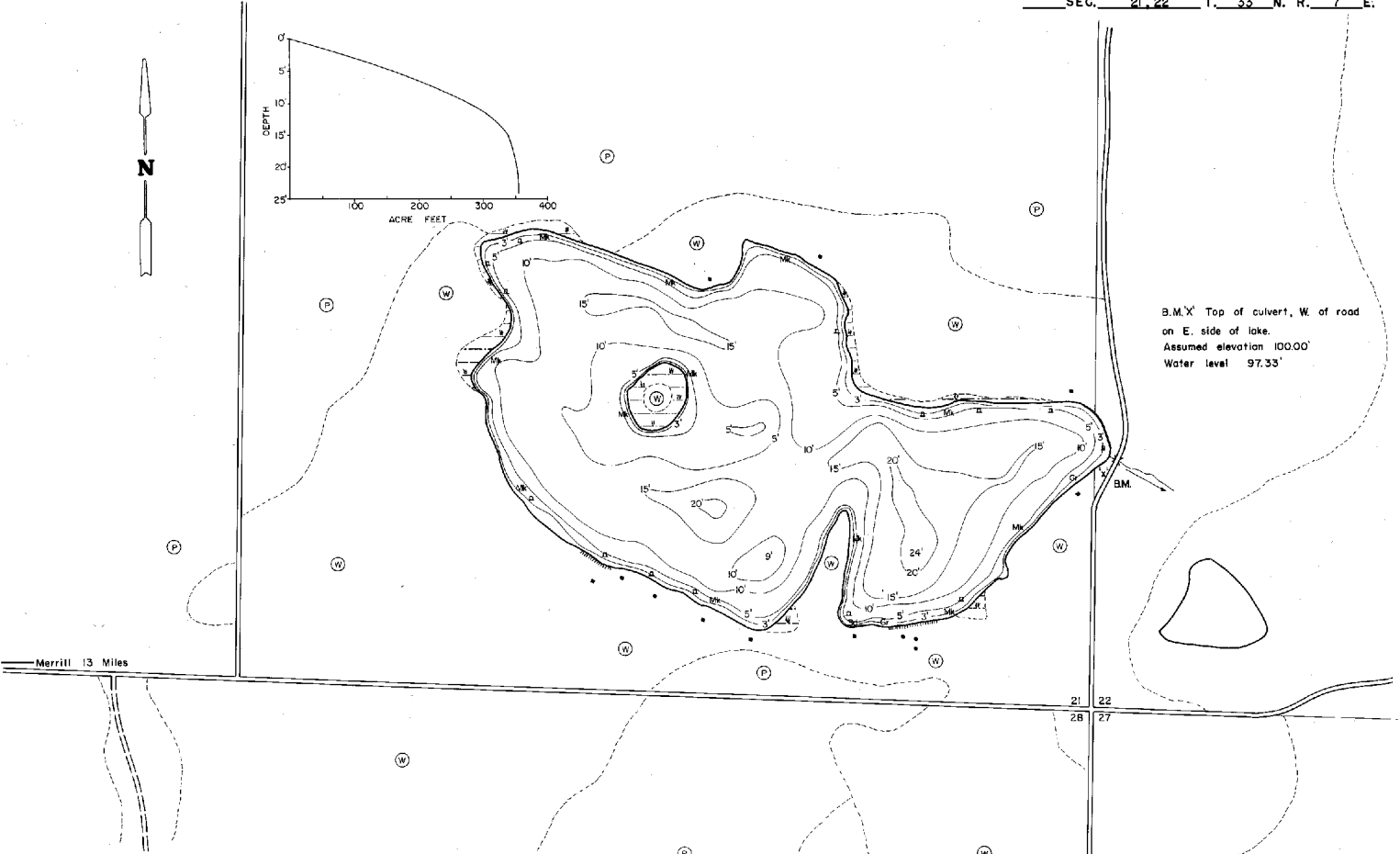

B.M. X Top of culvert, W. of road
on E. side of lake.
Assumed elevation 100.00'
Water level 97.35'

EQUIPMENT	RECORDING	SONAR	MAPPED	SEPT	1973
TOPOGRAPHIC SYMBOLS				MONTH	YEAR
(B)	Brush				
(W)	Partially wooded				
(C)	Cleared				
(A)	Agricultural				
(B.M.)	Bench Mark				
(D)	Dwelling				
(R)	Resort				
(C)	Camp				
(S)	Steep slope				
(I)	Indefinite shoreline				
(M)	Marsh				
(S)	Spring				
(IS)	Intermittent stream				
(PI)	Permanent inlet				
(PO)	Permanent outlet				
(D)	Dam				
(S.O.L.)	D.N.R. State owned land				
(P)	Peat				
(M)	Muck				
(C)	Clay				
(M)	Marl				
(S)	Sand				
(S)	Silt				
(G)	Gravel				
(R)	Rubble				
(B)	Bedrock				
(B)	Boulders				
(S)	Stumps & Snags				
(R)	Rock danger to navigation				
(S)	Submergent vegetation				
(E)	Emergent vegetation				
(F)	Floating vegetation				
(S)	Brush shelters				

SCALE
200' 0' 200' 400' 600' 800'
◆ Access ◆ Access with Parking ◆ Boat Livery
Drawn by: C. Hest
Field work by: J. Nicholas, J. Smith

SPECIES OF FISH	
Abundance	Percent
Muskie	
Y Pike	X
Walleye	
L. N. Bass	X
S. M. Bass	
Panfish	X
Trout	

WATER AREA 342 ACRES
UNDER 3 FT. 7 %
OVER 20 FT. 2 %
MAX. DEPTH 24 FEET
TOTAL ALK. 7 P.P.M.
VOLUME 353 ACRE FT.
MAIN SHORELINE 1.16 MI.
ISLAND SHORELINE 0.11 MI.

Maps are not for navigation
Source-Wisconsin Department of Natural Resources
Hunt Fish Camp Wisconsin .Com 2005