

STATE OF WISCONSIN
DEPARTMENT OF NATURAL RESOURCES

LAKE SURVEY MAP

Lower Eau Claire Lake
816.7 Acres
42 Ft. Deep

CRANBERRY LAKE
BAYFIELD COUNTY
SEC. 30 T. 44 N. R. 9 W.

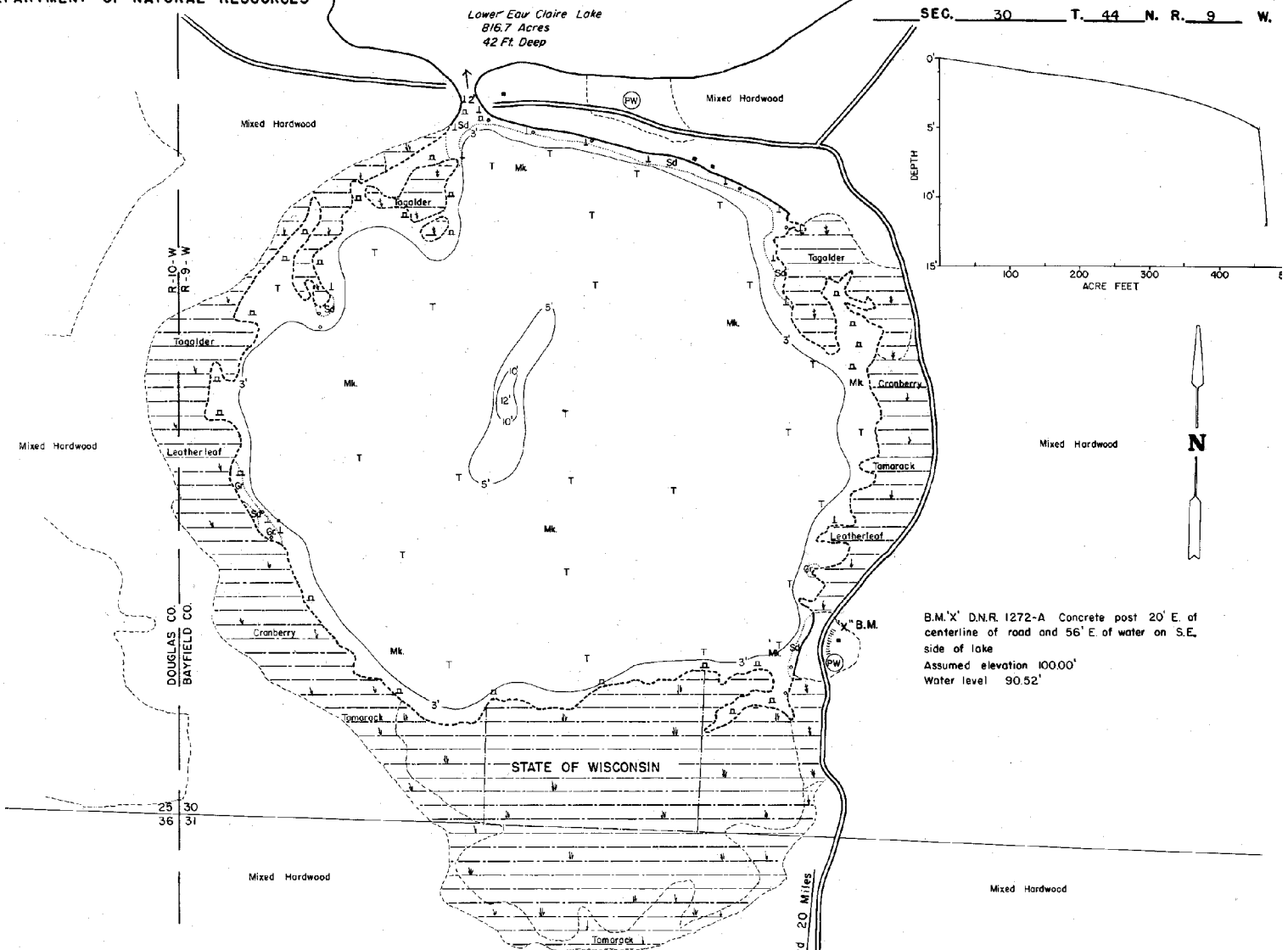

B.M.'X' D.N.R. 1272-A Concrete post 20' E. of centerline of road and 56' E. of water on S.E. side of lake
Assumed elevation 100.00'
Water level 90.52'

- EQUIPMENT RECORDING SONAR MAPPED JUNE 1970
- TOPOGRAPHIC SYMBOLS
- (B) Brush
 - (PW) Partly wooded
 - (W) Wooded
 - (C) Cleared
 - (P) Pastured
 - (A) Agricultural
 - B.M. Bench Mark
 - Dwelling
 - Resort
 - Camp
- NORTH LAKE BOTTOM SYMBOLS
- Sleep slope
 - Indefinite shoreline
 - Marsh
 - Spring
 - Intermittent stream
 - Permanent inlet
 - Permanent outlet
 - Dam
 - D.N.R. State owned land
- 1970 LAKE BOTTOM SYMBOLS
- P. Peat
 - Mk. Muck
 - C. Clay
 - M. Marl
 - Sd. Sand
 - Sl. Silt
 - Gr. Gravel
 - R. Rubble
 - Bc. Bedrock
 - B. Boulders
 - Stumps & Snags
 - Rock danger to navigation
 - Submergent vegetation
 - Emergent vegetation
 - Flooding vegetation
 - Brush shelters

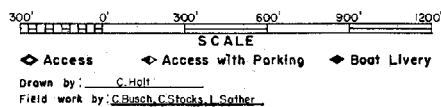

SPECIES OF FISH	ABUNDANCE		
	Abundant	Common	Present
Muskie			X
N. Pike			X
Walleye			X
L.M. Bass		X	
S.M. Bass		X	
Panfish		X	
Trout			

WATER AREA 130.6 ACRES
UNDER 3 FT. 20 %
OVER 20 FT. 0 %
MAX. DEPTH 12 FEET
TOTAL ALK. 51 P.P.M.
VOLUME 467.8 ACRE FT.
SHORELINE 3.23 MILES

Maps are not for navigation
Source-Wisconsin Department of Natural Resources
Hunt Fish Camp Wisconsin .Com 2005