

STATE OF WISCONSIN  
DEPARTMENT OF NATURAL RESOURCES

LAKE SURVEY MAP

CURRIER LAKE SAWYER COUNTY  
SEC. 11, 14 T. 41 N. R. 7 W.

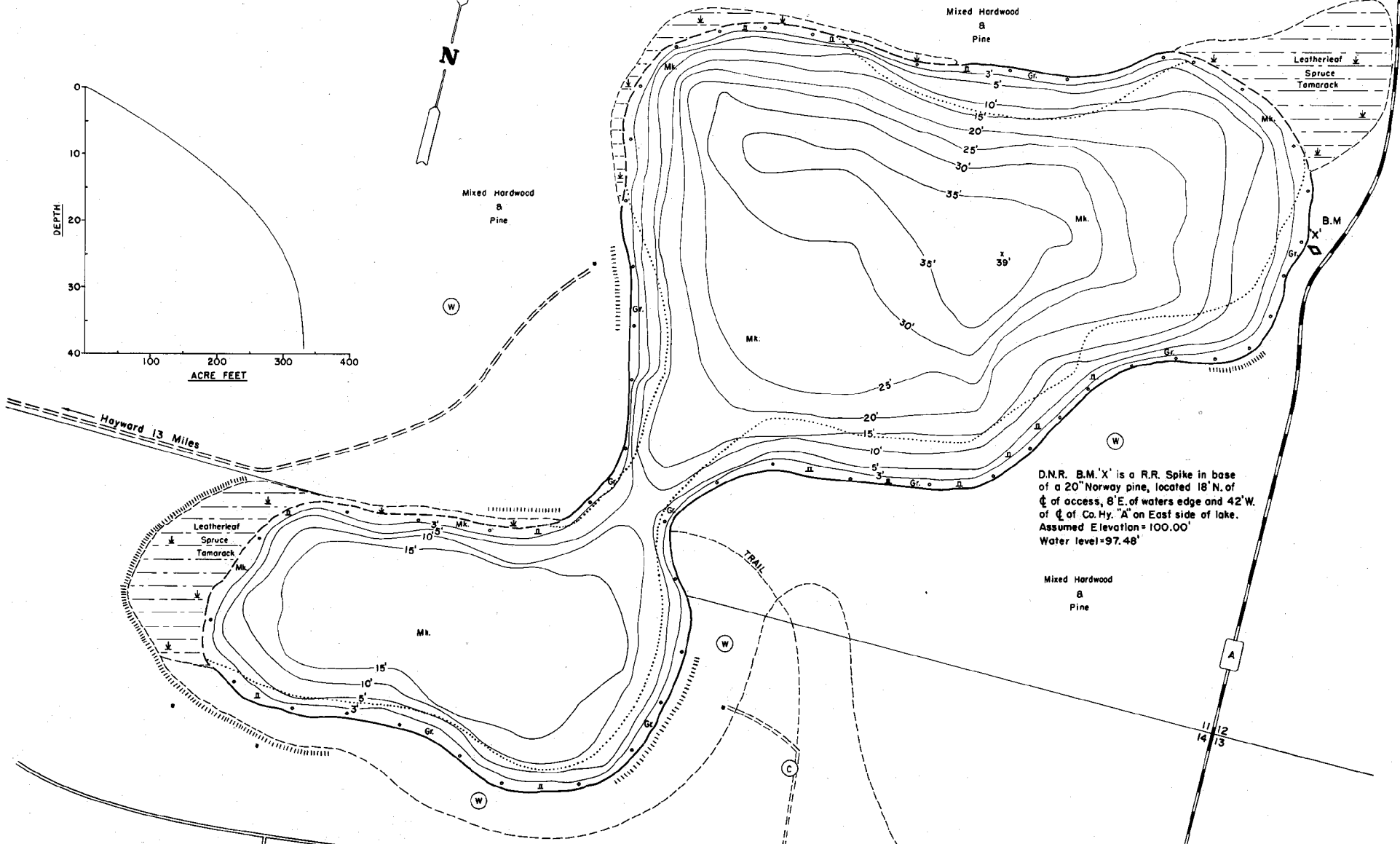
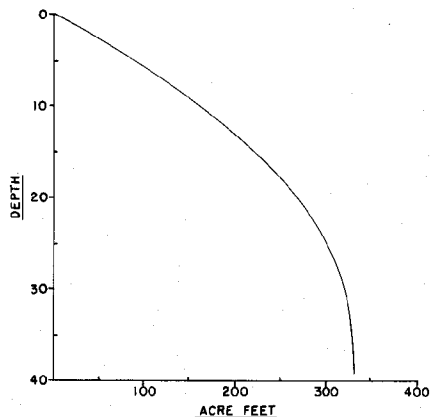

D.N.R. B.M. 'X' is a R.R. Spike in base of a 20" Norway pine, located 18' N. of  $\phi$  of access, 8' E. of waters edge and 42' W. of  $\phi$  of Co. Hy. 'A' on East side of lake. Assumed Elevation = 100.00' Water level = 97.48'

EQUIPMENT RECORDING SONAR MAPPED JUNE 1973  
MONTH LAKE BOTTOM YEAR

- |  |  |   |  |
|--|--|---|--|
| <p>TOPOGRAPHIC SYMBOLS</p> <ul style="list-style-type: none"> <li>(B) Brush</li> <li>(W) Partially wooded</li> <li>(C) Cleared</li> <li>(P) Pastured</li> <li>(A) Agricultural</li> <li>B.M. Bench Mark</li> <li>■ Dwelling</li> <li>□ Resort</li> <li>⊞ Camp</li> </ul> | <ul style="list-style-type: none"> <li>      Steep slope</li> <li>----- Indefinite shoreline</li> <li>Marsh</li> <li>Spring</li> <li>Intermittent stream</li> <li>Permanent inlet</li> <li>Permanent outlet</li> <li>Dam</li> <li>D.N.R. State owned land</li> </ul> | <ul style="list-style-type: none"> <li>P. Peat</li> <li>Mk. Muck</li> <li>C. Clay</li> <li>M. Marl</li> <li>Sd. Sand</li> <li>Sl. Silt</li> <li>Gr. Gravel</li> <li>R. Rubble</li> <li>Bc. Bedrock</li> </ul> | <ul style="list-style-type: none"> <li>B Boulders</li> <li>Mk. Stumps &amp; Snags</li> <li>Rock danger to navigation</li> <li>T Submergent vegetation</li> <li>I Emergent vegetation</li> <li>Floating vegetation</li> <li>Brush shelters</li> </ul> |
|--|--|---|--|



Access Access with Parking Boat Livery  
Drawn by: G. Thuesen  
Field work by: C. Busch, K. Coble, L. Saiter

| SPECIES OF FISH | Abundance |        |         |
|-----------------|-----------|--------|---------|
|                 | Abundant  | Common | Present |
| Muskie          |           |        |         |
| N. Pike         |           |        |         |
| Walleye         |           |        |         |
| L. N. Bass      | X         |        |         |
| S. M. Bass      | X         |        |         |
| Panfish         | X         |        |         |
| Trout           |           |        |         |

WATER AREA 18.86 ACRES  
UNDER 3 FT. 8 %  
OVER 20 FT. 36 %  
MAX. DEPTH 39 FEET.  
TOTAL ALK. 6 P.P.M.  
VOLUME 331.7 ACRE FT.  
MAIN SHORELINE .93 MI.  
ISLAND SHORELINE MI.