

STATE OF WISCONSIN
DEPARTMENT OF NATURAL RESOURCES

LAKE SURVEY MAP

DEAD PIKE LAKE
VILAS COUNTY
SEC. 20, 29 T. 42 N. R. 5 E.

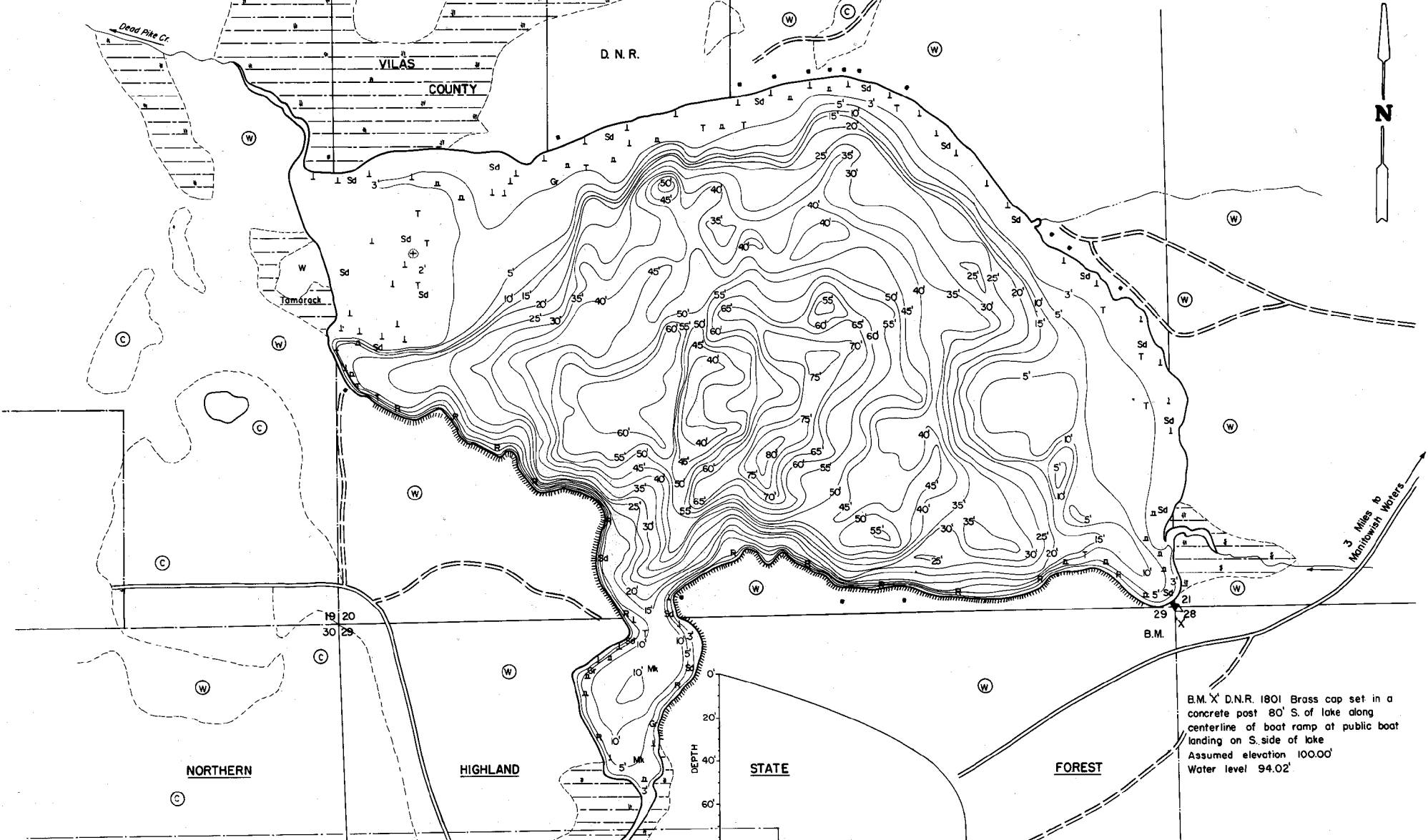

B.M. X D.N.R. 1801 Brass cap set in a concrete post 80' S. of lake along centerline of boat ramp at public boat landing on S. side of lake
Assumed elevation 100.00'
Water level 94.02'

EQUIPMENT RECORDING SONAR MAPPED JUNE 1973 MONTH YEAR

- TOPOGRAPHIC SYMBOLS**
- (B) Brush
 - (PW) Partially wooded
 - (W) Wooded
 - (C) Cleared
 - (P) Pastured
 - (A) Agricultural
 - B.M. Bench Mark
 - Dwelling
 - Resort
 - Camp
 - ||||| Steep slope
 - - - Indefinite shoreline
 - Marsh
 - Spring
 - Intermittent stream
 - Permanent inlet
 - Permanent outlet
 - Dam
 - D.N.R. State owned land
- LAKE BOTTOM SYMBOLS**
- P. Peat
 - Mk. Muck
 - C. Clay
 - M. Marl
 - Sd. Sand
 - St. Silt
 - Gr. Gravel
 - R. Rubble
 - Br. Bedrock
 - B Boulders
 - Stumps & Snags
 - Rock danger to navigation
 - T Submergent vegetation
 - E Emergent vegetation
 - F Floating vegetation
 - Brush shelters

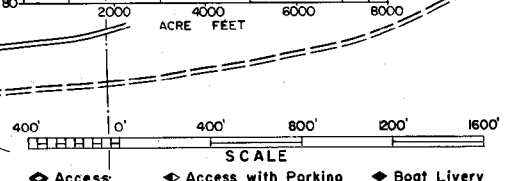

Drawn by: C. Holt
Field work by: J. Smith, B. Hertz

SPECIES OF FISH	Abundance		
	Abundant	Common	Present
Muskie			X
N. Pike	X	X	X
Walleye	X		
L. M. Bass	X		
S. M. Bass	X		
Panfish	X		
Trout			

WATER AREA 297.2 ACRES
UNDER 3 FT. 19 %
OVER 20 FT. 53 %
MAX. DEPTH 80 FEET
TOTAL ALK. 30 P.P.M.
VOLUME 7580 ACRE FT.
MAIN SHORELINE 3.84 MI.
ISLAND SHORELINE MI.