

STATE OF WISCONSIN  
DEPARTMENT OF NATURAL RESOURCES

LAKE SURVEY MAP

DUCK LAKE  
SEC. 15, 16, 21, 22 T. 40 N. R. 10 E.  
VILAS COUNTY

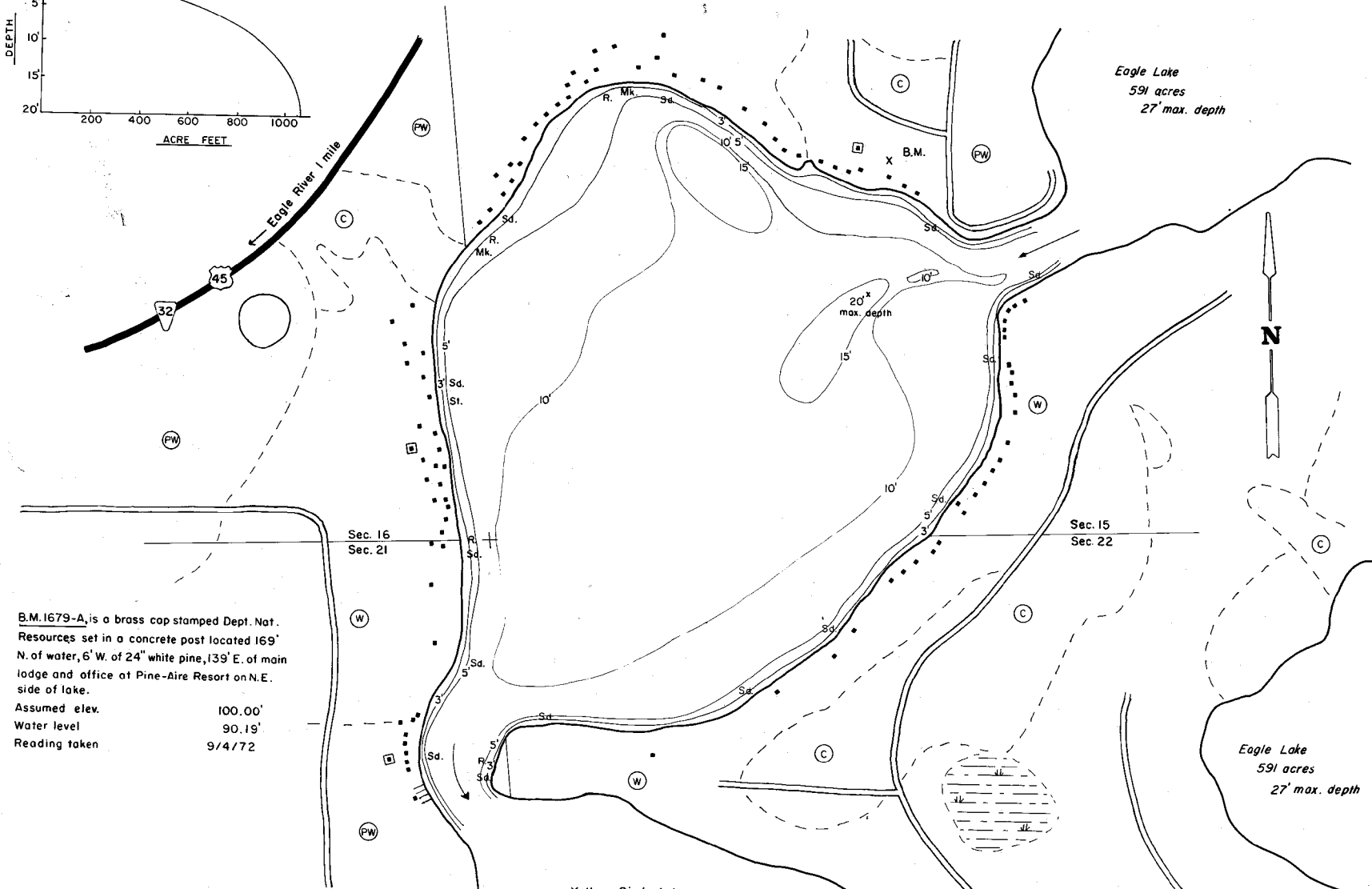
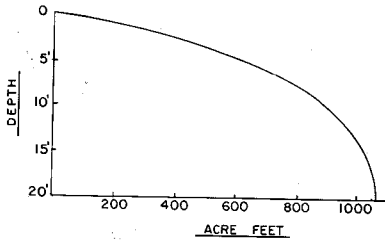

B.M. 1679-A, is a brass cap stamped Dept. Nat. Resources set in a concrete post located 169' N. of water, 6' W. of 24" white pine, 139' E. of main lodge and office at Pine-Aire Resort on N.E. side of lake.  
Assumed elev. 100.00'  
Water level 90.19'  
Reading taken 9/4/72

| EQUIPMENT RECORDING SONAR MAPPED |                            | JUNE 1970           |                             |
|----------------------------------|----------------------------|---------------------|-----------------------------|
| TOPOGRAPHIC SYMBOLS              |                            | LAKE BOTTOM SYMBOLS |                             |
| (B) Brush                        | Steep slope                | P. Peat             | B Boulders                  |
| (PW) Partly wooded               | - - - Indefinite shoreline | Mk. Muck            | ⊙ Stumps & Snags            |
| (W) Wooded                       | Marsh                      | C. Clay             | ⊙ Rock danger to navigation |
| (C) Cleared                      | ⊙ Spring                   | M. Marl             | T Submergent vegetation     |
| (P) Pastured                     | — Intermittent stream      | Sd. Sand            | ⊥ Emergent vegetation       |
| (A) Agricultural                 | — Permanent inlet          | St. Silt            | ⊥ Floating vegetation       |
| B.M. Bench Mark                  | — Permanent outlet         | Gr. Gravel          | ⊥ Brush shelters            |
| ■ Dwelling                       | ⊥ Dam                      | R. Rubble           |                             |
| ■ Resort                         | ⊥ State owned land         |                     |                             |

Yellow Birch Lake  
185 acres  
14' max. depth



◆ Access    ◆ Access with Parking    ◆ Boat Livery  
Drawn by: T. Ginder

| SPECIES OF FISH | ABUNDANCE |        |         |
|-----------------|-----------|--------|---------|
|                 | Abundant  | Common | Present |
| Muskie          |           | X      | X       |
| N. Pike         | X         | X      | X       |
| Walleye         | X         | X      | X       |
| L. M. Bass      | X         | X      | X       |
| S. M. Bass      | X         | X      | X       |
| Panfish         | X         | X      | X       |

WATER AREA 108.29 ACRES

UNDER 3 FT. 4 %  
OVER 20 FT. 0 %

MAX. DEPTH 20 FEET  
TOTAL ALK. 28 P.P.M.

VOLUME 1041.92 ACRE FT.  
SHORELINE 165 MILES