

STATE OF WISCONSIN
DEPARTMENT OF NATURAL RESOURCES

LAKE SURVEY MAP

EAU CLAIRE FLOWAGE MARATHON COUNTY
LAKE

SEC. 12 7 T. 28 N. R. 7-8 E.

Department of Natural Resources B.M. 'X' 119-E
Bronze tablet marked P.S.C. set in right
concrete wingwall of Dam
Sea level Elevation 1168.73
Water Elevation 1165.62 Taken 7/30/68

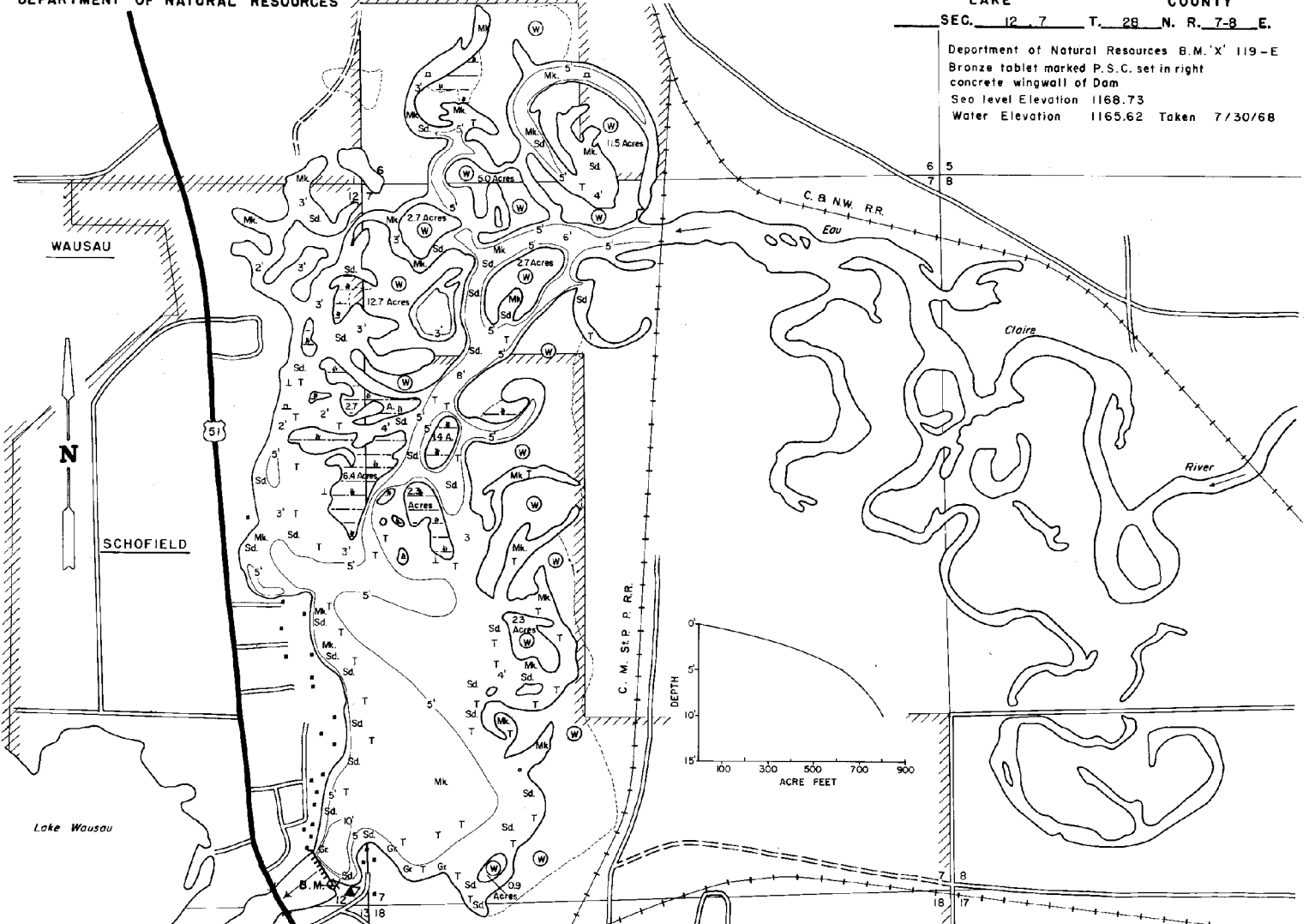

- EQUIPMENT RECORDED SONAR MAPPED JUNE 1968
- TOPOGRAPHIC SYMBOLS
- (B) Brush
 - (W) Partly wooded
 - (W) Wooded
 - (C) Cleared
 - (P) Pastured
 - (A) Agricultural
 - B.M. Bench Mark
 - Dwelling
 - Resort
 - Camp
- RECORDING SYMBOLS
- (|||||) Steep slope
 - (---) Indefinite shoreline
 - (---) Marsh
 - (---) Spring
 - (---) Intermittent stream
 - (---) Permanent inlet
 - (---) Permanent outlet
 - (---) Dam
 - (---) D.N.R. State owned land
- LAKE BOTTOM SYMBOLS
- P. Peat
 - Mk. Muck
 - C. Clay
 - M. Marl
 - Sd. Sand
 - St. Silt
 - Gr. Gravel
 - R. Rubble
 - Bc. Bedrock
- MONTH YEAR
- LAKE BOTTOM SYMBOLS
- B Boulders
 - Slumps & Snags
 - Rock danger to navigation
 - T Submergent vegetation
 - Emergent vegetation
 - Flloating vegetation
 - Brush shelters

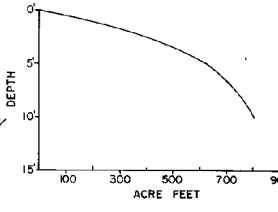

500' 0' 500' 1000' 1500' 2000'

SCALE

Access Access with Parking Boat Livery

Drawn by: C. Holt
Field work by: J. Smith, P. Michelson

SPECIES OF FISH	ABUNDANCE	
	Common	Present
Muskie	X	X
N. Pike	X	X
Walleye	X	X
L. M. Bass	X	X
S. M. Bass	X	X
Panfish	X	X
Trout		

WATER AREA 183.7 ACRES
UNDER 3 FT. _____ %
OVER 20 FT. 0 %
MAX. DEPTH 10 FEET.
TOTAL ALK. 50 P.P.M.
VOLUME 802.4 ACRE FT.
SHORELINE 6.9 MILES
SHORELINE 7.5 MILES WITH ISLANDS

Maps are not for navigation
Source-Wisconsin Department of Natural Resources
Hunt Fish Camp Wisconsin .Com 2005