

STATE OF WISCONSIN
DEPARTMENT OF NATURAL RESOURCES

LAKE SURVEY MAP

ECHO LAKE IRON COUNTY
SEC. 24, 25 T. 43 N. R. 3 E.

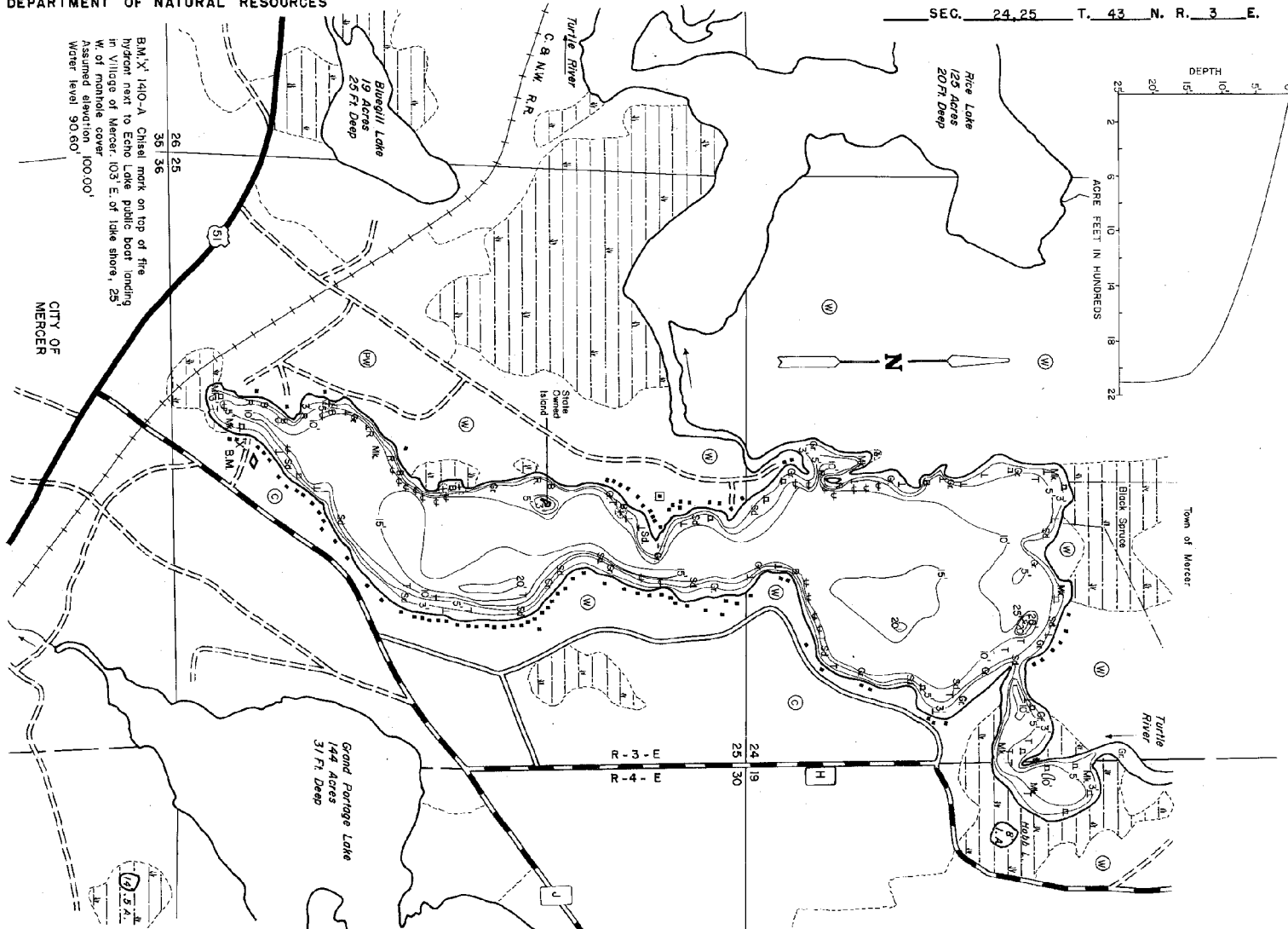

B.M. X 1410-A Chisel mark on top of fire hydrant next to Echo Lake public boat landing in Village of Mercer, 103° E. of lake shore, 25' W. of monolith cover. Assumed elevation 100.00'. Water level 90.60'.

- EQUIPMENT RECORDING SONAR MAPPED JULY 1968
- | TOPOGRAPHIC SYMBOLS | | LAKE BOTTOM SYMBOLS | |
|----------------------|-------------------------|---------------------|-----------------------------|
| (B) Brush | Steep slope | P. Peat | ⊖ Boulders |
| (P) Partially wooded | Indefinite shoreline | Mk. Muck | ⊖ Stumps & Snags |
| (W) Wooded | Marsh | C. Clay | ⊖ Rock danger to navigation |
| (C) Cleared | Spring | M. Marl | ⊖ Submergent vegetation |
| (P) Pastured | Intermittent stream | Sd. Sand | ⊖ Emergent vegetation |
| (A) Agricultural | Permanent inlet | Sl. Silt | ⊖ Floating vegetation |
| B.M. Bench Mark | Permanent outlet | G. Gravel | ⊖ Brush shelters |
| ■ Dwelling | Dam | R. Rubble | |
| ■ Resort | D.N.R. State owned land | Br. Bedrock | |
| ■ Camp | | | |

600' 0' 600' 1200' 1800' 2400'

SCALE

◆ Access ◆ Access with Parking ◆ Boat Livery

Drawn by: C. Holt
Field work by: P. Michelson, J. Smith

SPECIES OF FISH		NUMBER	PERCENT
Muskie		X	
N. Pike		X	
Walleys		X	
L. M. Bass		X	
S. M. Bass		X	
Ponfish		X	
Trout		X	

WATER AREA 219.7 ACRES
 UNDER 3 FT. 12.7 %
 OVER 20 FT. 0.45 %
 MAX. DEPTH 25 FEET.
 TOTAL ALK. 30 P.P.M.
 VOLUME 20152 ACRE FT.
 SHORELINE 4.9 MILES

Maps are not for navigation
 Source-Wisconsin Department of Natural Resources
 Hunt Fish Camp Wisconsin .Com 2005