

STATE OF WISCONSIN  
DEPARTMENT OF NATURAL RESOURCES

LAKE SURVEY MAP

FOREST  
LAKE

VILAS  
COUNTY

SEC. 4, 5, 9, 33 T. 42 N. R. 9 E.

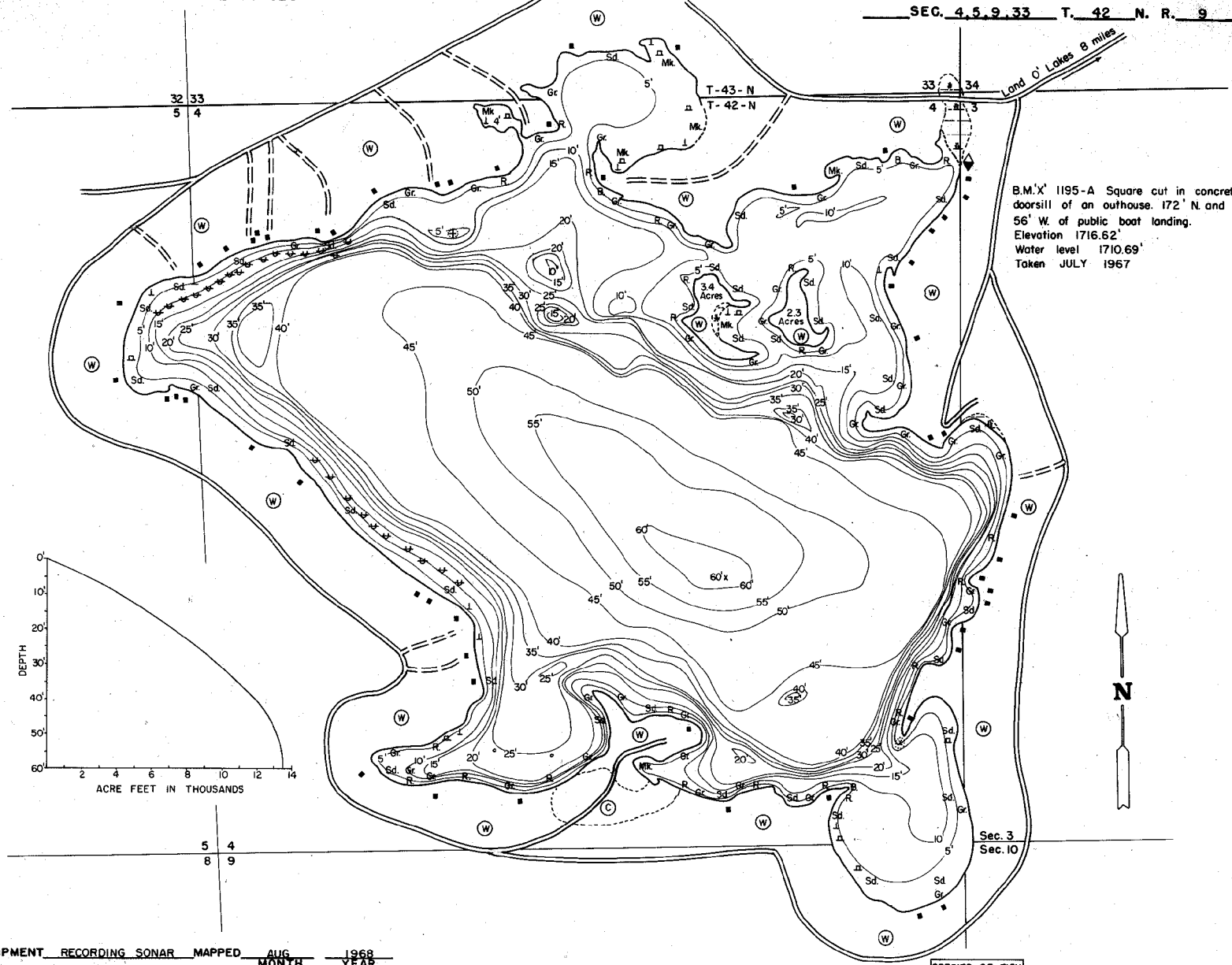

B.M.'X' 1195-A Square cut in concrete  
doorsill of an outhouse. 172' N and  
56' W of public boat landing.  
Elevation 1716.62'  
Water level 1710.69'  
Taken JULY 1967

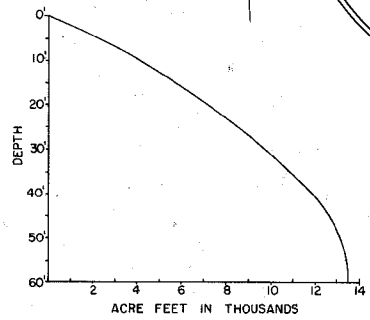

EQUIPMENT RECORDING SONAR MAPPED AUG 1968  
MONTH YEAR

- LAKE BOTTOM SYMBOLS
- |                       |                           |            |                             |
|-----------------------|---------------------------|------------|-----------------------------|
| (B) Brush             | Steep slope               | P. Peat    | B Boulders                  |
| (PW) Partially wooded | ~ Indefinite shoreline    | Mk. Muck   | ⊕ Stumps & Snags            |
| (W) Wooded            | ~ Marsh                   | C. Clay    | ⊗ Rock danger to navigation |
| (C) Cleared           | ~ Spring                  | M. Marl    | T Submergent vegetation     |
| (P) Pastured          | ~ Intermittent stream     | Sd. Sand   | ⊥ Emergent vegetation       |
| (A) Agricultural      | ~ Permanent inlet         | St. Silt   | ⊥ Floating vegetation       |
| B.M. Bench Mark       | ~ Permanent outlet        | Gr. Gravel | ⊕ Brush shelters            |
| ■ Dwelling            | ~ Dam                     | R. Rubble  |                             |
| □ Resort              | ~ D.N.R. State owned land | Bc Bedrock |                             |
| □ Camp                |                           |            |                             |



◆ Access    ◆ Access with Parking    ◆ Boat Livery  
Drawn by: C. Holt  
Field work by: P. Michelson, J. Smith

SPECIES OF FISH	LAKE BOTTOM SYMBOLS		
	Abundant	Common	Present
Muskie			X
N. Pike			X
Walleye			X
L. M. Bass	X		
S. M. Bass	X		
Panfish			X
Trout			X

WATER AREA 465.9 ACRES  
UNDER 3 FT. 7 %  
OVER 20 FT. 59 %  
MAX. DEPTH 60 FEET.  
TOTAL ALK. 30 P.P.M.  
VOLUME 13,498.5 ACRE FT.  
SHORELINE 6.2 MILES  
SHORELINE 7.0 MILES WITH IS.