

STATE OF WISCONSIN  
DEPARTMENT OF NATURAL RESOURCES

LAKE SURVEY MAP

FOUR LAKE  
RUSK COUNTY  
SEC. 26 T.-33-N. R.-9-W.

Lake Three  
3.6 acres  
26 max. depth

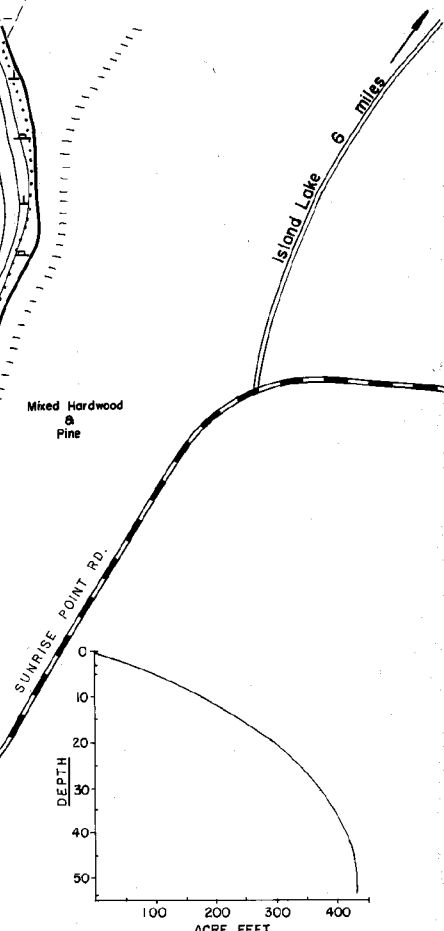
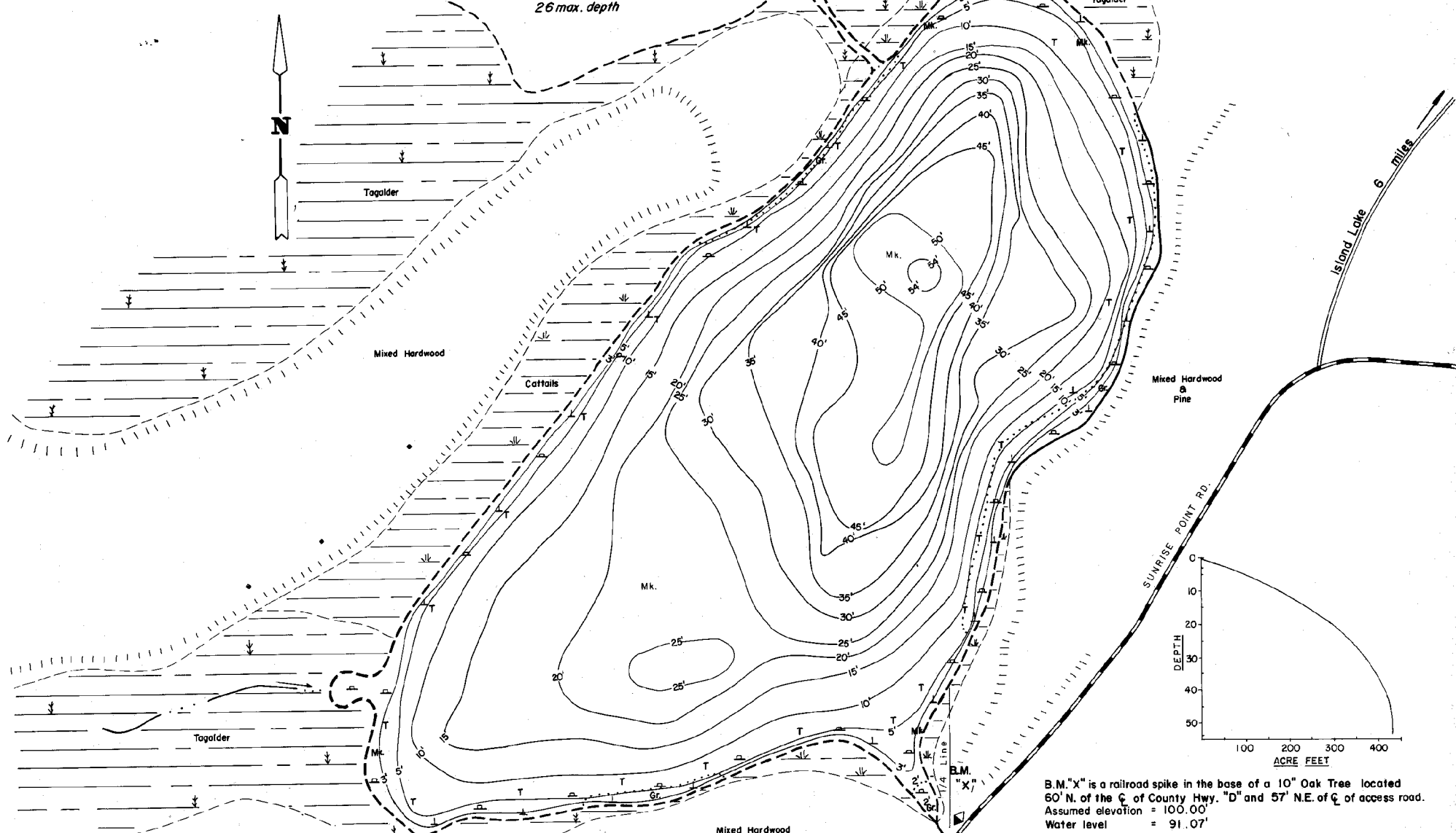

B.M. "X" is a railroad spike in the base of a 10" Oak Tree located 60' N. of the C of County Hwy. "D" and 57' N.E. of C of access road. Assumed elevation = 100.00' Water level = 91.07'

EQUIPMENT RECORDING SONAR MAPPED JUNE 1977

- | TOPOGRAPHIC SYMBOLS   |                            | LAKE BOTTOM SYMBOLS |                             |
|-----------------------|----------------------------|---------------------|-----------------------------|
| (B) Brush             | Steep slope                | P Peat              | B Boulders                  |
| (PW) Partially wooded | - - - Indefinite shoreline | Mk. Muck            | S Stumps & Snags            |
| (W) Wooded            | ~ Marsh                    | C. Clay             | ⚠ Rock danger to navigation |
| (C) Cleared           | ~ Spring                   | M. Marl             | T Submergent vegetation     |
| (P) Pastured          | ~ Intermittent stream      | Sd. Sand            | ⌋ Emergent vegetation       |
| (A) Agricultural      | ~ Permanent inlet          | Sl. Silt            | ⌋ Floating vegetation       |
| B.M. Bench Mark       | ~ Permanent outlet         | Gr. Gravel          | ⌋ Brush shelters            |
| ■ Dwelling            | ~ Dam                      | R. Rubble           |                             |
| ■ Resort              | ~ D.N.R. State owned land  | Bc. Bedrock         |                             |
| ■ Camp                |                            |                     |                             |

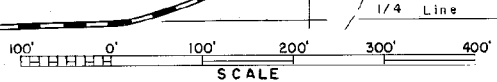

Drawn by: R. Williams  
Field work by: C. Busch, K. Cable, L. Sather

SPECIES OF FISH	Abundance		
	Abundant	Common	Present
Muskie			
N Pike			
Walleye			
L. M. Bass			X
S. M. Bass			
Panfish	X		
Trot			

WATER AREA 20.5 ACRES  
 UNDER 3 FT. 11 %  
 OVER 20 FT. 47 %  
 MAX. DEPTH 54 FEET.  
 TOTAL ALK. 32 P.P.M.  
 VOLUME 432.1 ACRE FT.  
 MAIN SHORELINE .75 MI.  
 ISLAND SHORELINE 0 MI.