

GOOSE LAKE WILDLIFE AREA

DANE COUNTY

See map legend for the activities allowed on the property or contact the DNR Service Center for more property information.
PLEASE RESPECT LANDOWNERS' RIGHTS AND OBSERVE ALL PROPERTY POSTINGS.

For more information:
PROPERTY MANAGER
C/O SOUTH CENTRAL REGION HEADQUARTERS
3911 FISH HATCHERY RD
FITCHBURG, WI 53711-5397
608-275-3230

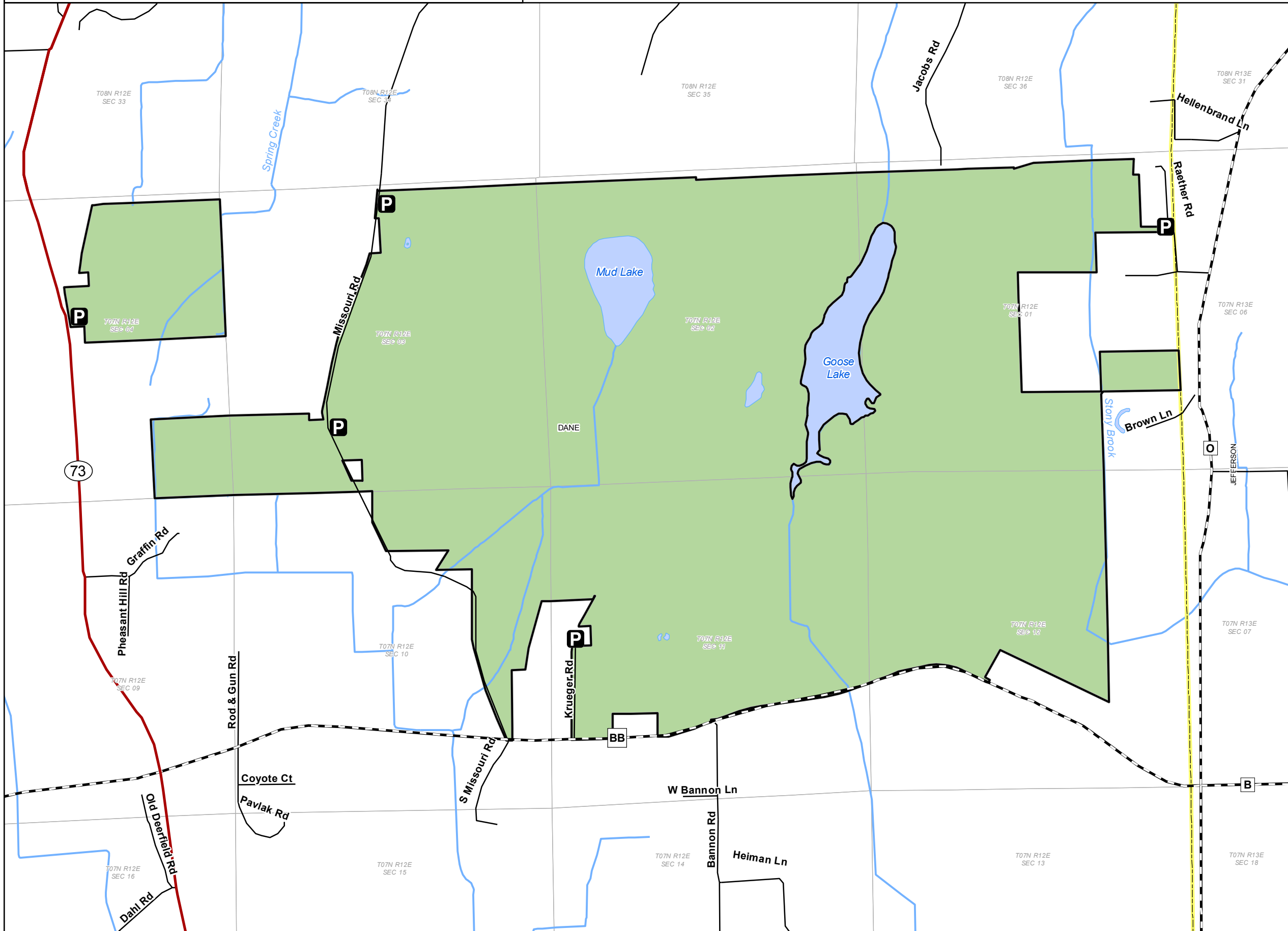

DNR Managed Land

Open DNR Wildlife Land

Other Open DNR Land

Leased Hunting Ground

Seasonally Closed Area

Easement Use

Hunting and Fishing

Fishing Only

Hunting Only

Open, No Hunting or Fishing

State Trail

Boat Access

Parking Area

Section Boundary

0 1,000 2,000 Feet

5280 feet = 1 mile



The data shown on this map have been obtained from various sources, and are of varying age, reliability and resolution. This map is not intended to be used for navigation, nor is this map an authoritative source of information about legal land ownership or public access. Users of this map should confirm the ownership of land through other means in order to avoid trespassing. No warranty, expressed or implied, is made regarding accuracy, applicability for a particular use, completeness, or legality of the information depicted on this map.

Wisconsin Department of Natural Resources



Featured property funded in part by
Knowles-Nelson Stewardship Fund

WM-7540 acr

Last revision date: Sep 21, 2010

http://dnr.wi.gov/org/land/facilities/dnr_land_mapping.html