

STATE OF WISCONSIN
DEPARTMENT OF NATURAL RESOURCES

LAKE SURVEY MAP

HAMMILL LAKE BAYFIELD COUNTY
SEC. 25.30 T. 44 N. R. 8 W.

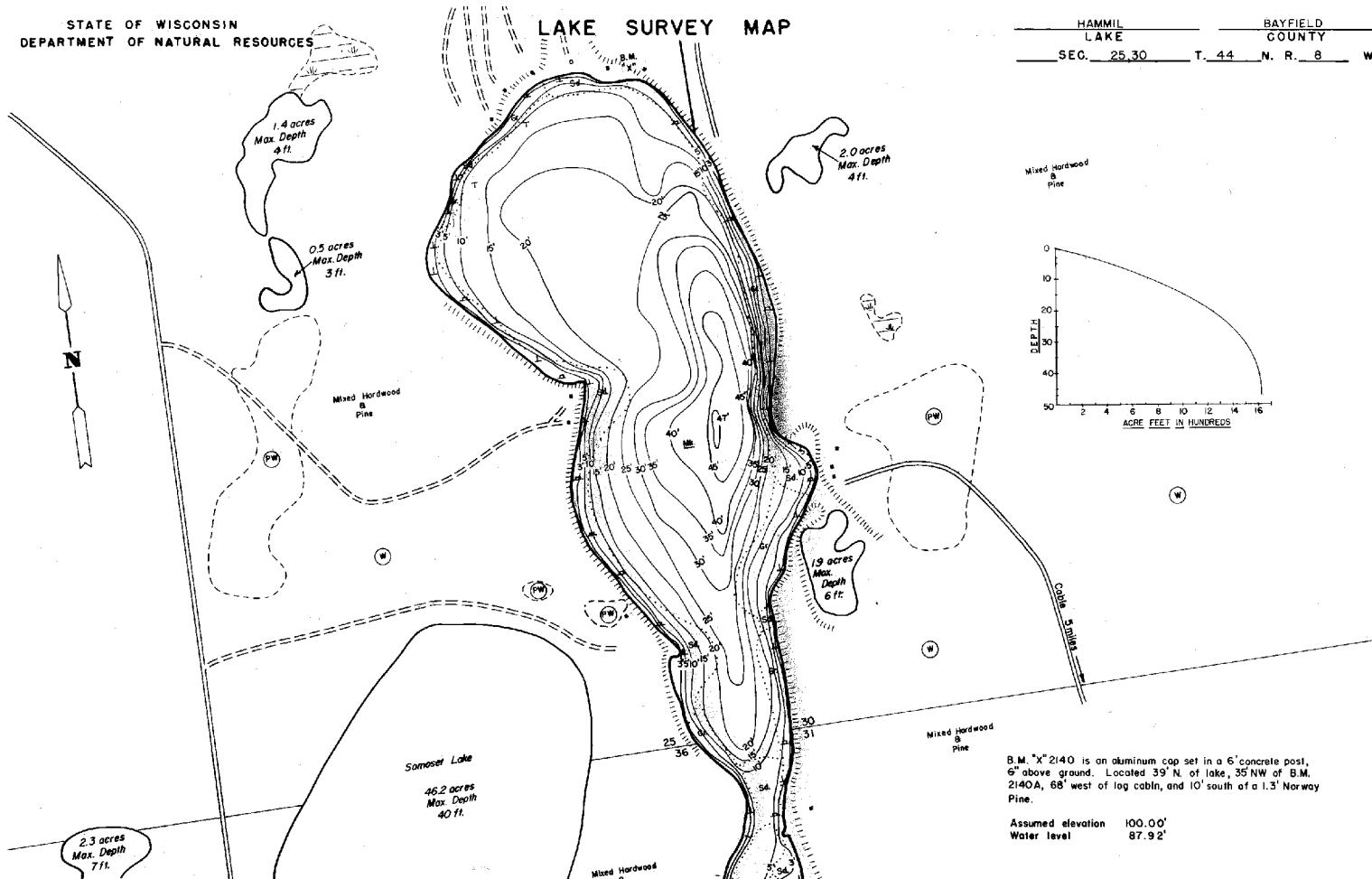

B.M. "X" 2140 is an aluminum cap set in a 6" concrete post, 6" above ground. Located 39' N. of lake, 35' NW of B.M. 2140A, 68' west of log cabin, and 10' south of a 1.5' Norway Pine.
Assumed elevation 100.00'
Water level 87.92'

- EQUIPMENT RECORDING SONAR MAPPED AUGUST 1978
- | TOPOGRAPHIC SYMBOLS | | LAKE BOTTOM SYMBOLS | |
|---------------------|----------------------------|---------------------|-----------------------------|
| (B) Brush | Steep slope | P. Peat | B. Boulders |
| (PW) Partly wooded | - - - Indefinite shoreline | Mk. Muck | * Stumps & Snags |
| (W) Wooded | Marsh | C. Clay | ⚠ Rock danger to navigation |
| (C) Cleared | Spring | M. Marl | T. Submergent vegetation |
| (P) Pastured | Intermittent stream | Sd. Sand | J. Emergent vegetation |
| (A) Agricultural | Permanent inlet | St. Silt | △ Floating vegetation |
| B.M. Bench Mark | Permanent outlet | Gr. Gravel | ↘ Brush shelters |
| (D) Dwelling | Dom. | R. Rubble | |
| (R) Resort | D.N.R. State owned land | Bc. Bedrock | |

SPECIES OF FISH	ADULT		JUVENILE
	ABUNDANT	PRESENT	
Muskie			
N. Pike			
Walleye	X		
L. M. Bass			
S. W. Bass	X		
Pontfish	X		
Trout			

WATER AREA 82.5 ACRES
UNDER 3 FT. 7 %
OVER 20 FT. 48 %
MAX. DEPTH 47 FEET
TOTAL ALK. 16 P.P.M.
VOLUME 1631.5 ACRE FT.
MAIN SHORELINE 2 MI.

Maps are not for navigation
Source-Wisconsin Department of Natural Resources
Hunt Fish Camp Wisconsin .Com 2005