

WISCONSIN CONSERVATION DEPARTMENT

LAKE SURVEY MAP

LAKE HAYTON POND
 SECTIONS 16,17,21
 TOWNSHIP T-18-N
 RANGE R-20-E
 TOWN CHARLESTOWN
 COUNTY CALUMET

B.M. "X" Top of North dam
 abutment by center steel
 stake.
 Assumed Elev. 100.00
 Water Elev. 97.70

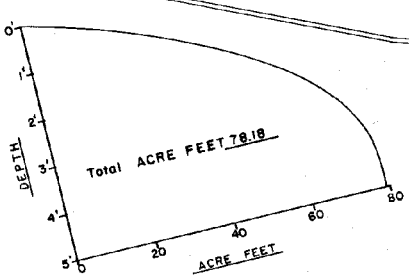
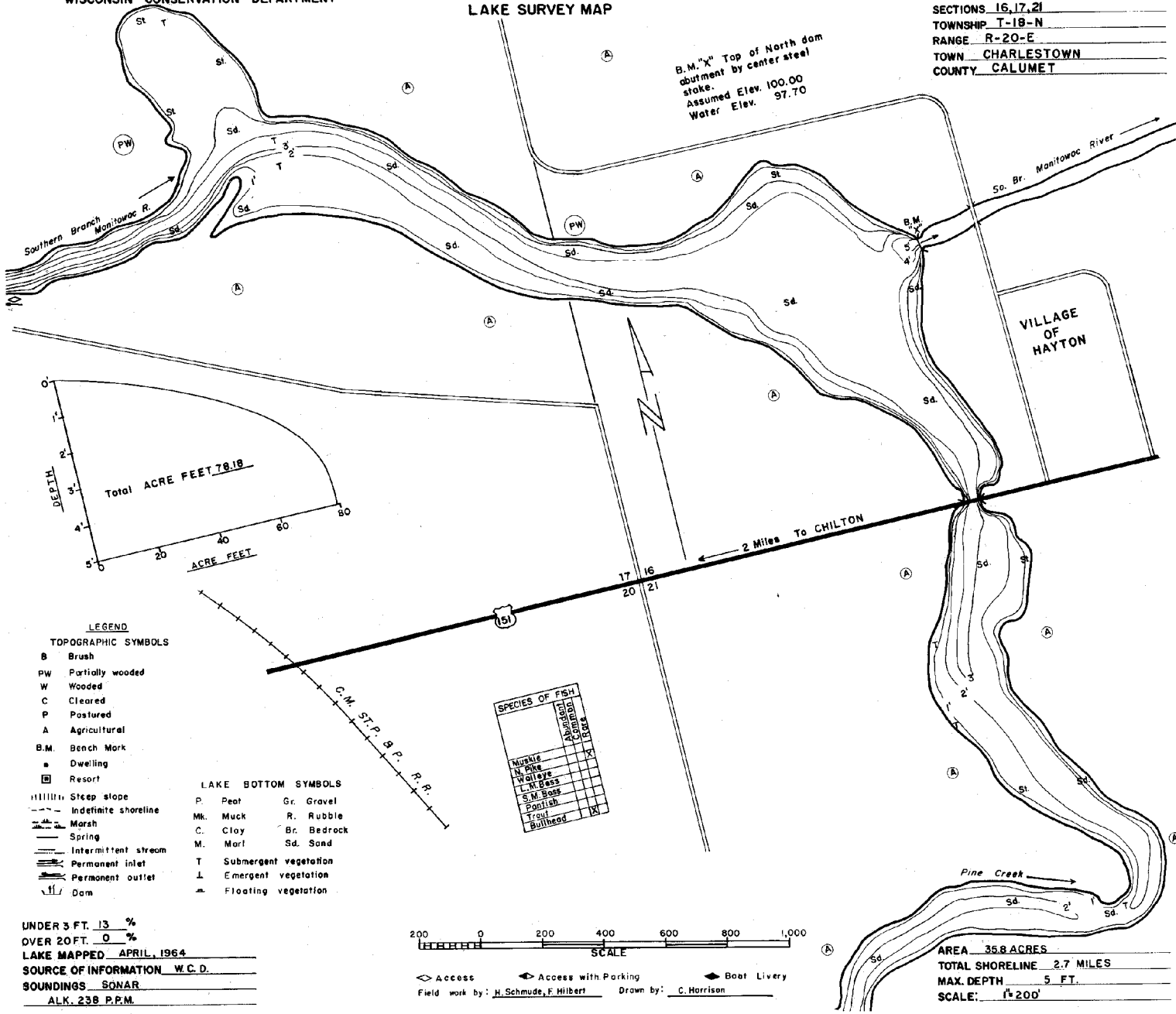

- LEGEND**
- TOPOGRAPHIC SYMBOLS**
- B Brush
 - PW Partially wooded
 - W Wooded
 - C Cleared
 - P Pastured
 - A Agricultural
 - B.M. Bench Mark
 - Dwelling
 - Resort
 - ||||| Steep slope
 - - - Indefinite shoreline
 - Marsh
 - Spring
 - Intermittent stream
 - Permanent inlet
 - Permanent outlet
 - Dam
- LAKE BOTTOM SYMBOLS**
- P. Peat
 - Mk. Muck
 - C. Clay
 - M. Marl
 - T Submergent vegetation
 - L Emergent vegetation
 - F Floating vegetation
 - Gr. Gravel
 - R. Rubble
 - Br. Bedrock
 - Sd. Sand

SPECIES OF FISH

	Abundant	Common	Rare
Muskie			X
N. Pike			X
Walleye			X
L. H. Bass			X
S. M. Bass			X
Pomfish			X
Trotl			X
Bullhead			X

UNDER 3 FT. 13 %
 OVER 20 FT. 0 %
 LAKE MAPPED APRIL, 1964
 SOURCE OF INFORMATION W.C.D.
 SOUNDINGS SONAR
 ALK. 238 P.P.M.

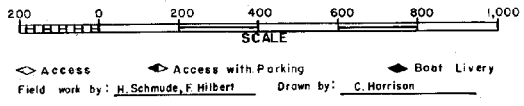

AREA 35.8 ACRES
 TOTAL SHORELINE 2.7 MILES
 MAX. DEPTH 5 FT.
 SCALE: 1" = 200'

Maps are not for navigation
 Source-Wisconsin Department of Natural Resources
 Hunt Fish Camp Wisconsin .Com 2005