

STATE OF WISCONSIN
DEPARTMENT OF NATURAL RESOURCES

LAKE SURVEY MAP

HOLCOMBE FLOWAGE LAKE
SEC. T. 32.33 N. R. 6.7 W.
SHEET 3 of 4

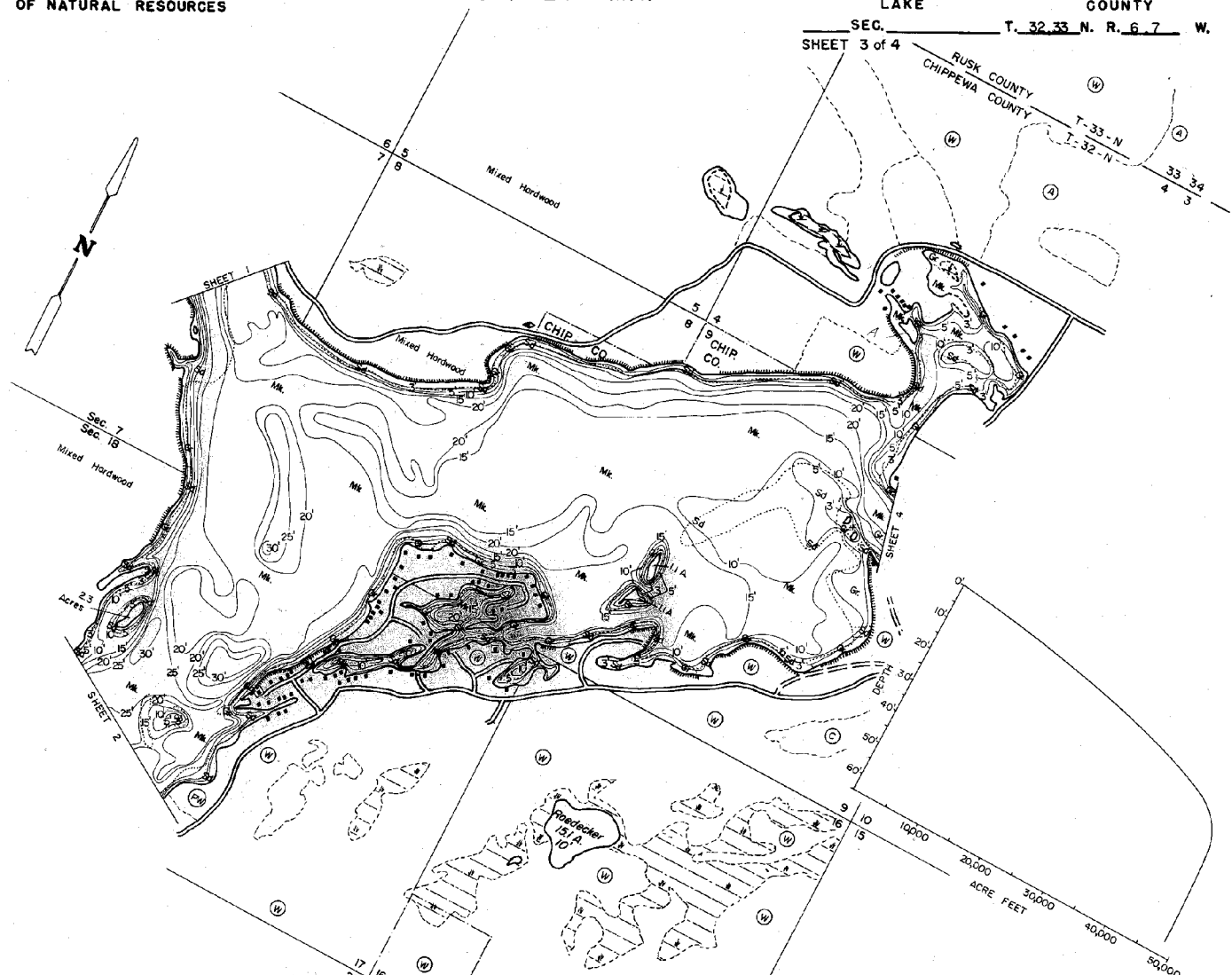

- EQUIPMENT RECORDING SONAR MAPPED AUG 1969
- | TOPOGRAPHIC SYMBOLS | | LAKE BOTTOM SYMBOLS | |
|-----------------------|---------------------------|---------------------|-----------------------------|
| (S) Brush | Steep slope | P. Peat | B Boulders |
| (PW) Partially wooded | — Indefinite shoreline | Mk. Muck | ⌘ Stumps & Snags |
| (W) Wooded | — Marsh | C. Clay | ⊗ Rock danger to navigation |
| (C) Cleared | — Spring | M. Marl | T Submergent vegetation |
| (P) Pastured | — Intermittent stream | Sd. Sand | J Emergent vegetation |
| (A) Agricultural | — Permanent inlet | St. Silt | — Floating vegetation |
| B.M. Bench Mark | — Permanent outlet | Gc. Gravel | → Brush shelters |
| ■ Dwelling | — Dam | R. Rubble | |
| ▣ Resort | — D.N.R. State owned land | Bc. Bedrock | |
| □ Camp | | | |

SCALE
1000' 0' 1000' 2000' 3000' 4000'
Access Access with Parking Boat Livery
Drawn by: C. Holt
Field work by: C. Busch, C. Butler, L. Sather

SPECIES OF FISH	PRESENT	
	Abundant	Common
Muskie	X	X
N Pike	X	X
Walleye	X	X
L. M. Bass	X	X
S. M. Bass	X	X
Pontfish	X	X
Charral Cat	X	X
Sturgeon	X	X

WATER AREA 3890.0 ACRES
UNDER 3 FT. 16.2 %
OVER 20 FT. 21.6 %
MAX. DEPTH 61 FEET.
TOTAL ALK. 33 P.P.M.
VOLUME 48,395.0 ACRE FT.
SHORELINE 57.54 MILES
SHORELINE 60.75 MILES WITH IS.

Maps are not for navigation
Source-Wisconsin Department of Natural Resources
Hunt Fish Camp Wisconsin .Com 2005