

STATE OF WISCONSIN
DEPARTMENT OF NATURAL RESOURCES

LAKE SURVEY MAP

HORSEHEAD LAKE
VILAS COUNTY
SEC. 2, 3, 11 T. 43 N. R. 6 E. #4

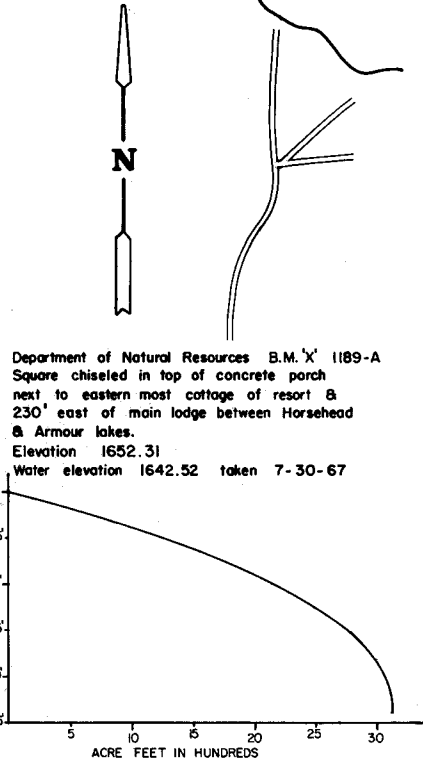
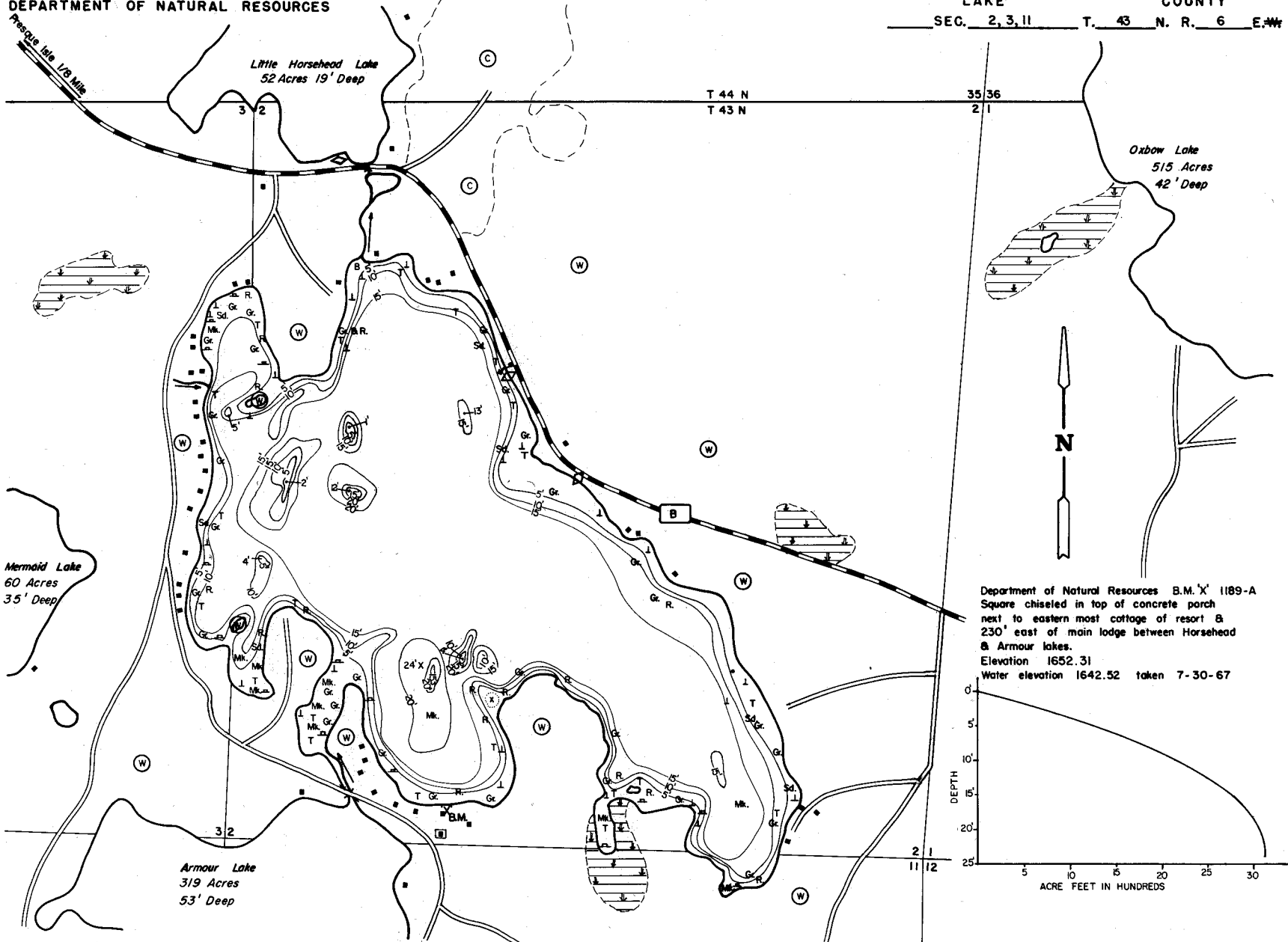

EQUIPMENT RECORDING SONAR MAPPED SEPT. 1967

- TOPOGRAPHIC SYMBOLS
- (B) Brush
 - (PW) Partially wooded
 - (W) Wooded
 - (C) Cleared
 - (P) Pastured
 - (A) Agricultural
 - B.M. Bench Mark
 - Dwelling
- MONTH LAKE BOTTOM SYMBOLS
- ||||| Steep slope
 - - - Indefinite shoreline
 - ~ Marsh
 - ~ Spring
 - ~ Intermittent stream
 - ~ Permanent inlet
 - ~ Permanent outlet
 - ~ Dam
 - P. Peat
 - Mk. Muck
 - C. Clay
 - M. Marl
 - Sd. Sand
 - St. Silt
 - Gr. Gravel
 - R. Rubble

- LAKE BOTTOM SYMBOLS
- B Boulders
 - ⊙ Stumps & Snags
 - ⊙ Rock danger to navigation
 - T Submergent vegetation
 - ⊥ Emergent vegetation
 - ~ Floating vegetation
 - ~ Brush shelters
- ◆ Access ◆ Access with Parking ◆ Boat Livery
- 500' 0' 500' 1000' 1500' 2000'
- SCALE
- Drawn by: R.A. Burkrant

SPECIES OF FISH	Abundance		
	Abundant	Common	Present
Muskie			X
N. Pike			X
Walleye	X		
L.M. Boss			X
S.M. Boss			X
Panfish			X
Trout			X

WATER AREA 234.3 ACRES
UNDER 3 FT. 10 %
OVER 20 FT. 4 %
MAX. DEPTH 24 FEET.
TOTAL ALK. 31 P.P.M.
VOLUME 3115.1 ACRE FT.
SHORELINE 4.07 MILES