

WISCONSIN CONSERVATION DEPARTMENT

LAKE SURVEY MAP

HORSE LAKE POLK COUNTY
 SEC. 22 23 26 27 T. -33- N. R. -18- W.

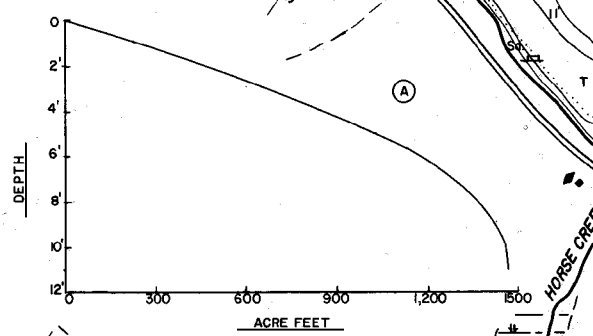
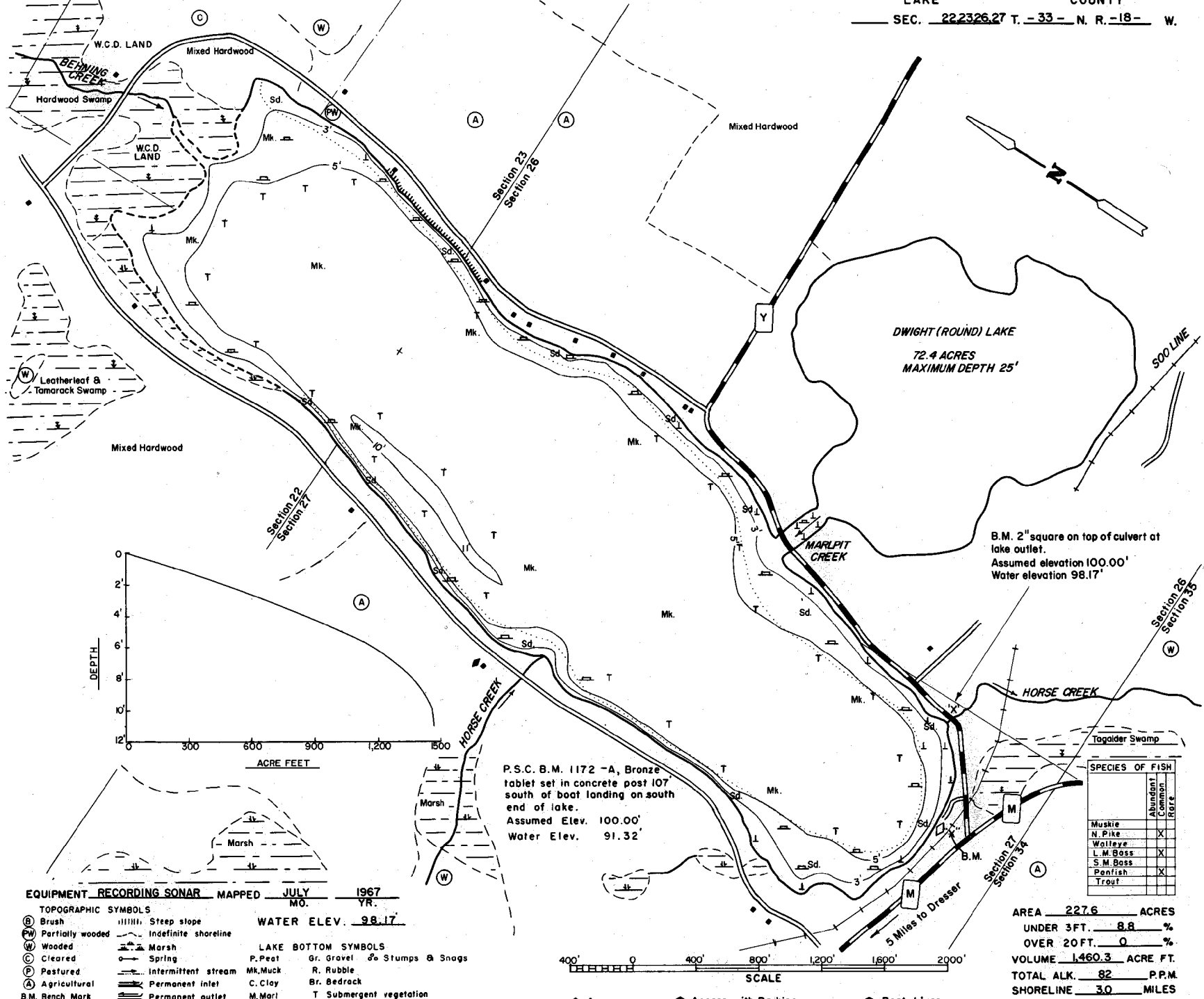

P.S.C. B.M. 1172 -A, Bronze tablet set in concrete post 107' south of boat landing on south end of lake. Assumed Elev. 100.00' Water Elev. 91.32'

B.M. 2" square on top of culvert at lake outlet. Assumed elevation 100.00' Water elevation 98.17'

SPECIES OF FISH	
Species	Abundance Category
Muskie	
N. Pike	X
Walleye	
L. M. Bass	X
S. M. Bass	
Panfish	X
Trout	

EQUIPMENT RECORDING SONAR MAPPED JULY 1967
 MO. YR.

- TOPOGRAPHIC SYMBOLS
- (B) Brush
 - (PW) Partially wooded
 - (W) Wooded
 - (C) Cleared
 - (P) Pastured
 - (A) Agricultural
 - B.M. Bench Mark
 - Dwelling
- LAKE BOTTOM SYMBOLS
- P. Peat
 - Mk. Muck
 - C. Clay
 - M. Marl
 - Sd. Sand
 - Gr. Gravel
 - R. Rubble
 - Br. Bedrock
 - T Submergent vegetation
 - I Emergent vegetation
 - Stumps & Snags

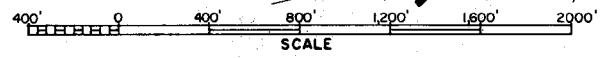

AREA 227.6 ACRES
 UNDER 3FT. 8.8
 OVER 20FT. 0 %
 VOLUME 1,460.3 ACRE FT.
 TOTAL ALK. 82 P.P.M.
 SHORELINE 3.0 MILES
 MAX. DEPTH 11 FEET

◇ Access ◇ Access with Parking ◇ Boat Livery