

STATE OF WISCONSIN
DEPARTMENT OF NATURAL RESOURCES

LAKE SURVEY MAP

HORSESHOE LAKE BARRON COUNTY
SEC. 3, 4, 10 T. 36 - N. R. 14 - W.

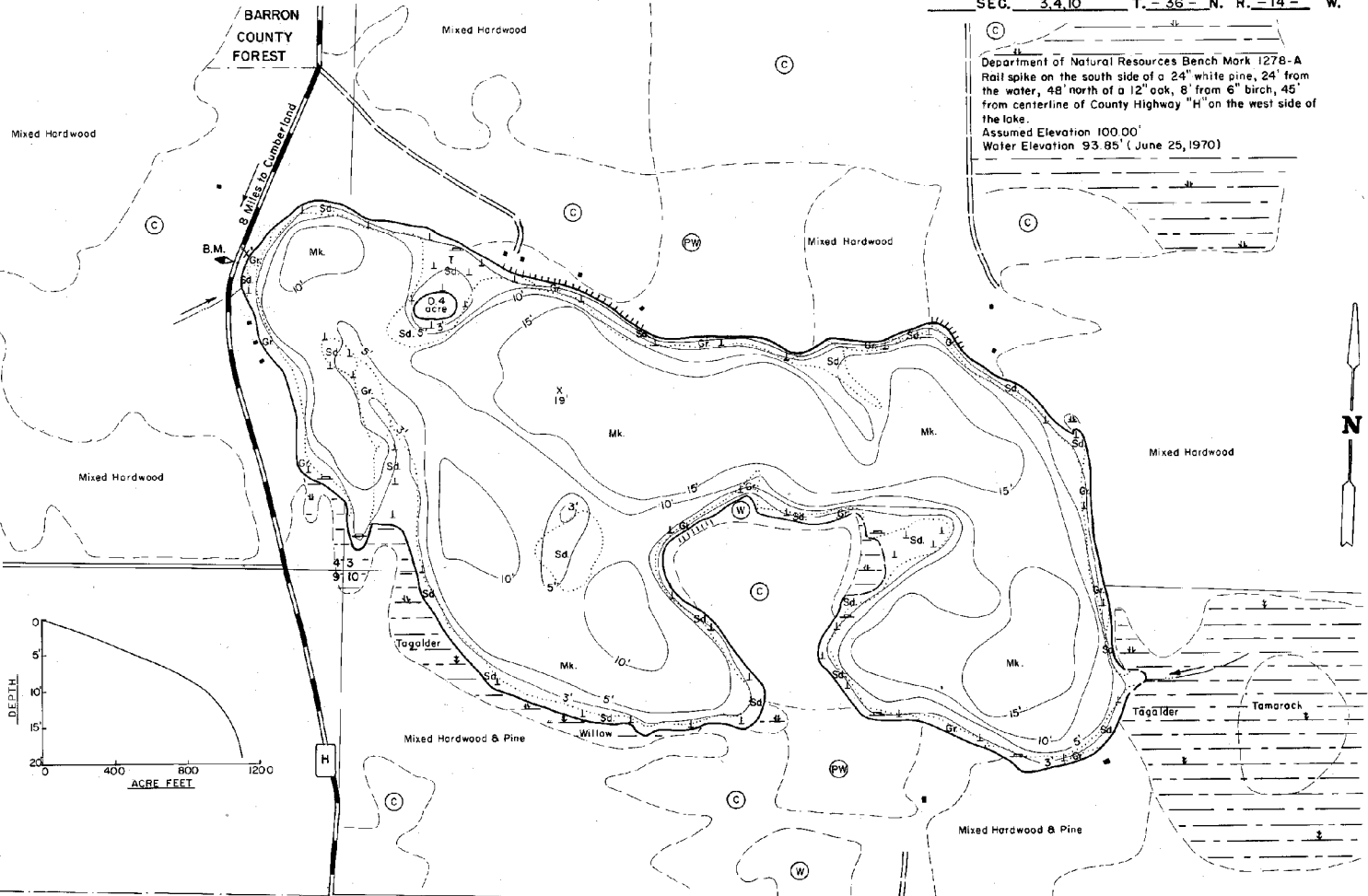

Department of Natural Resources Bench Mark 1278-A
Rail spike on the south side of a 24" white pine, 24' from the water, 48' north of a 12" oak, 8' from 6" birch, 45' from centerline of County Highway "H" on the west side of the lake.
Assumed Elevation 100.00'
Water Elevation 93.85' (June 25, 1970)

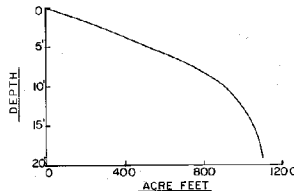

BARRON COUNTY FOREST

EQUIPMENT RECORDING SONAR MAPPED

- TOPOGRAPHIC SYMBOLS
- (B) Brush
 - (PW) Partially wooded
 - (W) Wooded
 - (C) Cleared
 - (P) Pastured
 - (A) Agricultural
 - B.M. Bench Mark
 - Dwelling
 - Resort
 - Camp

- LAKE BOTTOM SYMBOLS
- P. Peat
 - Mk. Muck
 - C. Clay
 - M. Marl
 - Sd. Sand
 - St. Silt
 - Gr. Gravel
 - R. Rubble
 - Bc. Bedrock
 - B. Boulders
 - Stumps & Snags
 - Rock danger to navigation
 - T Submergent vegetation
 - Emergent vegetation
 - Floating vegetation
 - Brush shelters

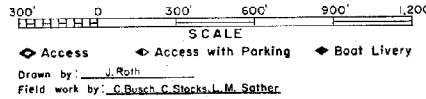

SPECIES OF FISH	JUNE 1970	
	Abundant	Common
Muskie	X	
N. Pike	X	
Walleye	X	
L. M. Bass	X	
S. M. Bass	X	
Panfish	X	
Trout		

WATER AREA 115.0 ACRES
UNDER 3 FT. 14 %
OVER 20 FT. 0 %
MAX. DEPTH 19 FEET.
TOTAL ALK. 13 P.P.M.
VOLUME 1,096.0 ACRE FT.
SHORELINE 2.48 MILES
2.39 MILES OF SHORELINE EXCLUDING ISLAND

Maps are not for navigation
Source-Wisconsin Department of Natural Resources
Hunt Fish Camp Wisconsin .Com 2005