

WISCONSIN CONSERVATION DEPARTMENT

LAKE SURVEY MAP

ISLAND LAKE RUSK COUNTY
 SEC. 20, 21, 28, 29 T. 33 N. R. 8 f.w.

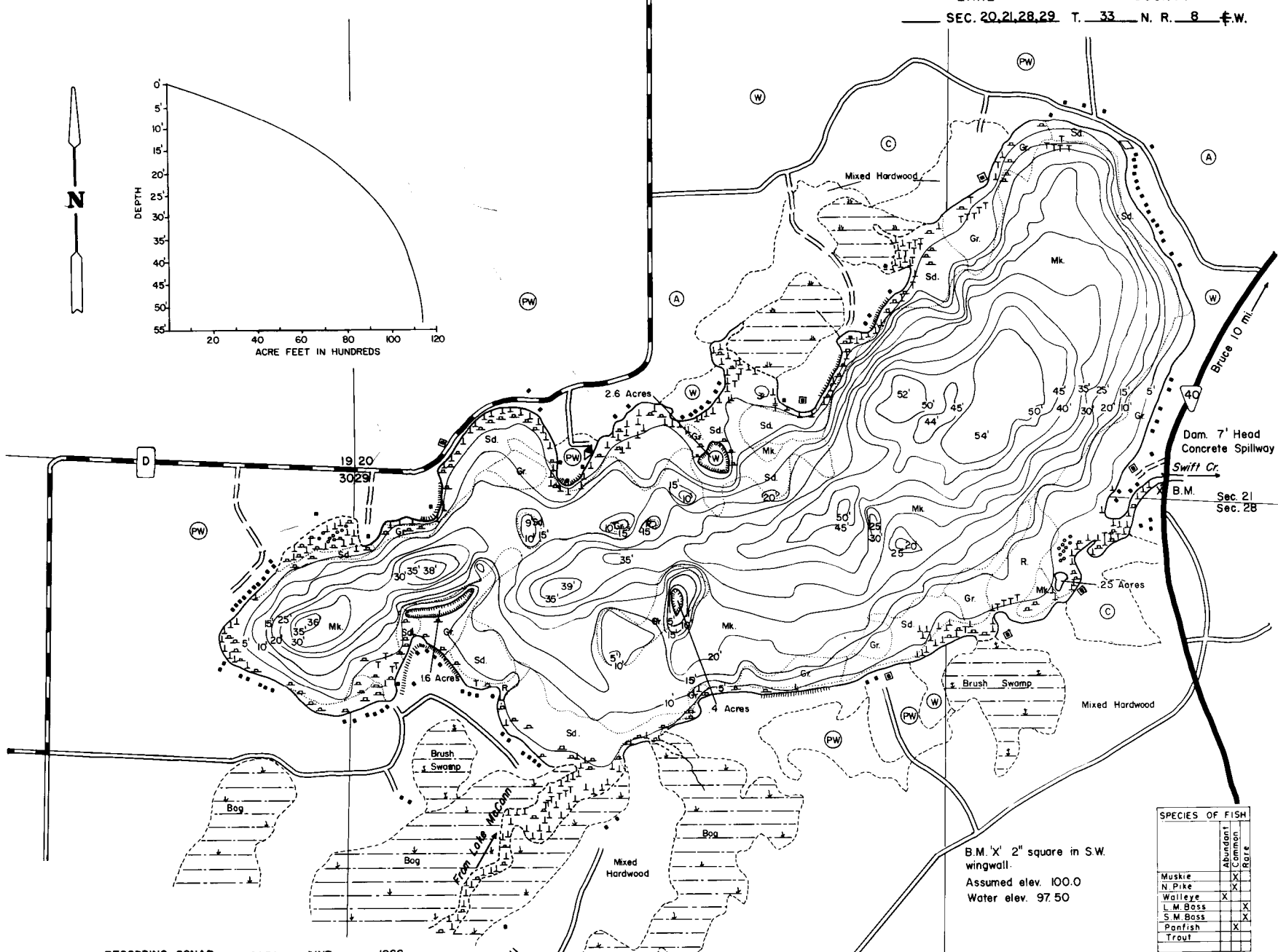
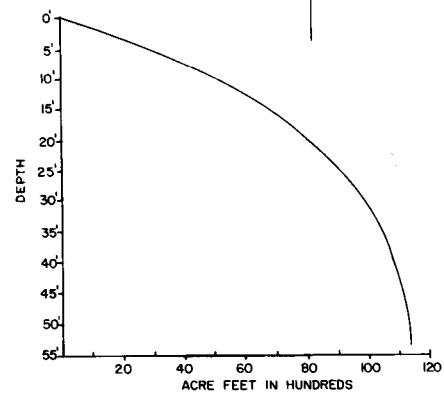
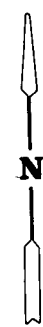

EQUIPMENT RECORDING SONAR MAPPED JUNE 1966
 MO. YR.

- TOPOGRAPHIC SYMBOLS
- (B) Brush
 - (PW) Partially wooded
 - (W) Wooded
 - (C) Cleared
 - (A) Pastured
 - (D) Agricultural
 - B.M. Bench Mark
 - ||||| Steep slope
 - - - Indefinite shoreline
 - Marsh
 - Spring
 - Intermittent stream
 - Permanent inlet
 - Permanent outlet

- LAKE BOTTOM SYMBOLS
- P. Peat
 - Mk. Muck
 - C. Clay
 - M. Marl
 - Gr. Gravel
 - R. Rubble
 - Br. Bedrock
 - T. Submergent vegetation
 - Stumps & Snags

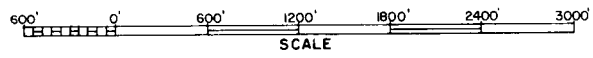

B.M. 'X' 2" square in S.W. wingwall.
 Assumed elev. 100.0
 Water elev. 97.50

SPECIES OF FISH		Abundance	Common	Rate
Muskie		X		
N Pike		X		
Walleye		X		
L.M. Bass			X	
S.M. Bass			X	
Panfish		X		
Trout				

525.7 WITH ISLANDS
 AREA 529.9 ACRES
 UNDER 3 FT. 15.6 %
 OVER 20 FT. 44.8 %
 VOLUME 11,294.0 ACRE FT.
 TOTAL ALK. 65 P.P.M.
 SHORELINE 5.8 MILES
 MAX DEPTH 54 FEET

- ◇ Access
- ◊ Access with Parking
- ◆ Boat Livery