

STATE OF WISCONSIN
DEPARTMENT OF NATURAL RESOURCES

LAKE SURVEY MAP

JERMS LAKE
VILAS COUNTY
SEC. 28,33 T. 40 N. R. 5 E.

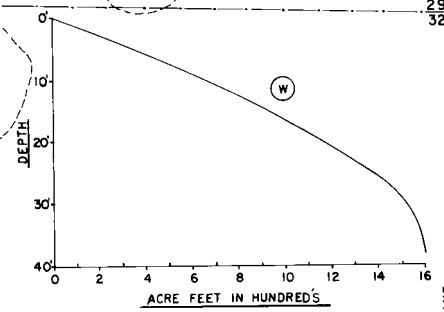
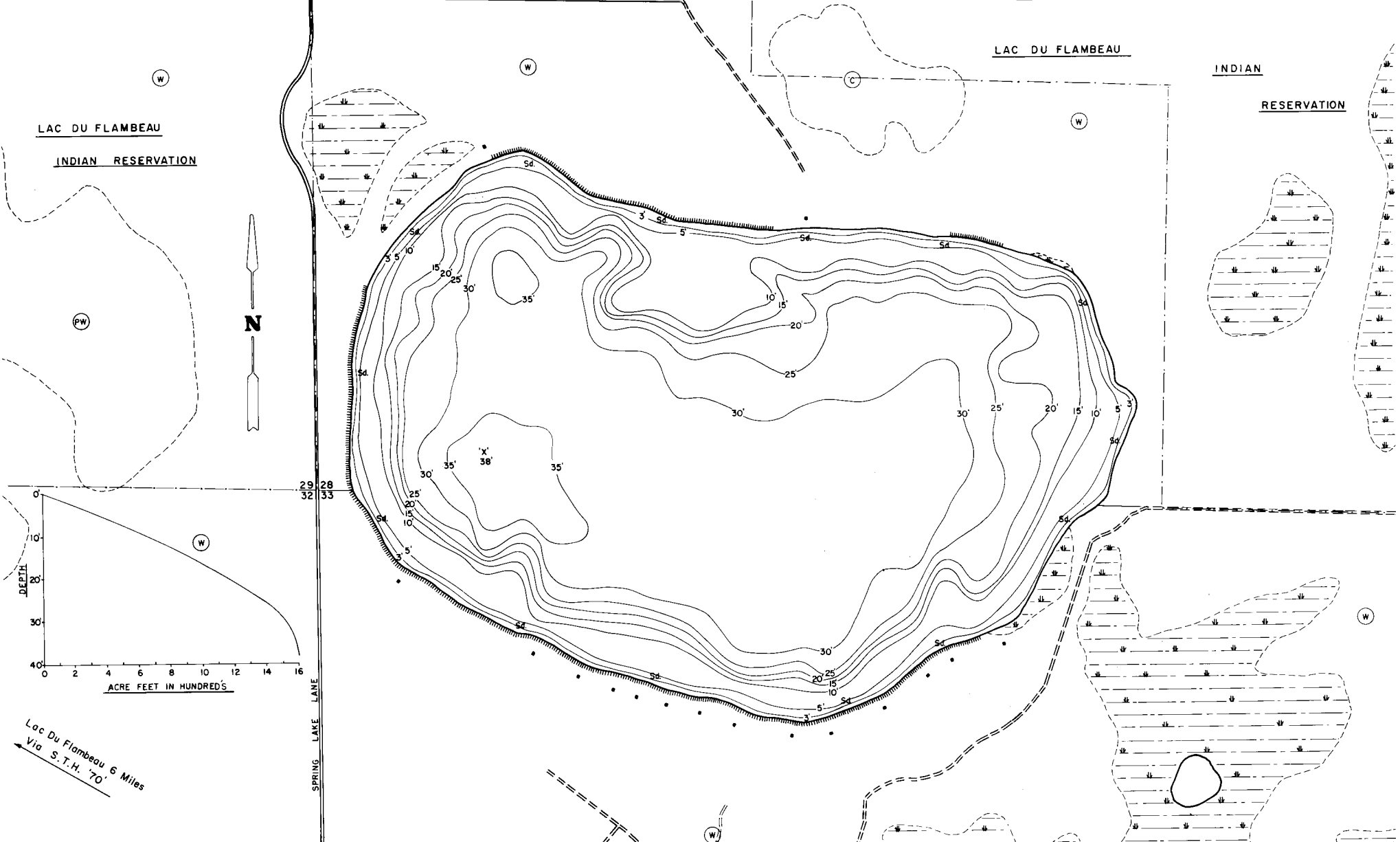

Lac Du Flambeau 6 Miles
Via S.T.H. '70'

EQUIPMENT RECORDING SONAR MAPPED OCT 1974
MONTH LAKE BOTTOM YEAR

- | TOPOGRAPHIC SYMBOLS | | LAKE BOTTOM SYMBOLS | |
|-----------------------|----------------------|---------------------|---------------------------|
| (B) Brush | Steep slope | P. Peat | B Boulders |
| (PW) Partially wooded | Indefinite shoreline | Mk. Muck | Stumps & Snags |
| (W) Wooded | Marsh | C. Clay | Rock danger to navigation |
| (C) Cleared | Spring | M. Marl | T Submergent vegetation |
| (P) Pastured | Intermittent stream | Sd. Sand | Emergent vegetation |
| (A) Agricultural | Permanent inlet | Sl. Silt | Floating vegetation |
| B.M. Bench Mark | Permanent outlet | Gr. Gravel | Brush shelters |
| ■ Dwelling | Dam | R. Rubble | |

200' 0' 200' 400' 800' 1200'
SCALE
◆ Access ◆ Access with Parking ◆ Boat Livery

| SPECIES OF FISH | Abundant | | Present |
|-----------------|----------|---------|---------|
| | Common | Present | |
| Muskie | | | |
| N. Pike | | | |
| Walleye | | X | |
| L. M. Bass | | X | |
| S. M. Bass | | X | |
| Panfish | | X | |

WATER AREA 71.7 ACRES
 UNDER 3 FT. 3.49 %
 OVER 20 FT. 63.09 %
 MAX. DEPTH 38 FEET.
 TOTAL ALK. 5 P.P.M.
 VOLUME 1603,995 ACRE FT.
 MAIN SHORELINE 1.29 MI.