

STATE OF WISCONSIN
DEPARTMENT OF NATURAL RESOURCES

LAKE SURVEY MAP

WAUSAU
LAKE

MARATHON
COUNTY

SEC. AS SHOWN T. 28, 29 N. R. 7 E.
SHEET 2 OF 6

SHEET NO. 3

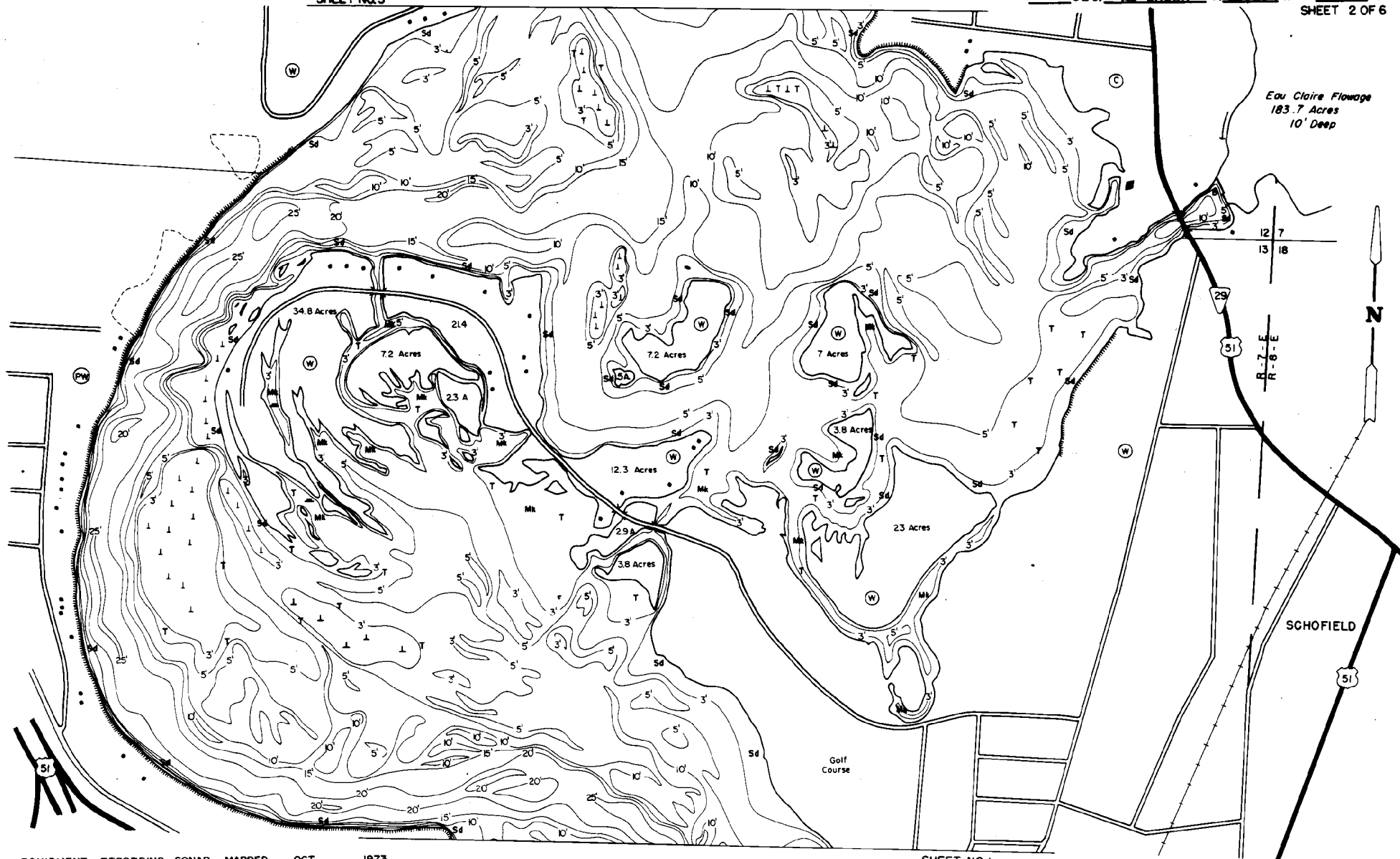

SHEET NO. 1

EQUIPMENT RECORDING SONAR MAPPED OCT 1973
MONTH YEAR

- | TOPOGRAPHIC SYMBOLS | | LAKE BOTTOM SYMBOLS | |
|-----------------------|----------------------------|---------------------|-----------------------------|
| (B) Brush | Steep slope | P. Peat | B Boulders |
| (PW) Partially wooded | - - - Indefinite shoreline | Mk. Muck | ⊛ Stumps & Snags |
| (W) Wooded | Marsh | C. Clay | ⚡ Rock danger to navigation |
| (C) Cleared | Spring | M. Marl | T Submergent vegetation |
| (P) Pastured | Intermittent stream | Sd. Sand | ⚡ Emerging vegetation |
| (A) Agricultural | Permanent inlet | Sl. Silt | ⚡ Floating vegetation |
| B.M. Bench Mark | Permanent outlet | Gr. Gravel | ⚡ Brush shelters |
| (D) Dwelling | Dam | R. Rubble | |
| (R) Resort | D.N.R. State owned land | Br. Bedrock | |
| (C) Camp | | | |



Access Access with Parking Boat Livery

Drawn by: C. Holt
Field work by: A. Barlow, J. Smith

SPECIES OF FISH	Abundance	
	Common	Present
Muskie		
N. Pike	X	X
Walleye	X	X
L. M. Bass	X	X
S. M. Bass	X	X
Panfish	X	X
Trout		

WATER AREA 1918.0 ACRES
UNDER 3 FT. 23 %
OVER 20 FT. 8 %
MAX. DEPTH 30 FEET.
TOTAL ALK. 34 P.P.M.
VOLUME 13,916 ACRE FT.
MAIN SHORELINE 30.58 MI.
ISLAND SHORELINE 43.32 MI.